

CRANKCASE CYLINDER PISTON

Ref No.	Part Number	Description	Qty	Remarks
1	6E0-W0090-04-EK	CRANK-CYLINDER.ASSEMBLY.	1	
2	6E0-15100-01-94	CRANKCASE ASSEMBLY	1	
3	650-11370-00-00	CHECK VALVE ASSY	3	
4	624-14485-00-00	.PIPE, JOINT	1	
5	6E5-11372-00-00	.NIPPLE, HOSE	1	
6	90445-07M28-00	.HOSE (L70)	2	
7	90467-06016-00	CLIP	8	
8	93606-12019-00	DOWEL PIN	2	
9	90105-06M16-00	.BOLT, FLANGE	4	
10	90105-06M17-00	BOLT, FLANGE	2	
11	6E0-24378-00-00	PIPE, JOINT 3	1	
12	90445-07M32-00	HOSE (L120)	1	
13	90445-07M00-00	HOSE (L100)	1	
14	95895-06025-00	.BOLT, FLANGE	1	
15	90105-06M16-00	.BOLT, FLANGE	1	
16	90105-06M14-00	BOLT FLANGE	1	
17	677-12411-00-00	THERMOSTAT	1	
18	6E0-41111-01-9M	EXHAUST INNER CVR.	1	
19	6E0-41112-A1-00	GASKET EXHAUST	1	
20	6E0-41113-01-9M	EXHAUST OUTER CVR.	1	

CONTINUED ON NEXT FRAME >

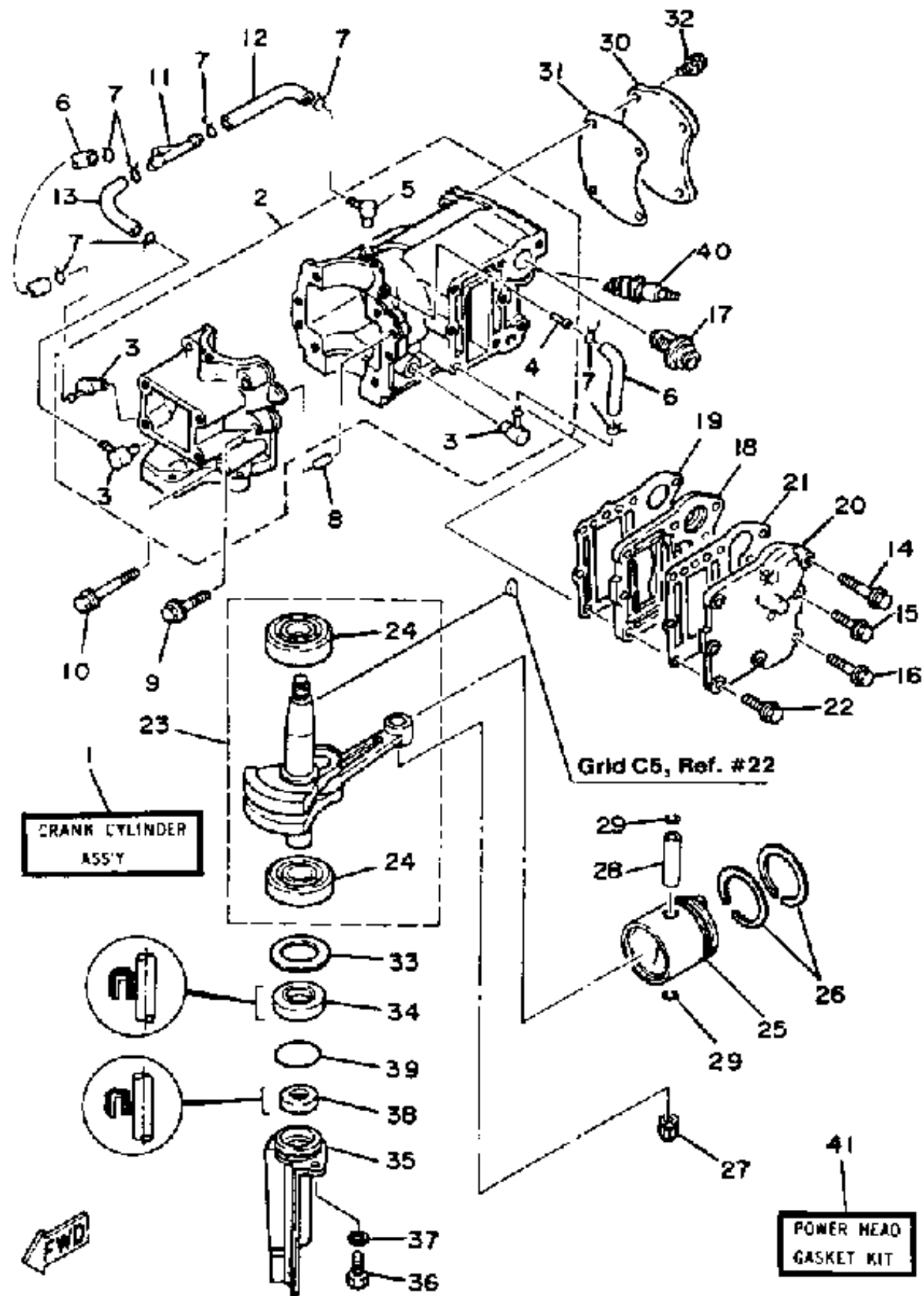

CRANKCASE CYLINDER PISTON

Ref No.	Part Number	Description	Qty	Remarks
21	6E0-41114-01-00	GASKET, EXH.COVER	1	
22	95895-06025-00	.BOLT, FLANGE	6	
23	6E0-11400-00-00	CRANKSHAFT ASSEMBLY	1	
24	93306-204U0-00	.BEARING	2	
25	6E0-11631-00-98	PISTON STD	1	
26	6G1-11610-00-00	PISTON RINGSET STD	1	
27	93310-112V0-00	BEARING	1	
28	527-11633-00-00	PIN, PISTON	1	
29	93450-13022-00	CIRCLIP	2	
30	6E0-11191-01-9M	COVER, CYLINDER.HEAD 1	1	
31	6E0-11193-A1-00	GASKET, HD.COVER 1	1	
32	90105-06M14-00	BOLT FLANGE	4	
33	676-45567-00-09	SHIM, GEAR ADJUSTING. 0.9	1	
34	93101-20M29-00	OIL SEAL	1	
35	6E0-15396-03-5B	HOUSING, OIL SEAL	1	
36	97395-06016-00	BOLT	1	
37	92990-06600-00	WASHER, PLATE	1	
38	93101-10M25-00	OIL SEAL	1	
39	93210-31114-00	O-RING	1	
40	NGK-B7HS0-00-00	NGK SPARK PLUG B7HS	1	

CONTINUED ON NEXT FRAME >

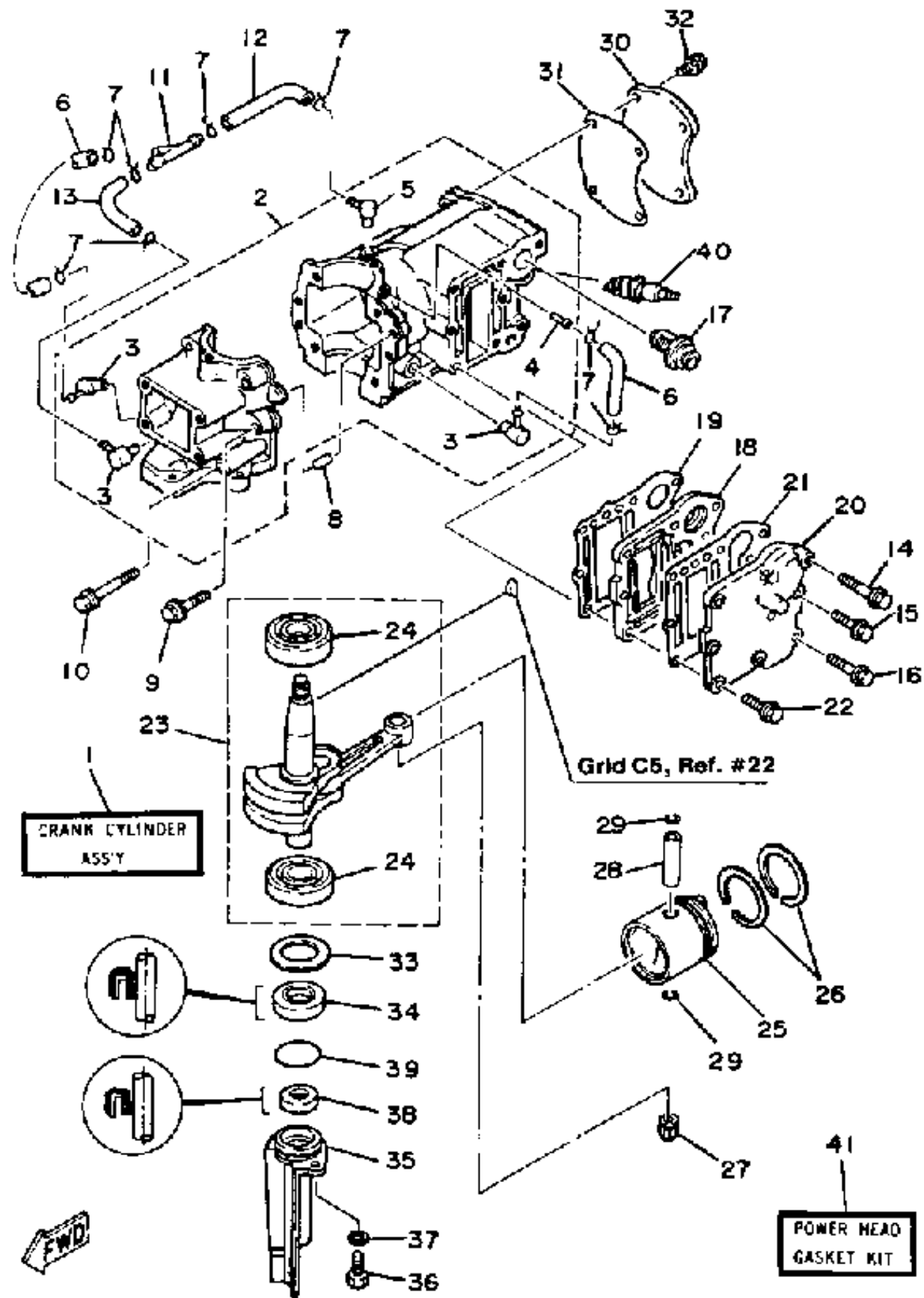

5sn_In_sk_lk

CRANKCASE CYLINDER PISTON

Ref No.	Part Number	Description	Qty	Remarks
41	6E0-W0001-01-00	POWER HEAD GASKET KIT	1	SEE NOTE

A4