

# CARBURETOR

Ref No.	Part Number	Description	Qty	Remarks
1	6L2-14301-01-00	CARBURETOR ASSY 1	1	UPPER
2	6L2-14302-01-00	CARBURETOR ASSY 2	1	LOWER
3	6L2-14381-00-00	. BODY, FLOAT CHAMBER 1	1	UR UPPER
3	6L2-14383-00-00	SCREW, DRAIN	1	UR LOWER
4	6L2-14384-00-00	. GASKET, FLOAT CHAMBER	2	
5	6L2-14385-00-00	. . FLOAT	2	
6	6E5-14386-01-00	. . PIN, FLOAT	2	
7	6L2-14392-00-00	. VALVE	2	
8	98580-04010-00	. .SCREW, PAN HEAD	4	
9	6L2-14157-00-00	. COVER, MIXING	2	
10	6L2-14399-00-00	. GASKET	2	
11	6L2-14341-00-00	. NOZZLE, MAIN	2	
12	30X-14343-63-00	. JET, MAIN (125)	2	
13	6L2-14342-30-00	. JET, PILOT (60)	2	
14	50M-14355-00-00	. .PLUG	2	
15	6L2-14323-00-00	. SCREW, AIR ADJUSTING	2	
16	646-14212-01-00	. SPRING, PILOT ADJUSTING	4	
17	98503-04014-00	SCREW, PAN HEAD	2	
18	98580-04012-00	SCREW, PAN HEAD	8	
19	92901-04100-00	WASHER, SPRING	8	

CONTINUED ON NEXT FRAME >

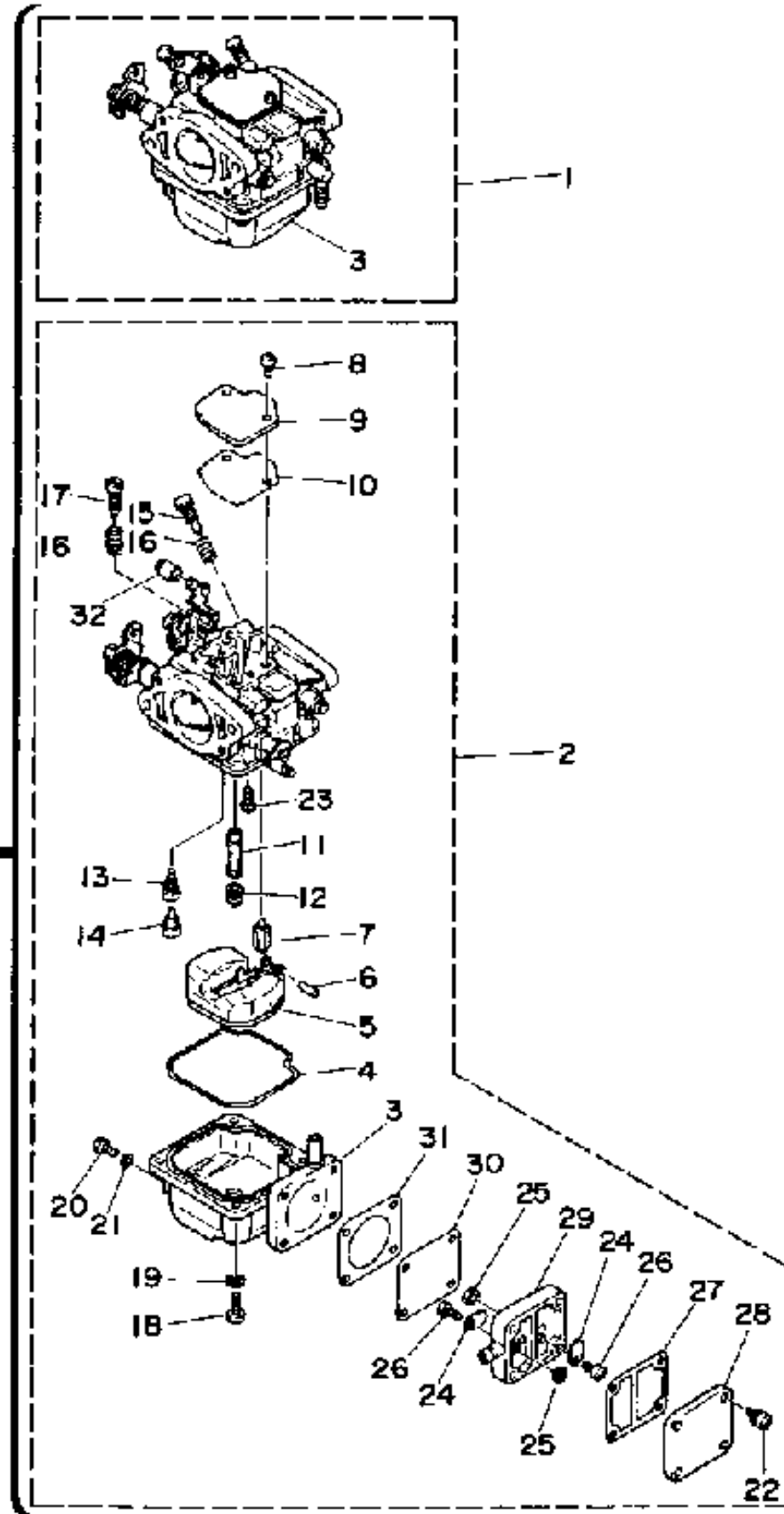
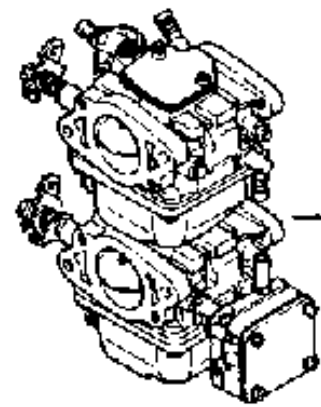

# CARBURETOR

Ref No.	Part Number	Description	Qty	Remarks
20	677-14383-01-00	SCREW, DRAIN	2	
21	6L2-14398-00-00	GASKET	2	
22	677-24444-01-00	.SCREW	4	
23	98901-04006-00	.SCREW, BIND	2	
24	6A0-24421-01-00	.VALVE, CHECK	2	
25	98813-03100-00	NUT	2	
26	6E7-14325-00-00	.SCREW, PAN HEAD	2	
27	6L2-24435-00-00	.GASKET, BODY 2	1	
28	6L2-24413-00-00	.BODY 2	1	
29	682-24412-00-00	BODY 1	1	
30	677-24411-02-00	.DIAPHRAGM	1	
31	677-24434-01-00	GASKET, BODY	1	
32	6L2-14578-00-00	.COLLAR	1	