

# ELECTRIC MOTOR

Ref No.	Part Number	Description	Qty	Remarks
1	6J4-81800-01-00	STARTING MOTOR ASSEMBLY	1	
2	689-81857-11-00	..PINION STOPPER SET	1	
3	689-81807-12-00	..GEAR ASSY, STARTING MOTOR	1	
4	6F5-81830-11-00	..FRONT BRACKET ASSY	1	
5	689-81847-11-00	..O-RING	2	
6	689-81809-11-00	..WASHER KIT	1	
7	689-81850-12-00	..ARMATURE ASSY	1	
8	689-81810-11-00	..STATOR ASSY	1	
9	689-81811-11-00	...BRUSH 1	1	
10	689-81840-11-00	..BRUSH HOLDER ASSY	1	
11	689-81812-11-00	...BRUSH 2	1	
12	689-81813-10-00	...SPRING, BRUSH	2	
13	689-81820-11-00	..REAR BRACKET ASSY	1	
14	689-81826-10-00	..BOLT	2	
15	97313-08030-00	BOLT	2	
16	92990-08600-00	..WASHER, PLATE	2	
17	97313-08016-00	BOLT, HEXAGON	1	
18	92990-08600-00	..WASHER, PLATE	1	
19	6H4-82117-00-00	WIRE, LEAD	1	
20	6H4-81337-01-00	COVER, FLYWHEEL	1	

CONTINUED ON NEXT FRAME >

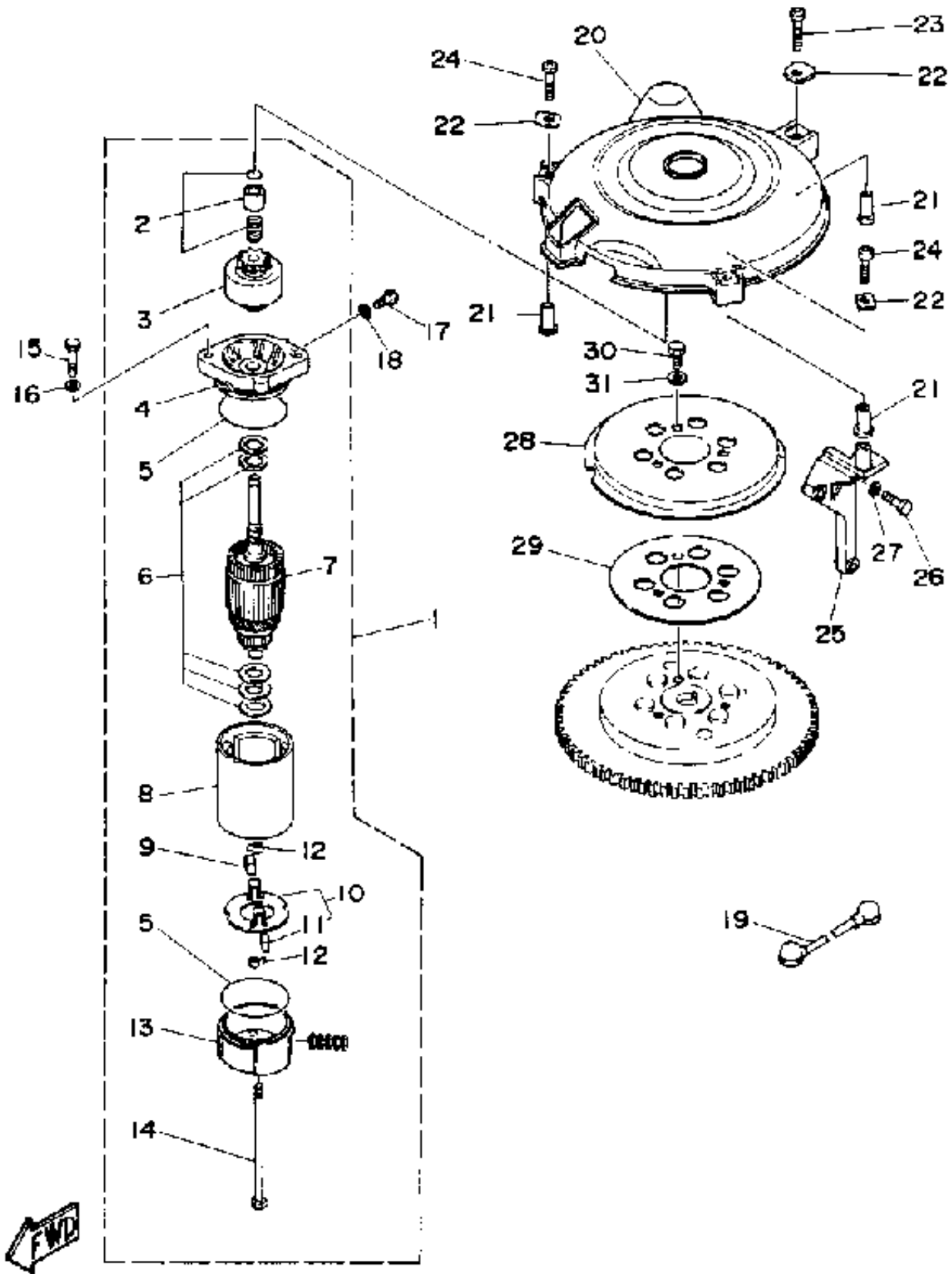

## ELECTRIC MOTOR

Ref No.	Part Number	Description	Qty	Remarks
21	90387-06M65-00	COLLAR	3	
22	90209-06M04-00	WASHER	3	
23	98580-06040-00	. SCREW, PAN HEAD	1	
24	98580-06035-00	SCREW, PAN HEAD	2	
25	6H4-15772-02-94	STAY 2	1	
26	97313-06025-00	BOLT	3	
27	92990-06600-00	. WASHER, PLATE	3	
28	6J8-15723-E1-00	PULLEY, STARTER	1	
29	6J8-81365-00-00	GASKET, HOLE COVER	1	
30	97011-08016-00	BOLT	3	
31	92990-08600-00	..WASHER, PLATE	3	