

f9_9mlhr_mshr

CARBURETOR

Ref No.	Part Number	Description	Qty	Remarks
1	6G9-14301-05-00	CARBURETOR ASSEMBLY 1	1	UR
1	6G9-14301-03-00	CARBURETOR ASSEMBLY 1	1	UR
2	6G8-14384-01-00	. GASKET, FLOAT CHAMBER	1	
3	6G8-14381-01-00	. BODY, FLOAT CHAMBER	1	UR
3	6G8-14381-02-00	. BODY, FLOAT CHAMBER	1	UR
4	647-14386-10-00	. PIN, FLOAT	1	
5	6G8-14342-24-00	. JET, PILOT (#48)	1	UR
5	6G8-14342-22-00	. JET, PILOT (# 44)	1	UR
6	654-14198-00-00	. GASKET	1	
7	6G8-14345-00-00	. PLUG, MAIN NOZZLE	1	
8	648-14343-43-00	. JET, MAIN (#86)	1	UR
8	648-14343-42-00	. JET, MAIN (# 84)	1	UR
9	6G8-14341-10-00	. NOZZLE, MAIN	1	UR
9	6G8-14341-20-00	. NOZZLE, MAIN	1	UR
10	6G8-14216-00-00	. SCREW	1	
11	647-14334-00-00	. SPRING	1	
12	6G8-14997-00-00	. SEAL	1	
13	6G8-14323-00-00	. SCREW, AIR ADJUSTING	1	
14	6G8-14392-00-00	. VALVE, NEEDLE	1	
15	6G8-14385-00-00	. FLOAT	1	

CONTINUED ON NEXT FRAME >

CARBURETOR

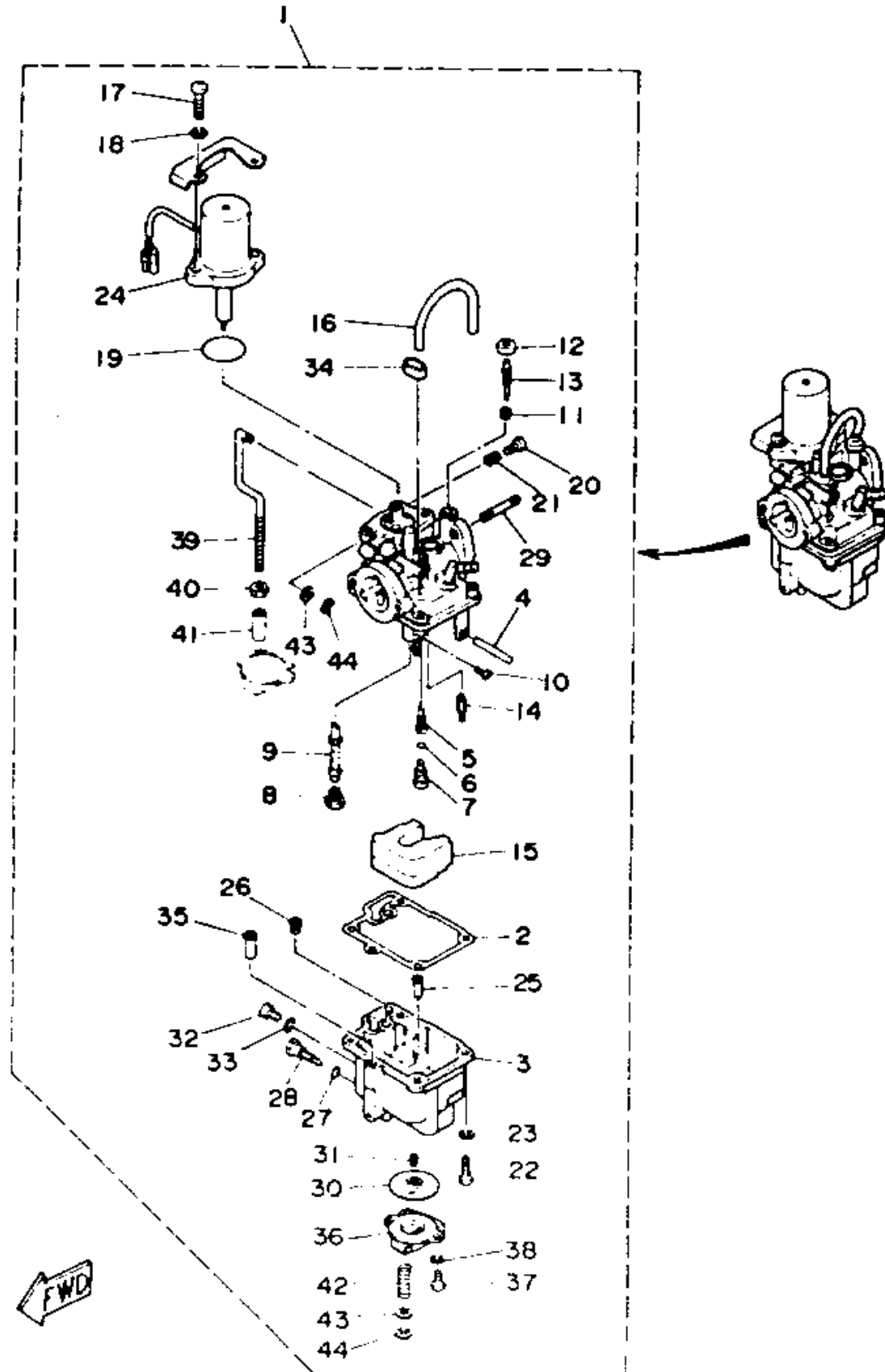

Ref No.	Part Number	Description	Qty	Remarks
16	6G8-14197-01-00	. PIPE	1	
17	98503-06014-00	. SCREW, PAN HEAD	2	
18	92995-06100-00	. WASHER, SPRING	2	
19	1HV-14147-00-00	. O-RING	1	
20	98503-04014-00	. SCREW, PAN HEAD	1	
21	646-14212-00-00	. SPRING, PILOT ADJUSTING	1	
22	98503-04014-00	. SCREW, PAN HEAD	4	
23	92901-04100-00	. WASHER, SPRING	4	
24	6G8-1410A-00-00	. STARTER SET	1	
25	6G8-14827-00-00	. FILTER	1	
26	6A4-14344-25-00	. JET, STARTER (# 50)	1	UR
26	6A4-14344-24-00	. JET, STARTER (#48) (# 48)	1	UR
27	5Y1-14397-00-00	. O-RING	1	
28	6G8-14383-00-00	. SCREW, DRAIN	1	
29	90116-06M26-00	. BOLT, STUD	2	
30	6G8-14368-02-00	. DIAPHRAGM ASSEMBLY	1	
31	6G8-14275-01-00	. .SPRING	1	UR
31	6G8-14275-00-00	. SPRING	1	UR
32	97890-05006-00	. SCREW, PAN HEAD	1	
33	646-14198-01-00	. GASKET	1	

CONTINUED ON NEXT FRAME >

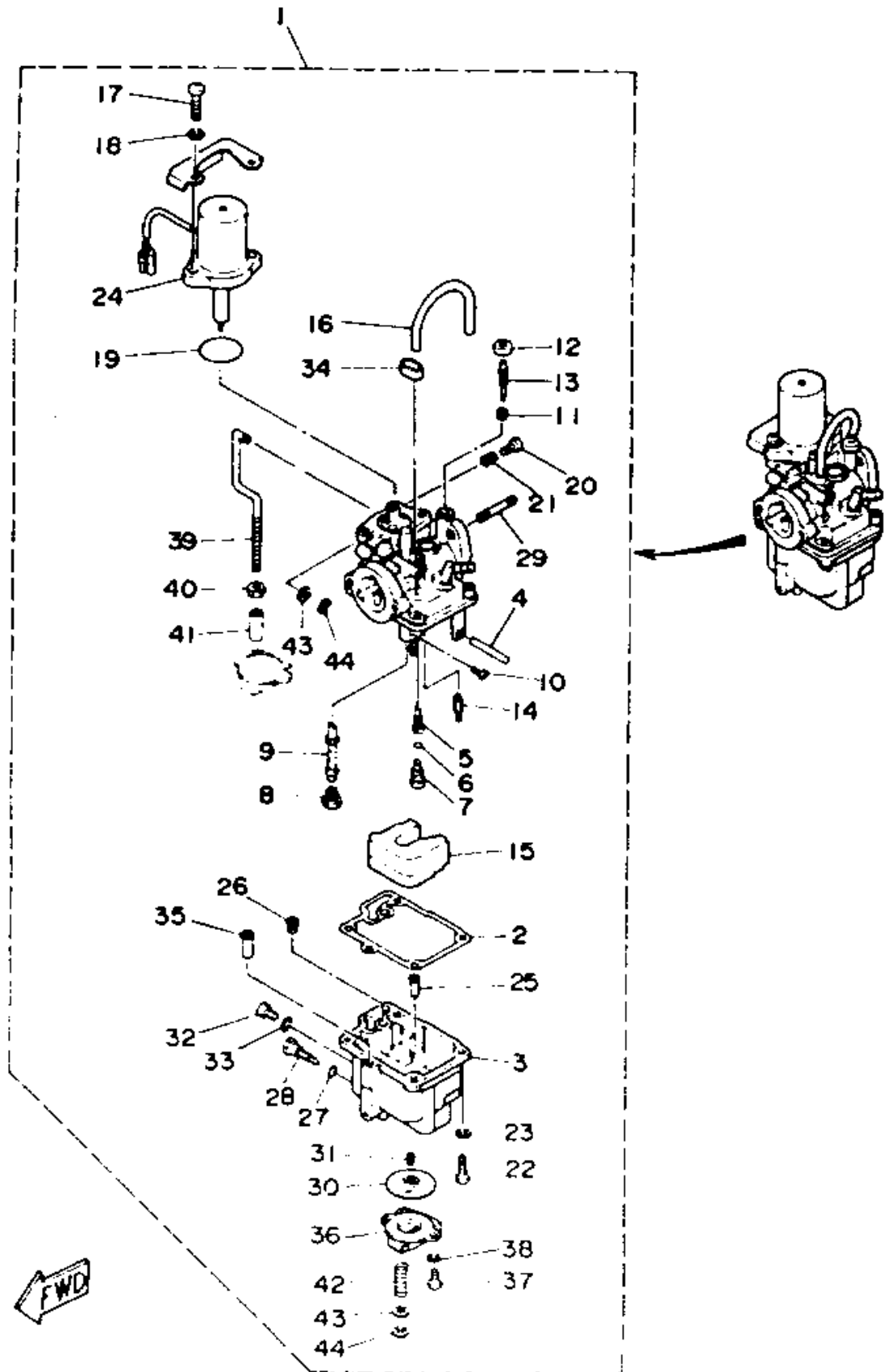

CARBURETOR

Ref No.	Part Number	Description	Qty	Remarks
34	6G8-14349-00-00	. PIPE	1	
35	6G8-14217-01-00	. VALVE, CHOKE	1	UR
35	6G8-14217-00-00	. VALVE, CHOKE	1	UR
36	6G8-14293-02-00	. COVER 1	1	UR
36	6G8-14293-03-00	. COVER 1	1	UR
37	98580-04010-00	. SCREW, PAN HEAD	2	
38	92990-04100-00	. WASHER, SPRING	2	
39	6G8-14379-00-00	. ROD, STARTER	1	
40	98813-03100-00	. NUT	1	
41	6G8-14229-00-00	. SHAFT, CHOKE	1	
42	6G8-14286-01-00	. SPRING	1	
43	6G8-14357-00-00	. WASHER, PLAIN	2	
44	389-14137-00-00	. CLIP	2	