

REPAIR KIT 1

Ref No.	Part Number	Description	Qty	Remarks
1	6N6-W0001-03-00	POWER HEAD GASKET KIT	1	
2	6K7-14483-00-00	. GASKET	2	
3	6E5-14198-A1-00	. GASKET	2	
4	6E5-11381-A1-00	. GASKET 1	1	
5	6E5-11181-A0-00	. GASKET, CYLINDER HEAD 1	2	
6	6E5-11193-A0-00	. GASKET, HEAD COVER 1	2	
7	688-12414-A1-00	. GASKET, COVER	2	
8	6E5-41112-A1-00	. GASKET, EXHAUST INNER COVER	2	
9	93102-40M38-00	. OIL SEAL	1	
10	93211-04384-00	. O-RING	2	
11	93102-35M13-00	. OIL SEAL	1	
12	93101-22M15-00	. OIL SEAL	1	
13	93210-74M35-00	. O-RING	1	
14	6E5-13621-A1-00	. GASKET, VALVE SEAT	4	
15	6E5-13645-A1-00	. GASKET, MANIFOLD 1	1	
16	6E5-14384-03-00	. GASKET, FLOAT CHAMBER	2	
17	6G5-45113-A0-00	. GASKET, UPPER CASING	1	
18	650-24431-A0-00	. GASKET, FUEL PUMP 1	1	
19	6E5-W0093-06-00	CARBURETOR REPAIR KIT	1	
20	6E5-14159-00-00	. CLIP	2	

CONTINUED ON NEXT FRAME >

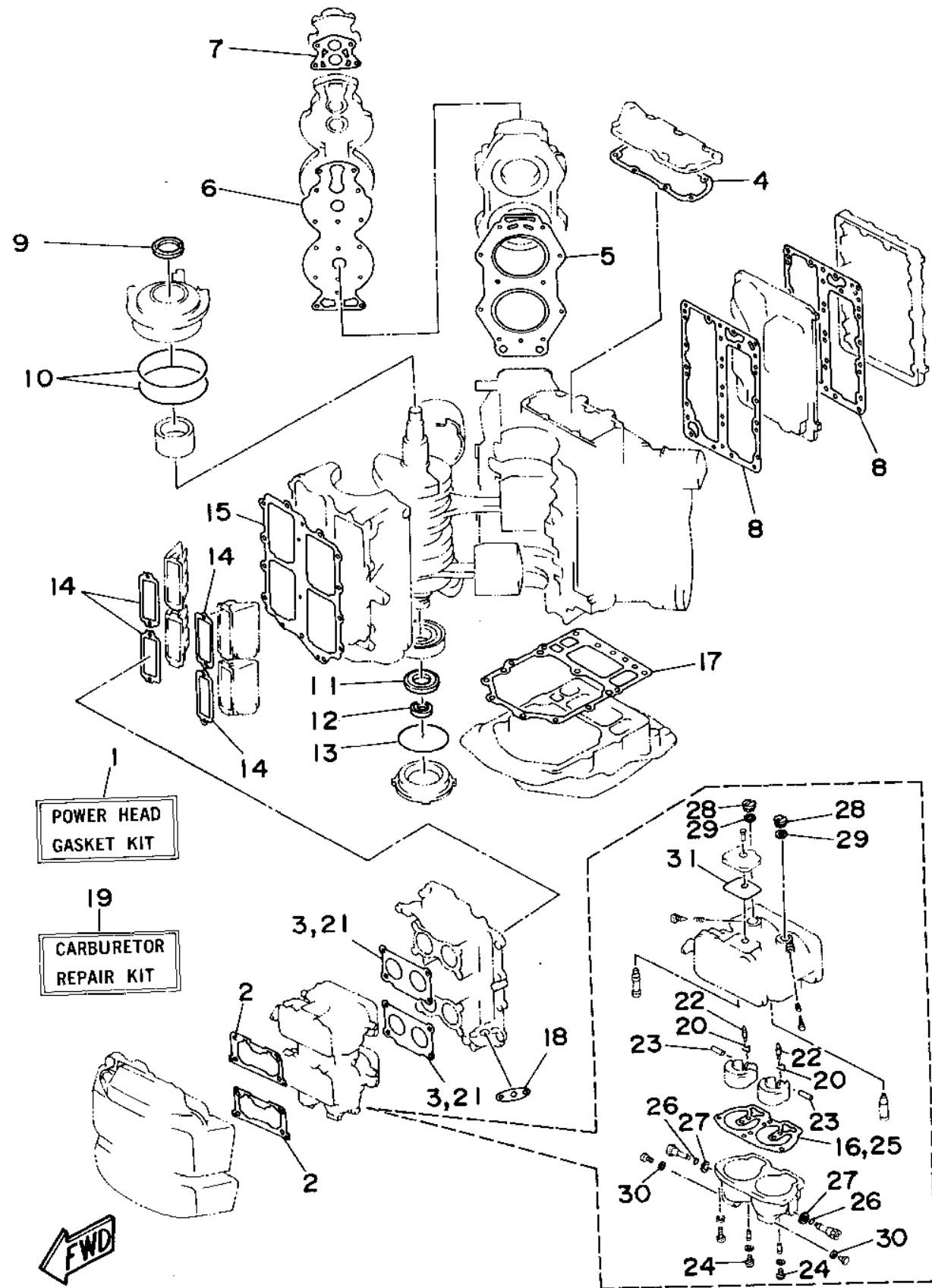

REPAIR KIT 1

Ref No.	Part Number	Description	Qty	Remarks
21	6E5-14198-A1-00	. GASKET	1	
22	6E5-14546-00-00	. VALVE, NEEDLE	2	
23	6E5-14386-02-00	. PIN, FLOAT	2	
24	6E5-14394-00-00	. PLUG, SLOW JET	2	
25	6E5-14384-03-00	. GASKET, FLOAT CHAMBER	1	
26	6E5-14997-00-00	. O-RING	2	
27	6E5-14398-01-00	. GASKET	2	
28	6E5-14328-01-00	. .PLUG	2	
29	6E5-14979-00-00	. GASKET	2	
30	6J8-14995-00-00	. GASKET	2	
31	6E5-14959-01-00	. GASKET	1	