

REPAIR KIT 1

Ref No.	Part Number	Description	Qty	Remarks
1	6R6-W0001-02-00	POWER HEAD GASKET KIT	1	
2	676-11181-A1-00	. GASKET, CYLINDER HEAD 1	1	
3	6E9-11193-A0-00	. GASKET, HEAD COVER 1	1	
4	6E9-12414-A0-00	. GASKET, COVER	1	
5	676-41112-A0-00	. GASKET, EXHAUST INNER COVER	1	
6	6E9-41114-A0-00	. GASKET, EXHAUST OUTER COVER	1	
7	93102-32M07-00	. OIL SEAL	1	
8	93210-42159-00	. O-RING	1	
9	93101-16M36-00	. OIL SEAL	1	
10	93101-28M19-00	. OIL SEAL	1	
11	93102-28M08-00	. OIL SEAL	1	
12	93210-62269-00	. O-RING	1	
13	93210-22M02-00	. O-RING	1	
14	676-13646-A0-00	. GASKET, MANIFOLD 2	2	
15	6E9-14198-A0-00	. GASKET	1	
16	93210-32738-00	. O-RING	1	
17	650-24431-A0-00	. GASKET, FUEL PUMP 1	1	
18	6F5-45113-A0-00	. GASKET, UPPER CASING	1	
19	676-45114-A0-00	. GASKET, UPPER CASING	1	
20	6E9-W0093-03-00	CARBURETOR REPAIR KIT	1	

CONTINUED ON NEXT FRAME >

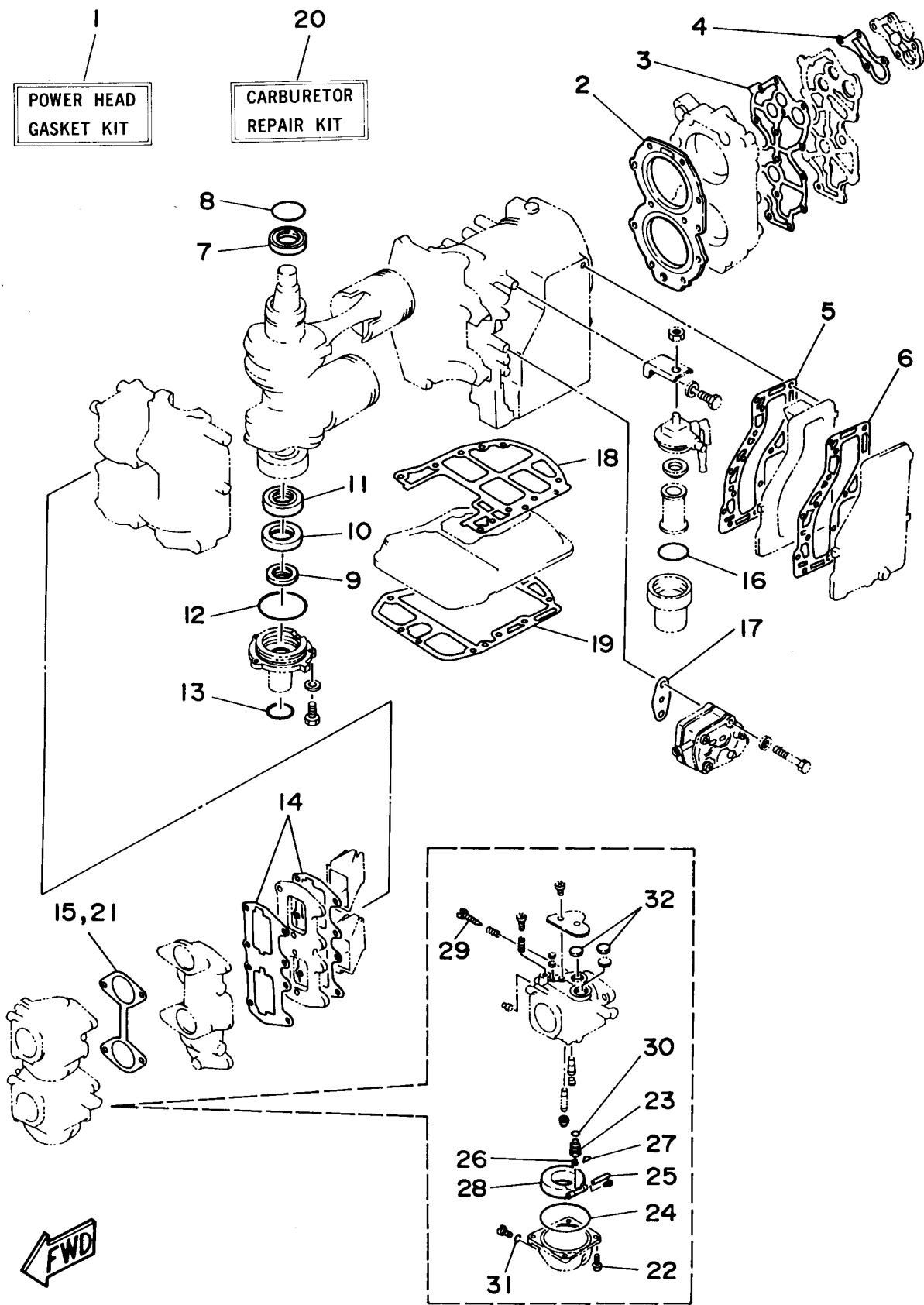

REPAIR KIT 1

Ref No.	Part Number	Description	Qty	Remarks
21	6E9-14198-A0-00	. GASKET	1	
22	97980-04114-00	. .SCREW, WITH WASHER	2	
23	6E9-14590-00-00	. NEEDLE VALVE ASSEMBLY	2	
24	676-14984-00-00	. GASKET, FLOAT CHAMBER	2	
25	688-14548-00-00	. PIN, FLOAT ARM	2	
26	676-14186-00-00	. PIN, FLOAT	2	
27	663-14159-00-00	. .CLIP	2	
28	676-14985-01-00	. FLOAT	2	
29	692-14923-00-00	. SCREW, PILOT	2	
30	93210-04228-00	. O-RING	2	
31	93210-04230-00	. O-RING	2	
32	688-14126-00-00	. GASKET	4	