

CRANKSHAFT PISTON

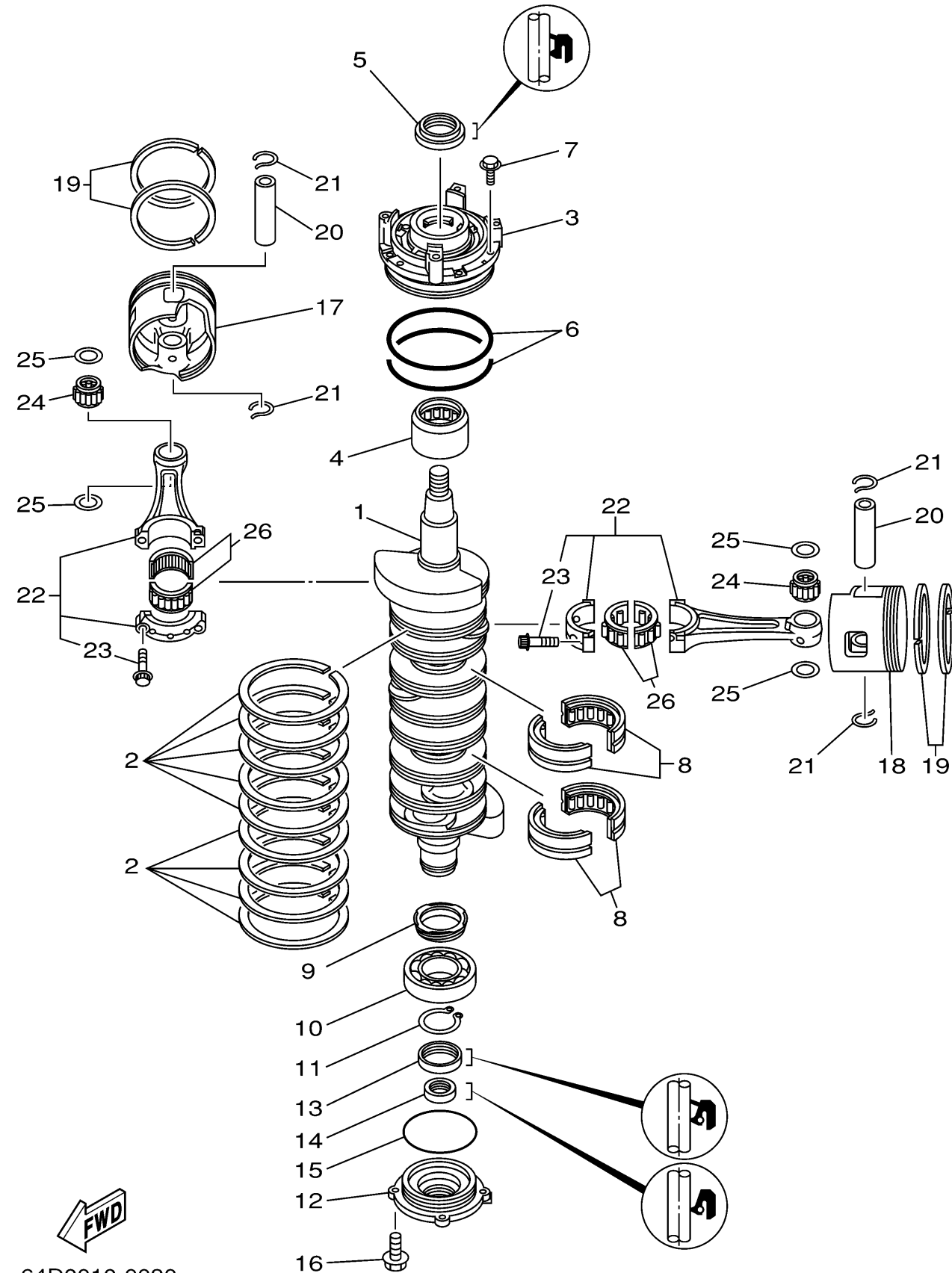

Ref No.	Part Number	Description	Qty	Remarks
1	6G5-11411-02-00	CRANKSHAFT	1	(150)
2	6E5-11447-00-00	SEAL, CRANK	9	(150)
3	6R3-15163-00-1S	HOUSING, BEARING 1	1	(150)
4	93311-940U3-00	BEARING	1	(150)
5	93102-40M14-00	.OIL SEAL	1	(150)
6	93211-04001-00	.O-RING	2	(150)
7	90119-06MA2-00	BOLT, WITH WASHER	3	(150)
8	93310-954U1-00	BEARING	2	(150)
9	6R3-11536-00-00	GEAR, DRIVE	1	(150)
10	93306-208U0-00	BEARING	1	(150)
11	93410-40M03-00	CIRCLIP	1	(150)
12	6G5-15359-00-94	HOUSING, OIL SEAL	1	(150)
13	93102-35M13-00	OIL SEAL	1	(150)
14	93101-22M15-00	.OIL SEAL	1	(150)
15	93210-74M35-00	.O-RING	1	(150)
16	90119-06MA2-00	BOLT, WITH WASHER	4	(150)
17	64D-11636-02-00	PISTON (0.50MM O/S)	3	AP(150)
17	64D-11635-02-00	PISTON (0.25MM O/S)	3	AP(150)
17	64D-11631-02-90	PISTON (STD)	3	(150)
18	64D-11646-02-00	PISTON 2 (0.50MM O/S)	3	AP(150)

CONTINUED ON NEXT FRAME >

FWD
64D0010-0030
150txra

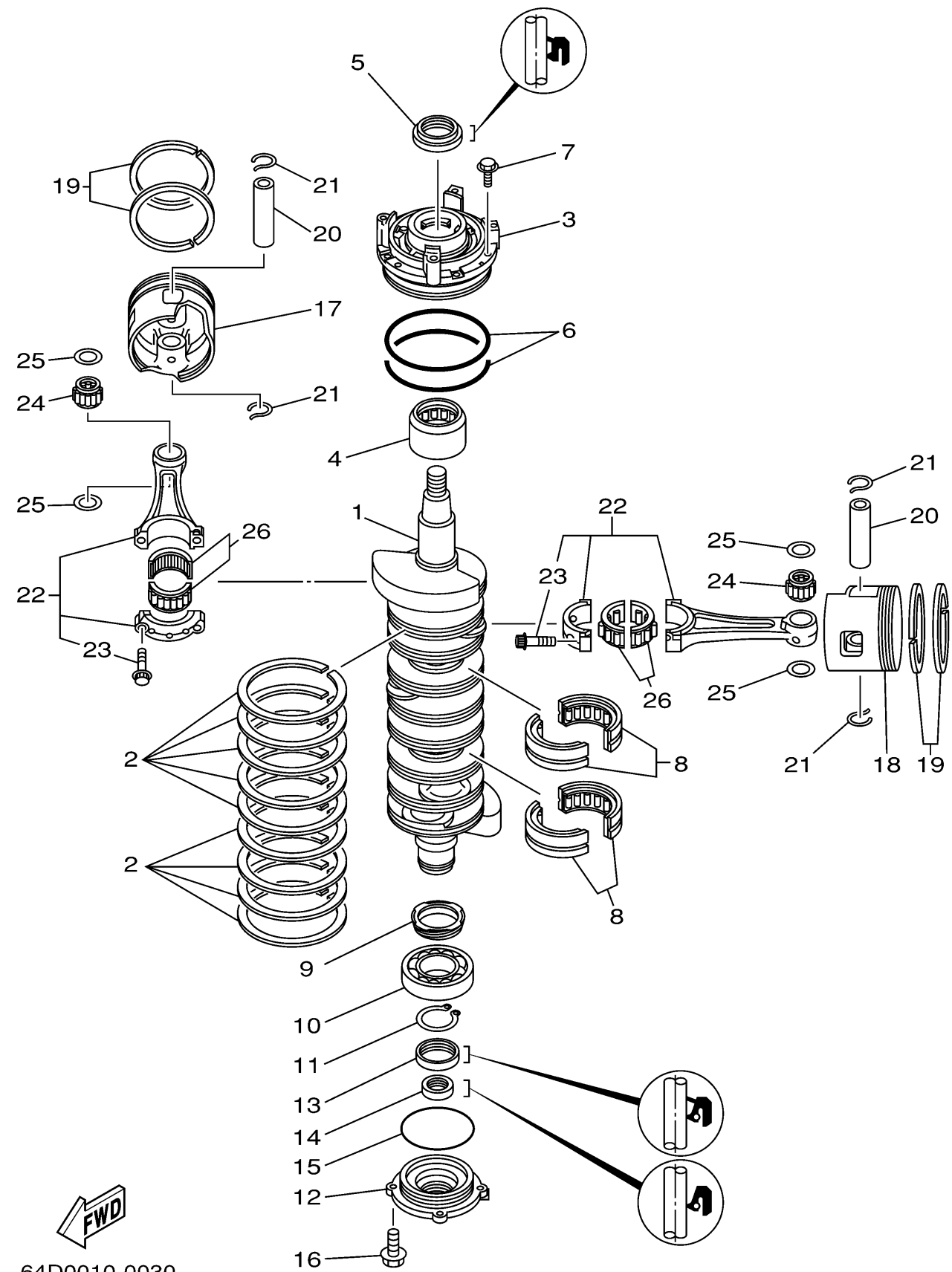

CRANKSHAFT PISTON

Ref No.	Part Number	Description	Qty	Remarks
18	64D-11645-02-00	PISTON 2 (0.25MM O/S)	3	AP(150)
18	64D-11642-02-90	PISTON 2 (STD)	3	(150)
19	64D-11603-01-00	PISTON RING SET (STD)	6	(150)
19	64D-11604-01-00	PISTON RING SET (0.25MM O/S)	6	AP(150)
19	64D-11605-01-00	PISTON RING SET (0.50MM O/S)	6	AP(150)
20	6R5-11633-10-00	PIN, PISTON	6	(150)
21	6R5-11634-10-00	CLIP, PISTON PIN	12	(150)
22	6R5-11650-10-00	CONNECTING ROD ASSY	6	(150)
23	90109-08022-00	. .BOLT	2	(150)
24	93310-323V6-00	BEARING	6	(150)
25	90201-23M01-00	WASHER, PLATE	12	(150)
26	93310-836V2-00	BEARING	6	(150)

 64D0010-0030
 150txra