

CRANKSHAFT PISTON

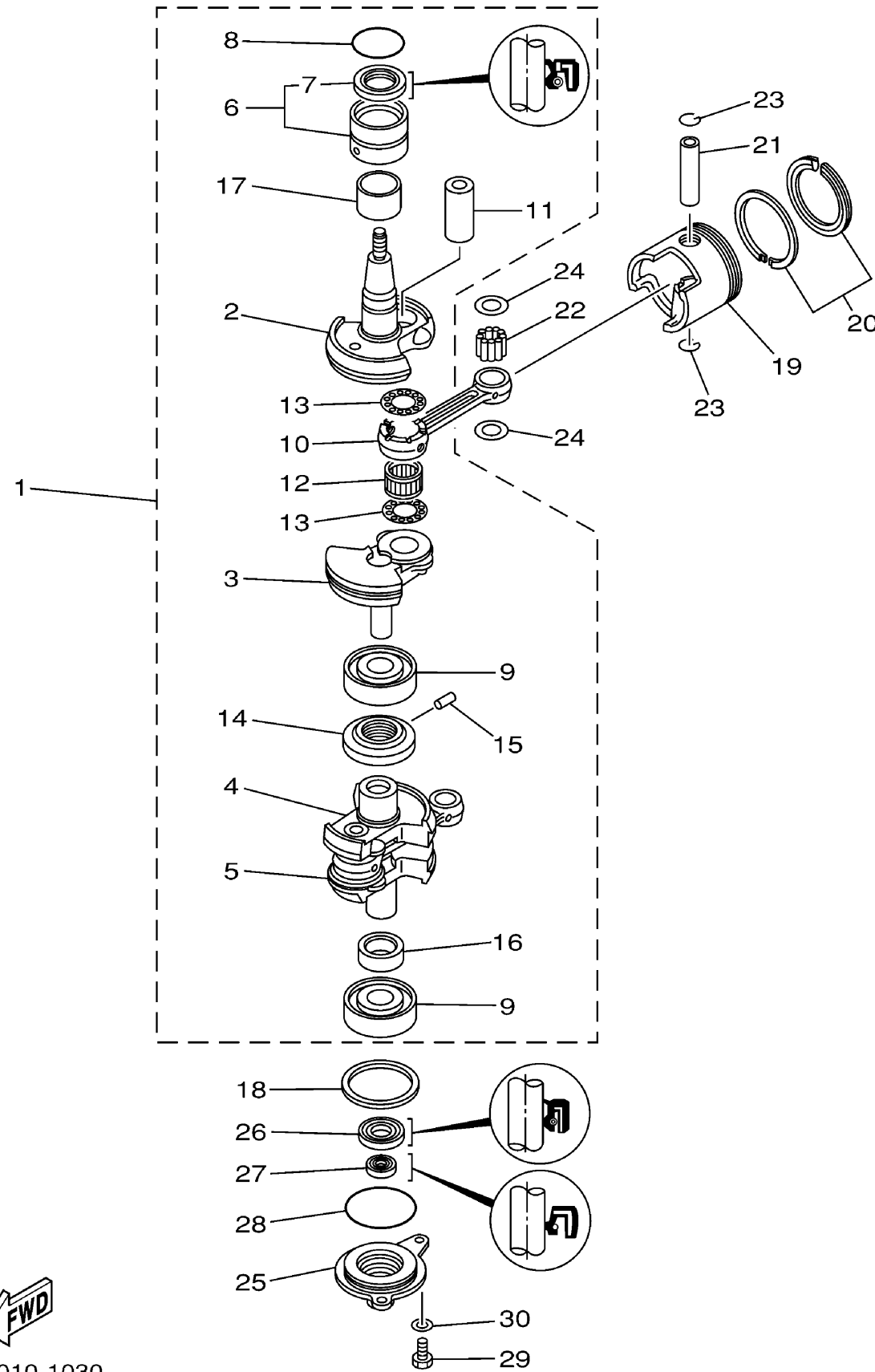

Ref No.	Part Number	Description	Qty	Remarks
1	6L2-11400-00-00	CRANKSHAFT ASSY	1	N.O/I(25MH)
2	6L2-11412-00-00	..CRANK 1	1	(25MH)
3	6L2-11422-00-00	..CRANK 2	1	(25MH)
4	6L2-11432-00-00	..CRANK 3	1	(25MH)
5	6L2-11442-00-00	..CRANK 4	1	(25MH)
6	93311-632U7-00	..BEARING	1	(25MH)
7	93102-26M27-00	...OIL SEAL	1	(25MH)
8	93210-42159-00	..O-RING	1	(25MH)
9	93306-305U3-00	..BEARING	2	(25MH)
10	6L2-11651-00-00	..ROD, CONNECTING	2	(25MH)
11	6L2-11681-00-00	..PIN, CRANK 1	2	(25MH)
12	93310-424W9-00	..BEARING	2	(25MH)
13	90209-24M15-00	..WASHER	4	(25MH)
14	6L2-11515-00-00	..SEAL, LABYRINTH 1	1	(25MH)
15	91690-30010-00	..PIN, SPRING	1	(25MH)
16	6J8-11445-00-00	..SPACER	1	N.O/I(25MH)
17	90387-28M00-00	..COLLAR	1	(25MH)
18	90201-50306-00	WASHER, PLATE	1	(25MH)
19	6L2-11635-00-00	PISTON (0.25MM O/S)	2	AP(25MH)
19	6L2-11631-00-97	PISTON (STD)	2	(25MH)

CONTINUED ON NEXT FRAME >



6L20010-1030
25msha

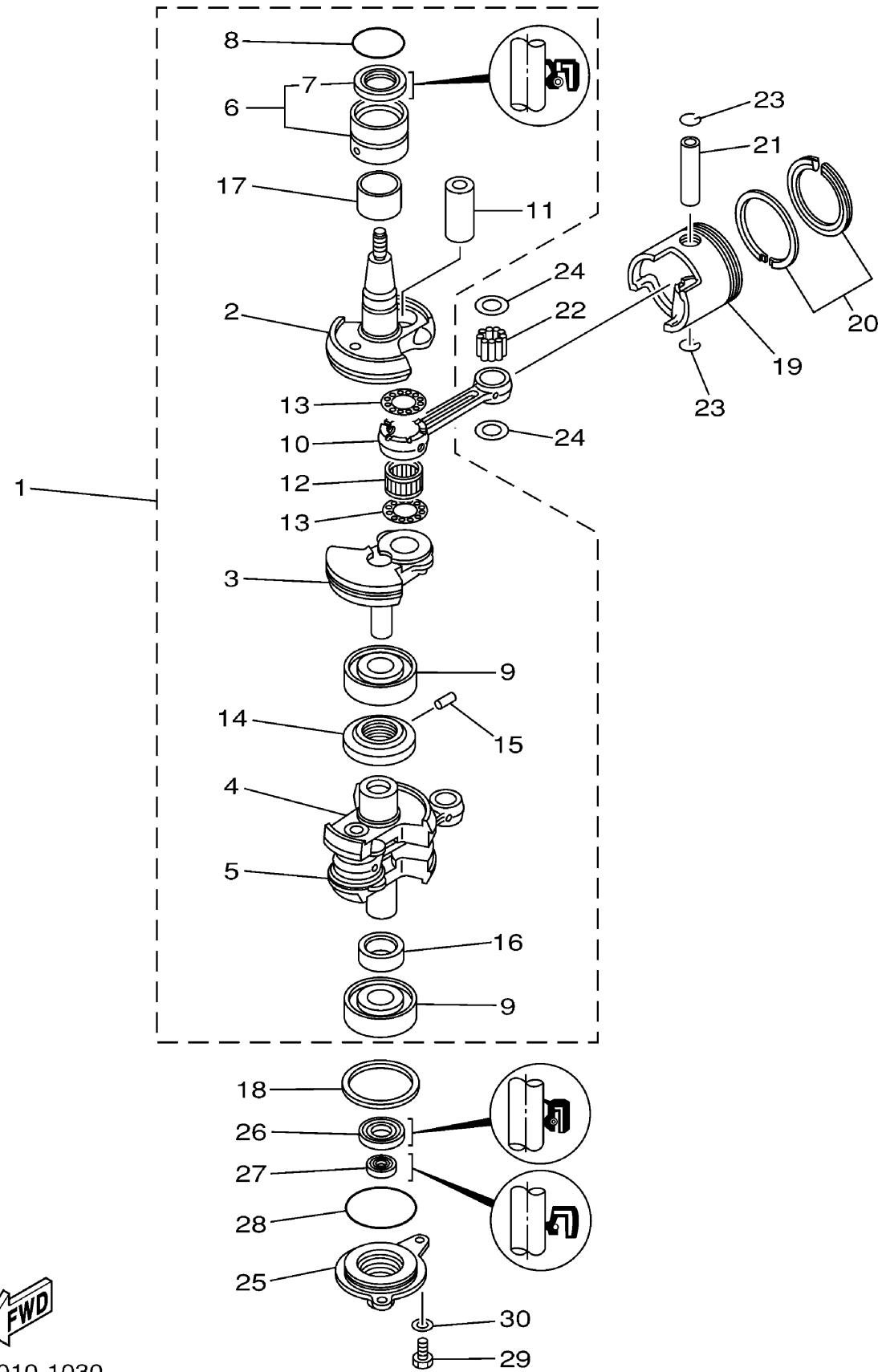

CRANKSHAFT PISTON

Ref No.	Part Number	Description	Qty	Remarks
19	6L2-11636-00-00	PISTON (0.50MM O/S)	2	AP(25MH)
20	6L2-11610-20-00	PISTON RING SET (0.50MM O/S)	2	AP(25MH)
20	6L2-11610-10-00	PISTON RING SET (0.25MM O/S)	2	AP(25MH)
20	6L2-11610-00-00	PISTON RING SET (STD)	2	(25MH)
21	648-11633-00-00	PIN, PISTON	2	(25MH)
22	93602-18M12-00	PIN, DOWEL	62	(25MH)
23	93450-20026-00	CIRCLIP	4	(25MH)
24	90201-18522-00	WASHER, PLATE	4	(25MH)
25	6L2-15396-00-1S	HOUSING, OIL SEAL	1	(25MH)
26	93102-25142-00	.OIL SEAL	1	(25MH)
27	93101-13M37-00	.OIL SEAL	1	(25MH)
28	93210-56M80-00	.O-RING	1	(25MH)
29	97095-06016-00	BOLT	2	(25MH)
30	92995-06600-00	WASHER	2	(25MH)



6L20010-1030
25msha