

CRANKSHAFT PISTON

Ref No.	Part Number	Description	Qty	Remarks
1	61A-11411-00-00	CRANKSHAFT	1	
2	61A-11447-00-00	SEAL, CRANK	9	
3	93311-940V0-00	BEARING	1	
4	93102-40M38-00	. OIL SEAL	1	
5	93210-54M54-00	O-RING	1	
6	93306-209U1-00	BEARING	1	
7	93310-959U0-00	BEARING	2	
8	61A-11536-00-00	GEAR, DRIVE	1	
9	93306-308U0-00	BEARING	1	
10	93410-40M03-00	CIRCLIP	1	
11	61A-11586-01-00	PULLEY, CRANKSHAFT BALANCE	1	
12	61A-11555-01-00	NUT, CRANKSHAFT 1	1	
13	93104-22M07-00	.OIL SEAL	1	
14	61A-15359-00-94	HOUSING, OIL SEAL	1	
15	93102-40M36-00	.OIL SEAL	1	
16	93420-61M07-00	CIRCLIP	1	
17	93210-81MA6-00	.O-RING	1	
18	97095-06020-00	BOLT	4	
19	92995-06100-00	WASHER, SPRING	4	
20	69L-11636-00-00	PISTON (0.50MM O/S)	3	AP

CONTINUED ON NEXT FRAME >



61A0010-7030

sx225tra_sx250tra_lx225tra_lx250tra

A10

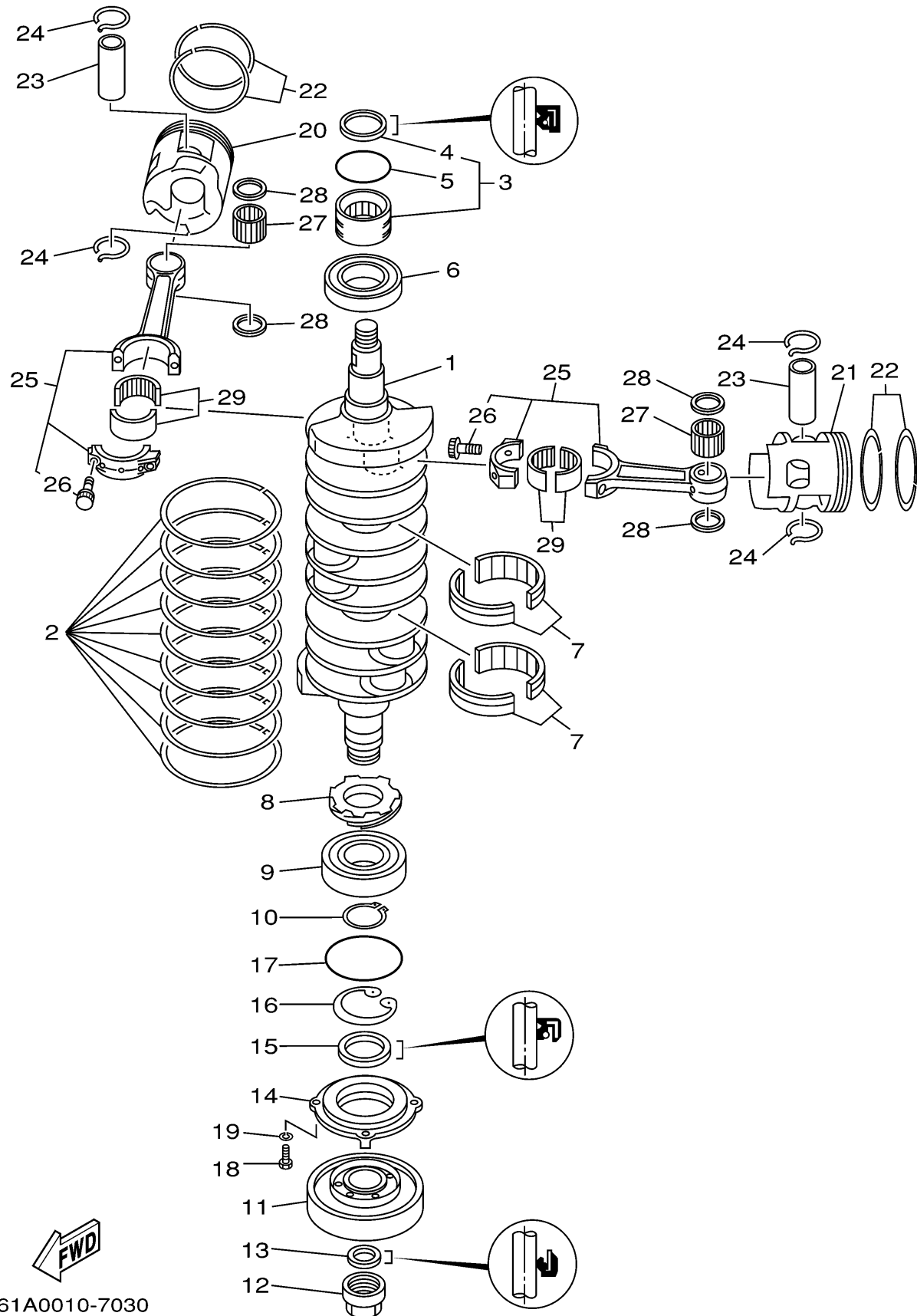

61A0010-7030

sx225tra_sx250tra_lx225tra_lx250tra

CRANKSHAFT PISTON

Ref No.	Part Number	Description	Qty	Remarks
20	69L-11631-00-85	PISTON (STD)	3	
20	69L-11635-00-00	PISTON (0.25MM O/S)	3	AP
21	69L-11642-00-85	PISTON 2 (STD)	3	
21	69L-11646-00-00	PISTON 2 (0.50MM O/S)	3	AP
21	69L-11645-00-00	PISTON 2 (0.25MM O/S)	3	AP
22	64D-11605-01-00	PISTON RING SET (0.50MM O/S)	6	AP
22	64D-11604-01-00	PISTON RING SET (0.25MM O/S)	6	AP
22	64D-11603-01-00	PISTON RING SET (STD)	6	
23	61A-11633-02-00	PIN, PISTON	6	
24	61A-11634-00-00	CLIP, PISTON PIN	12	
25	61A-11650-00-00	CONNECTING ROD ASSY	6	
26	90109-09001-00	. .BOLT	2	
27	93310-326V4-00	BEARING	6	
28	90201-26M03-00	WASHER, PLATE	12	
29	93310-840V8-00	BEARING	6	