

CRANKSHAFT PISTON

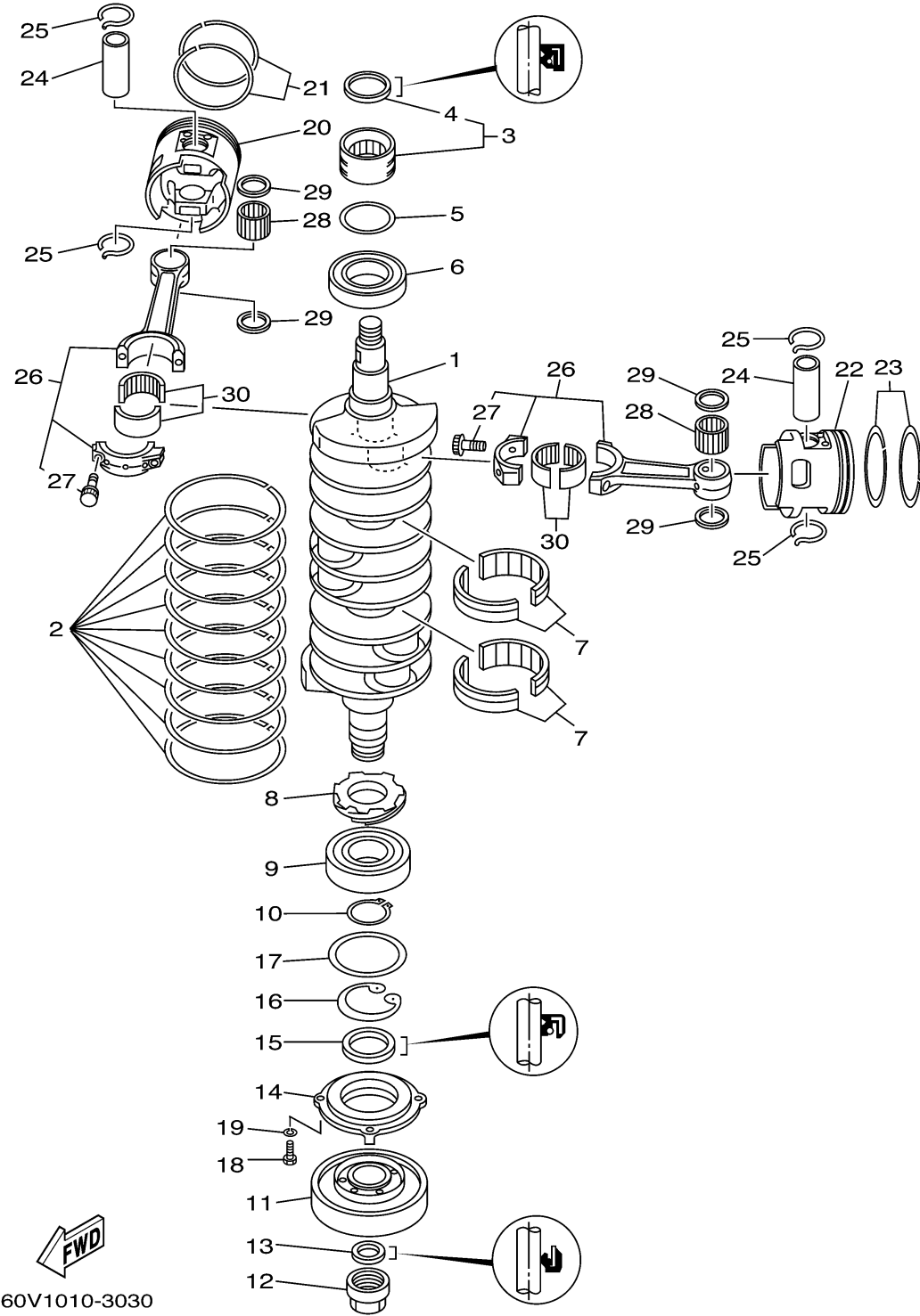

Ref No.	Part Number	Description	Qty	Remarks
1	61A-11411-00-00	CRANKSHAFT	1	
2	61A-11447-00-00	SEAL, CRANK	9	
3	93311-940V0-00	BEARING	1	
4	93102-40M38-00	. OIL SEAL	1	
5	60V-11479-00-00	.GASKET	1	
6	93306-209U1-00	BEARING	1	
7	93310-959U0-00	BEARING	2	
8	61A-11536-00-00	GEAR, DRIVE	1	
9	93306-308U0-00	BEARING	1	
10	93410-40M03-00	CIRCLIP	1	
11	61A-11586-01-00	PULLEY, CRANKSHAFT BALANCE	1	
12	60V-11555-00-00	NUT, CRANKSHAFT 1	1	
13	93104-22M07-00	.OIL SEAL	1	
14	60V-15359-00-94	HOUSING, OIL SEAL	1	
15	93102-40010-00	.OIL SEAL	1	
16	93420-61M07-00	CIRCLIP	1	
17	60V-15353-00-00	.GASKET, DRAIN	1	
18	97095-06020-00	BOLT	4	
19	92995-06100-00	WASHER, SPRING	4	
20	60V-11636-01-00	PISTON (0.50MM O/S)	3	AP

CONTINUED ON NEXT FRAME >

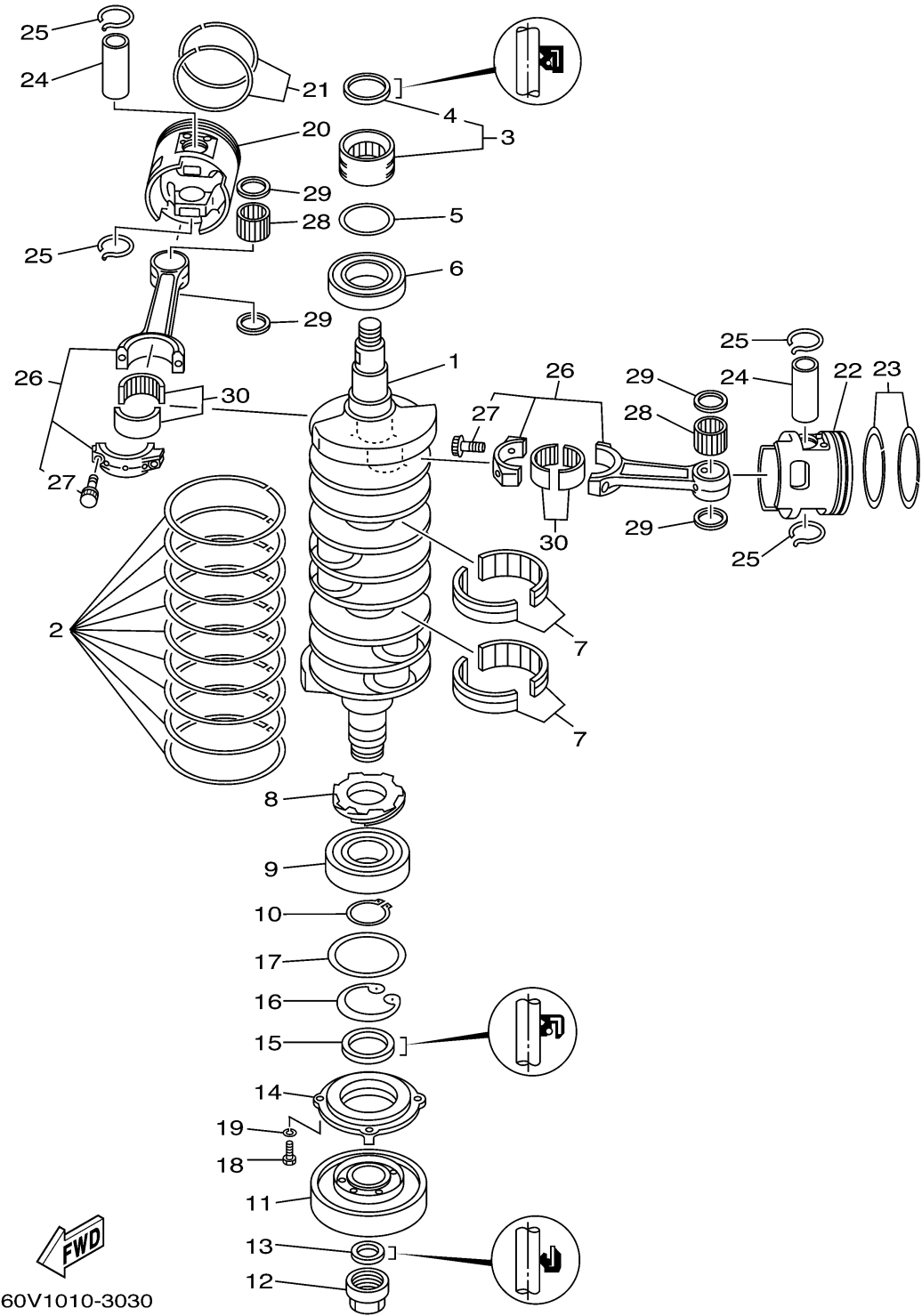

CRANKSHAFT PISTON

Ref No.	Part Number	Description	Qty	Remarks
20	60V-11631-01-85	PISTON (STD)	3	
20	60V-11635-01-00	PISTON (0.25MM O/S)	3	AP
21	60V-11603-00-00	PISTON RING SET (STD)	3	
21	60V-11605-00-00	PISTON RING SET (0.50MM O/S)	3	AP
21	60V-11604-00-00	PISTON RING SET (0.25MM O/S)	3	AP
22	60V-11646-01-00	PISTON 2 (0.50MM O/S)	3	AP
22	60V-11645-01-00	PISTON 2 (0.25MM O/S)	3	AP
22	60V-11642-01-85	PISTON 2 (STD)	3	
23	60V-11603-00-00	PISTON RING SET (STD)	3	
23	60V-11604-00-00	PISTON RING SET (0.25MM O/S)	3	AP
23	60V-11605-00-00	PISTON RING SET (0.50MM O/S)	3	AP
24	61A-11633-02-00	PIN, PISTON	6	
25	60X-11634-00-00	CLIP, PISTON PIN	12	
26	69L-11650-00-00	CONNECTING ROD ASSY	6	
27	90109-09001-00	. .BOLT	2	
28	93310-32657-00	BEARING	6	
29	90201-26M03-00	WASHER, PLATE	12	
30	93310-84106-00	BEARING	6	