

CARBURETOR 2

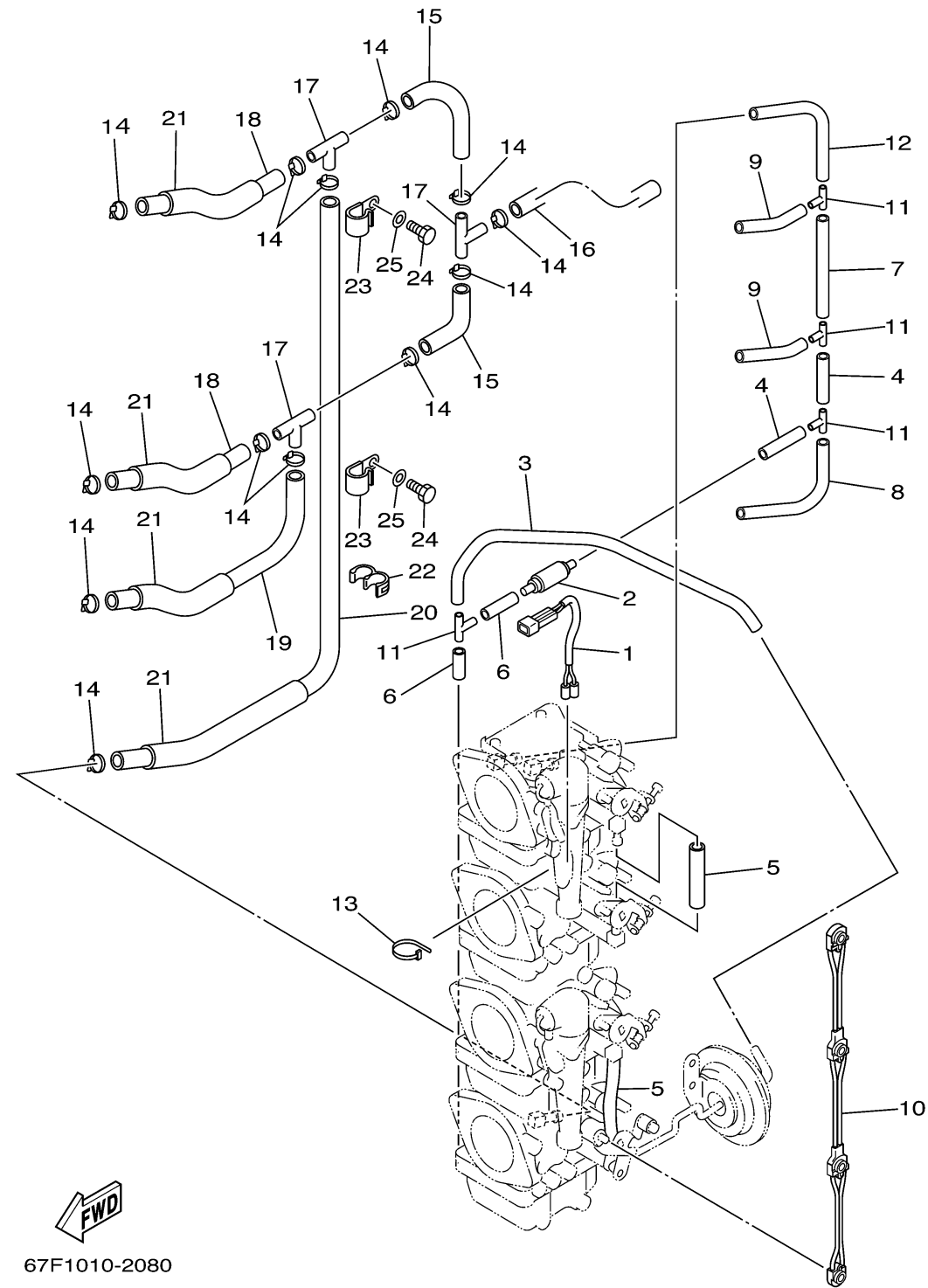

67F1010-2080

Ref No.	Part Number	Description	Qty	Remarks
1	67F-1412A-00-00	WIRE HARNESS ASSY	1	F75
2	67F-13183-00-00	VALVE, CHECK	1	F75
3	67F-14349-00-00	PIPE	1	F75
4	67F-14349-10-00	PIPE	2	F75
5	67F-14349-20-00	PIPE	2	F75
6	67F-14349-30-00	PIPE	2	F75
7	67F-14349-40-00	PIPE	1	F75
8	67F-14349-50-00	PIPE	1	F75
9	67F-14349-60-00	PIPE	2	F75
10	67F-14585-00-00	ROD, CHOKE	1	F75
11	67F-14189-00-00	CONNECTOR	4	F75
12	67F-14349-70-00	PIPE	1	F75
13	90465-11M59-00	CLAMP	1	F75
14	68F-24356-00-00	.CLIP, PIPE 1	13	F75
15	60C-14294-00-00	HOSE	2	F75
16	60C-14298-00-00	PIPE	1	F75
17	688-24378-00-00	PIPE, JOINT 3	3	F75
18	90445-10M16-00	HOSE (L120)	2	F75
19	90445-10MG6-00	HOSE (L180)	1	F75
20	90445-10MG7-00	HOSE (L350)	1	F75

CONTINUED ON NEXT FRAME >

CARBURETOR 2

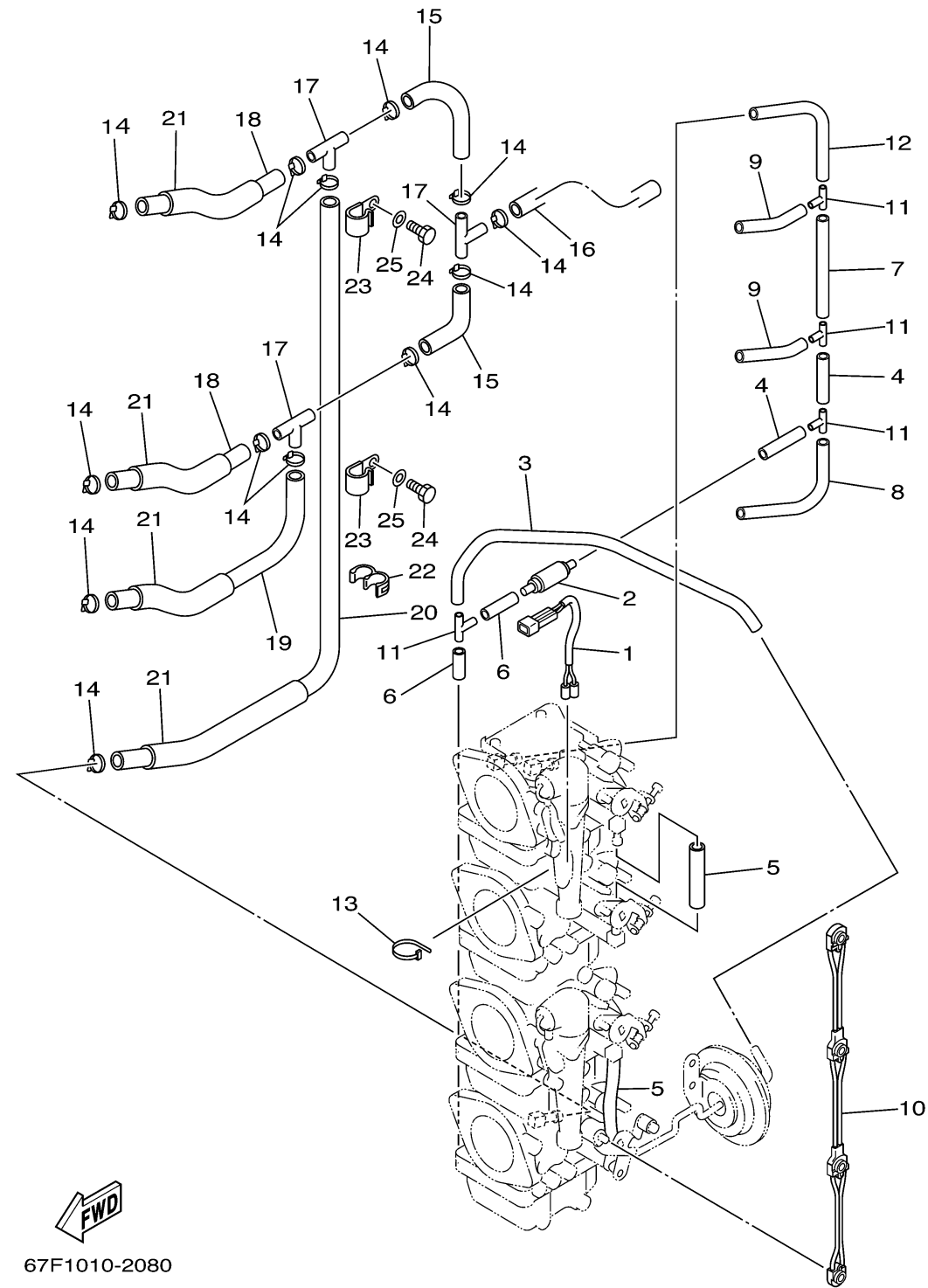

Ref No.	Part Number	Description	Qty	Remarks
21	90445-16M07-00	HOSE (L80)	4	F75
22	90464-10M57-00	CLAMP	1	F75
23	90465-08M83-00	CLAMP	2	F75
24	97095-06012-00	.BOLT	2	F75
25	92995-06600-00	WASHER	2	F75