

CRANKSHAFT PISTON

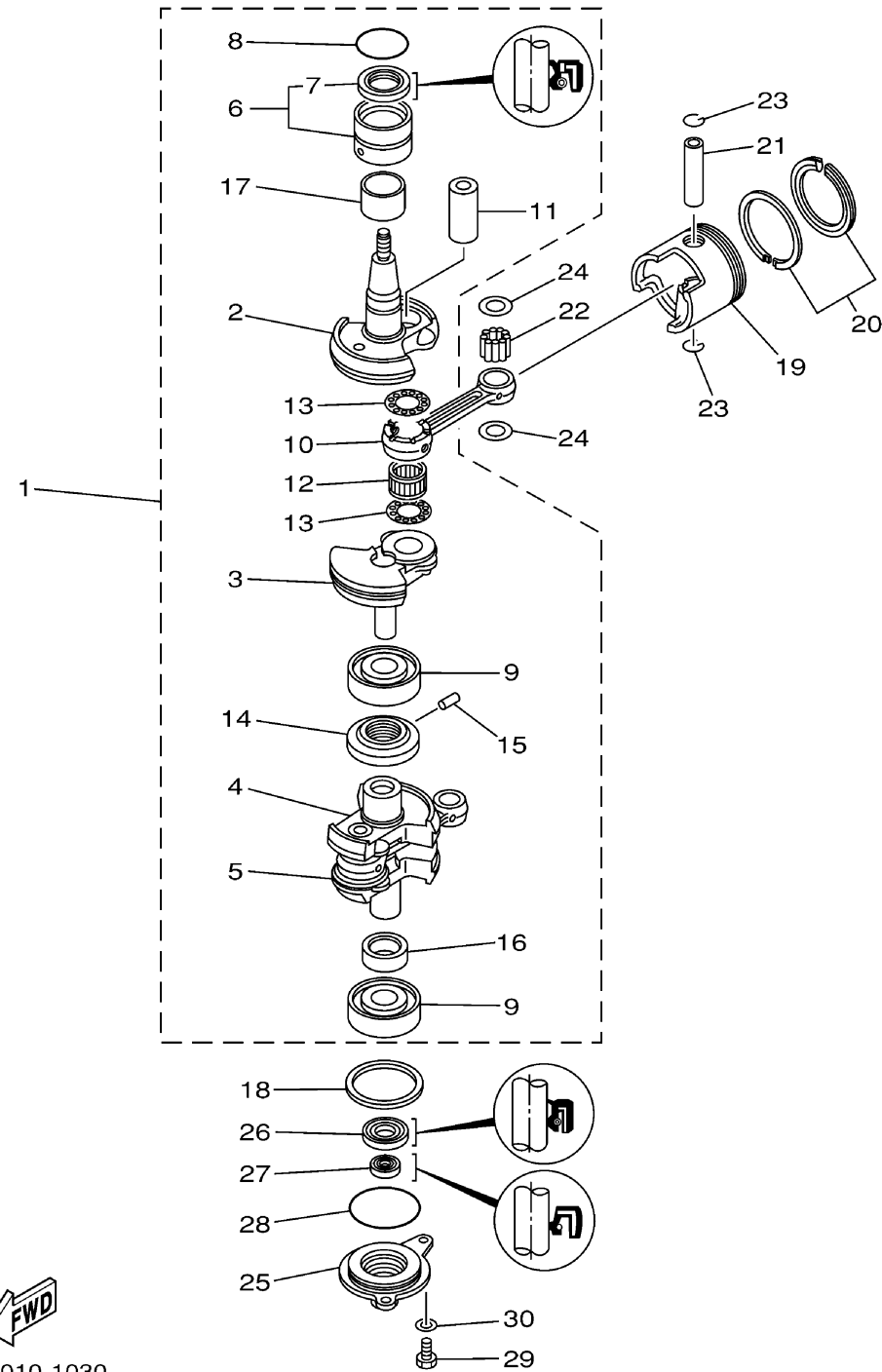

Ref No.	Part Number	Description	Qty	Remarks
1	6L2-11400-00-00	CRANKSHAFT ASSY	1	N.O/I
2	6L2-11412-00-00	..CRANK 1	1	
3	6L2-11422-00-00	..CRANK 2	1	
4	6L2-11432-00-00	..CRANK 3	1	
5	6L2-11442-00-00	..CRANK 4	1	
6	93311-632U7-00	..BEARING	1	
7	93102-26M27-00	...OIL SEAL	1	
8	93210-42159-00	..O-RING	1	
9	93306-305U3-00	..BEARING	2	
10	6L2-11651-00-00	..ROD, CONNECTING	2	
11	6L2-11681-00-00	..PIN, CRANK 1	2	
12	93310-424W9-00	..BEARING	2	
13	90209-24M15-00	..WASHER	4	
14	6L2-11515-00-00	..SEAL, LABYRINTH 1	1	
15	91690-30010-00	..PIN, SPRING	1	
16	6J8-11445-00-00	..SPACER	1	N.O/I
17	90387-28M00-00	..COLLAR	1	
18	90201-50306-00	WASHER, PLATE	1	
19	6L2-11631-00-97	PISTON (STD)	2	
19	6L2-11636-00-00	PISTON (0.50MM O/S)	2	AP

CONTINUED ON NEXT FRAME >

6L20010-1030

CRANKSHAFT PISTON

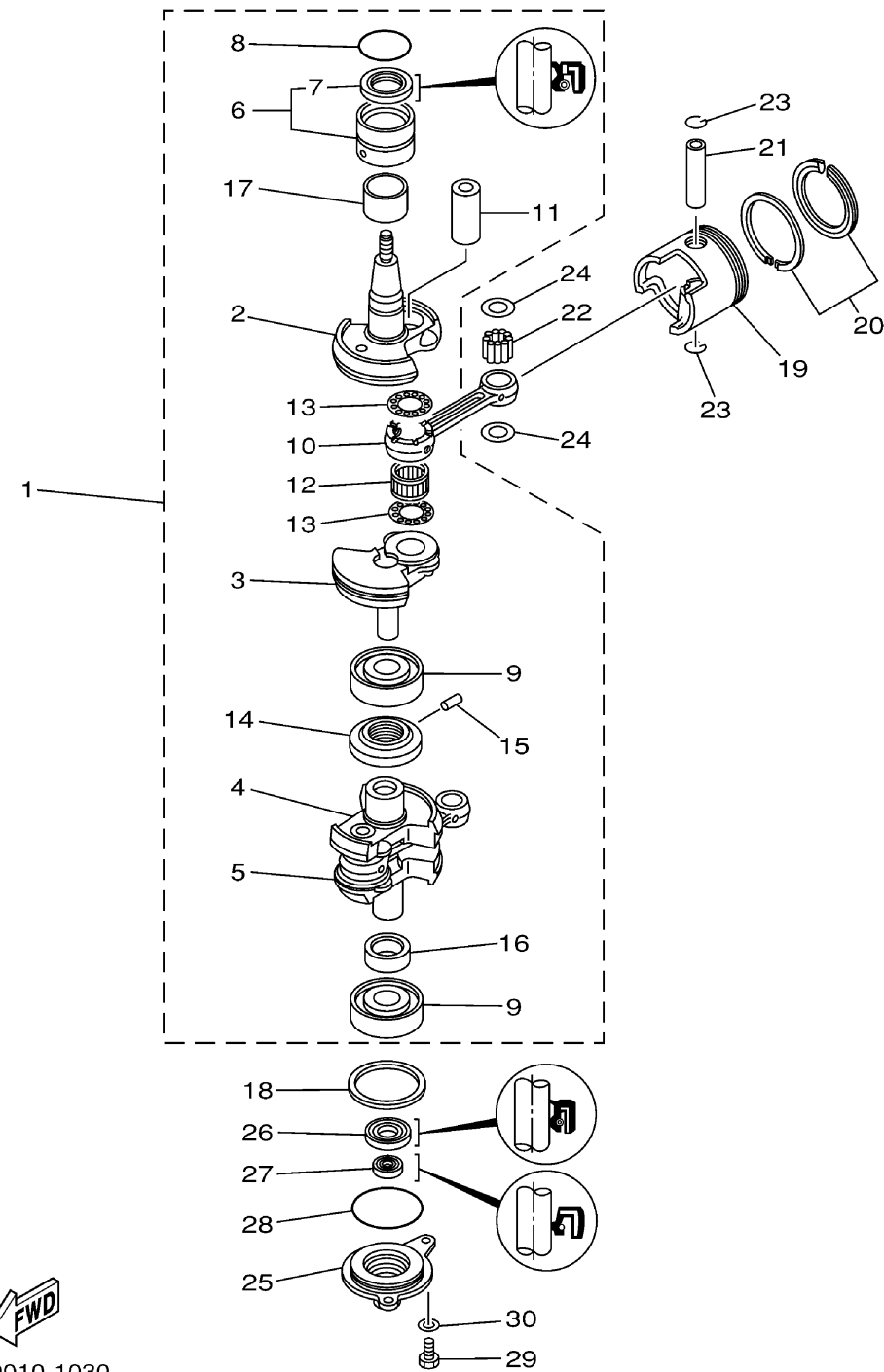

Ref No.	Part Number	Description	Qty	Remarks
19	6L2-11635-00-00	PISTON (0.25MM O/S)	2	AP
20	6L2-11610-00-00	PISTON RING SET (STD)	2	
20	6L2-11610-20-00	PISTON RING SET (0.50MM O/S)	2	AP
20	6L2-11610-10-00	PISTON RING SET (0.25MM O/S)	2	AP
21	648-11633-00-00	PIN, PISTON	2	
22	93602-18M12-00	PIN, DOWEL	62	
23	93450-20026-00	CIRCLIP	4	
24	90201-18522-00	WASHER, PLATE	4	
25	6L2-15396-00-1S	HOUSING, OIL SEAL	1	
26	93102-25142-00	.OIL SEAL	1	
27	93101-13M37-00	.OIL SEAL	1	
28	93210-56M80-00	.O-RING	1	
29	97095-06016-00	BOLT	2	
30	92995-06600-00	WASHER	2	

 6L20010-1030