

CRANKSHAFT PISTON

Ref No.	Part Number	Description	Qty	Remarks
1	6N7-11411-01-00	CRANKSHAFT	1	
2	6E5-11447-00-00	SEAL, CRANK	6	
3	6R3-15163-00-1S	HOUSING, BEARING 1	1	
4	93311-940U3-00	BEARING	1	
5	93102-40M14-00	.OIL SEAL	1	
6	93211-04001-00	.O-RING	2	
7	90119-06MA2-00	BOLT, WITH WASHER	3	
8	93310-954U1-00	BEARING	1	
9	6R3-11536-00-00	GEAR, DRIVE	1	
10	93306-208U0-00	BEARING	1	
11	93410-40M03-00	CIRCLIP	1	
12	6G5-15359-00-94	HOUSING, OIL SEAL	1	
13	93102-35M13-00	OIL SEAL	1	
14	93101-22M15-00	.OIL SEAL	1	
15	93210-74M35-00	.O-RING	1	
16	90119-06MA2-00	BOLT, WITH WASHER	4	
17	6R5-11635-11-00	PISTON (0.25MM O/S)	2	AP
17	6R5-11631-11-93	PISTON (STD)	2	
17	6R5-11636-11-00	PISTON (0.50MM O/S)	2	AP
18	64D-11603-02-00	PISTON RING SET (STD)	2	

CONTINUED ON NEXT FRAME >

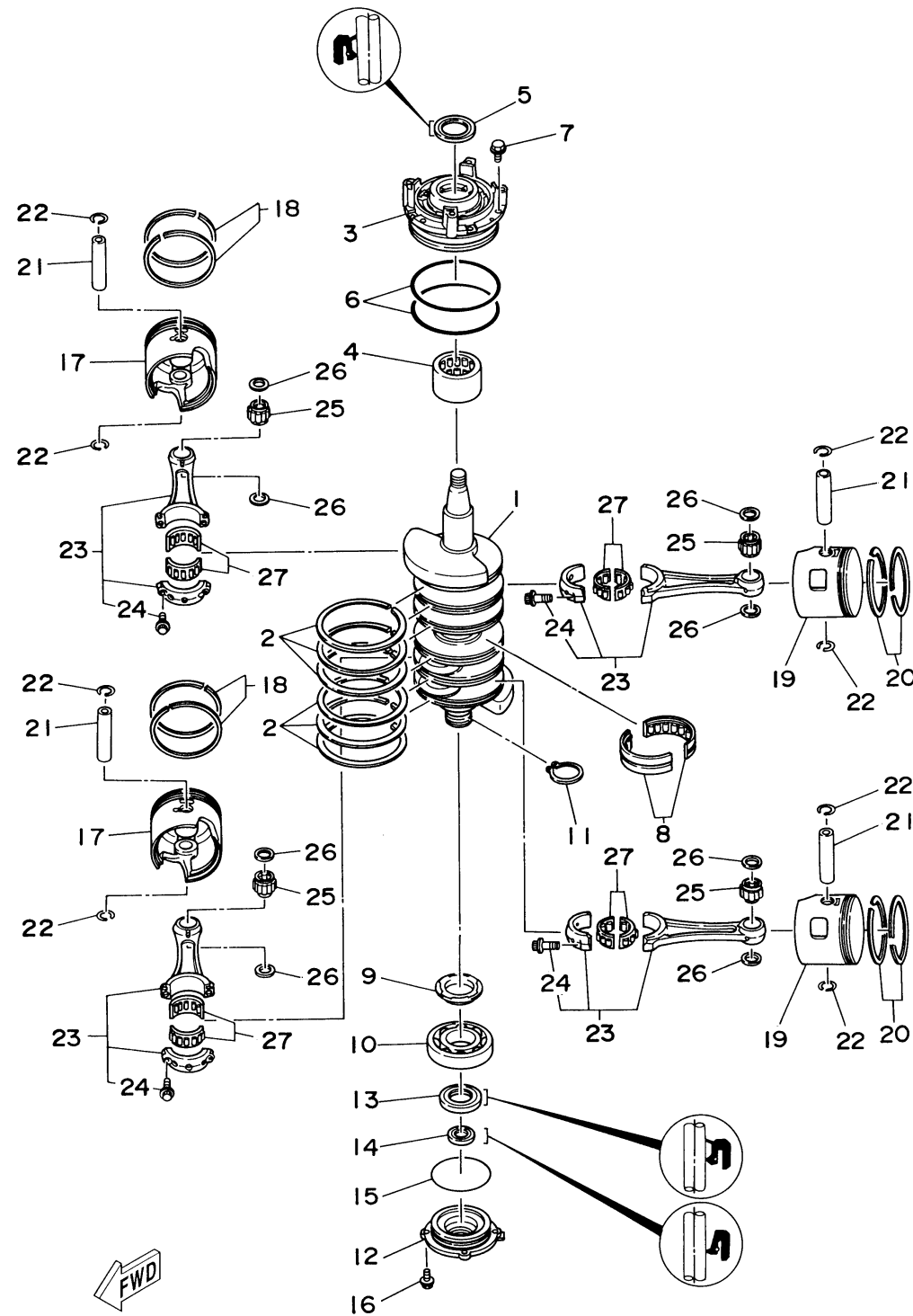

6N42100-4030

CRANKSHAFT PISTON

Ref No.	Part Number	Description	Qty	Remarks
18	64D-11604-02-00	PISTON RING SET (0.25MM O/S)	2	AP
18	64D-11605-02-00	PISTON RING SET (0.50MM O/S)	2	AP
19	6R5-11645-11-00	PISTON 2 (0.25MM O/S)	2	AP
19	6R5-11646-11-00	PISTON 2 (0.50MM O/S)	2	AP
19	6R5-11642-11-93	PISTON 2 (STD)	2	
20	64D-11603-02-00	PISTON RING SET (STD)	2	
20	64D-11604-02-00	PISTON RING SET (0.25MM O/S)	2	AP
20	64D-11605-02-00	PISTON RING SET (0.50MM O/S)	2	AP
21	6R5-11633-10-00	PIN, PISTON	4	
22	6R5-11634-10-00	CLIP, PISTON PIN	8	
23	6R5-11650-10-00	CONNECTING ROD ASSY	4	
24	90109-08022-00	. .BOLT	2	
25	93310-32337-00	BEARING	4	
26	90201-23M01-00	WASHER, PLATE	8	
27	93310-836U0-00	BEARING	4	

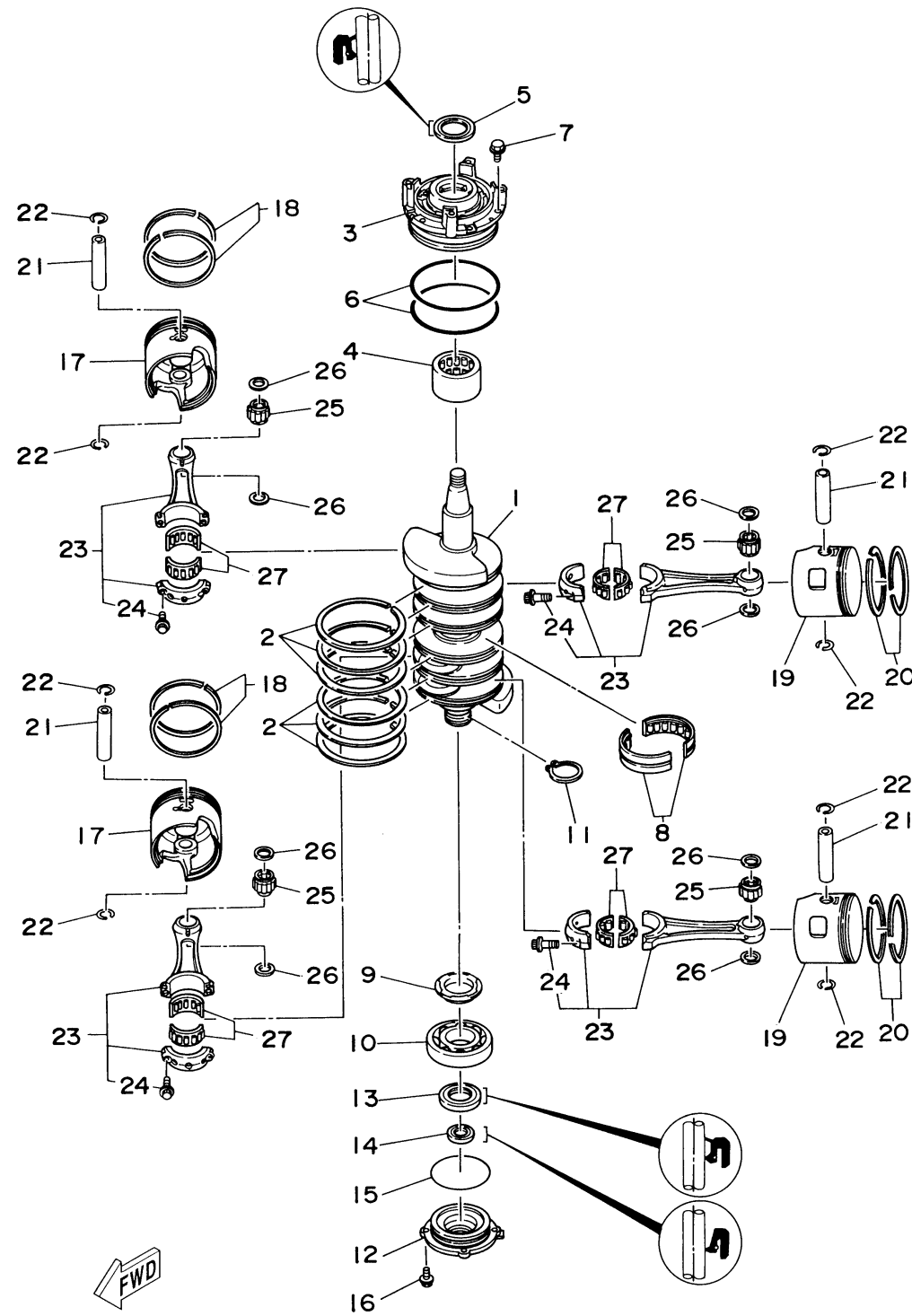

6N42100-4030