

CRANKSHAFT PISTON

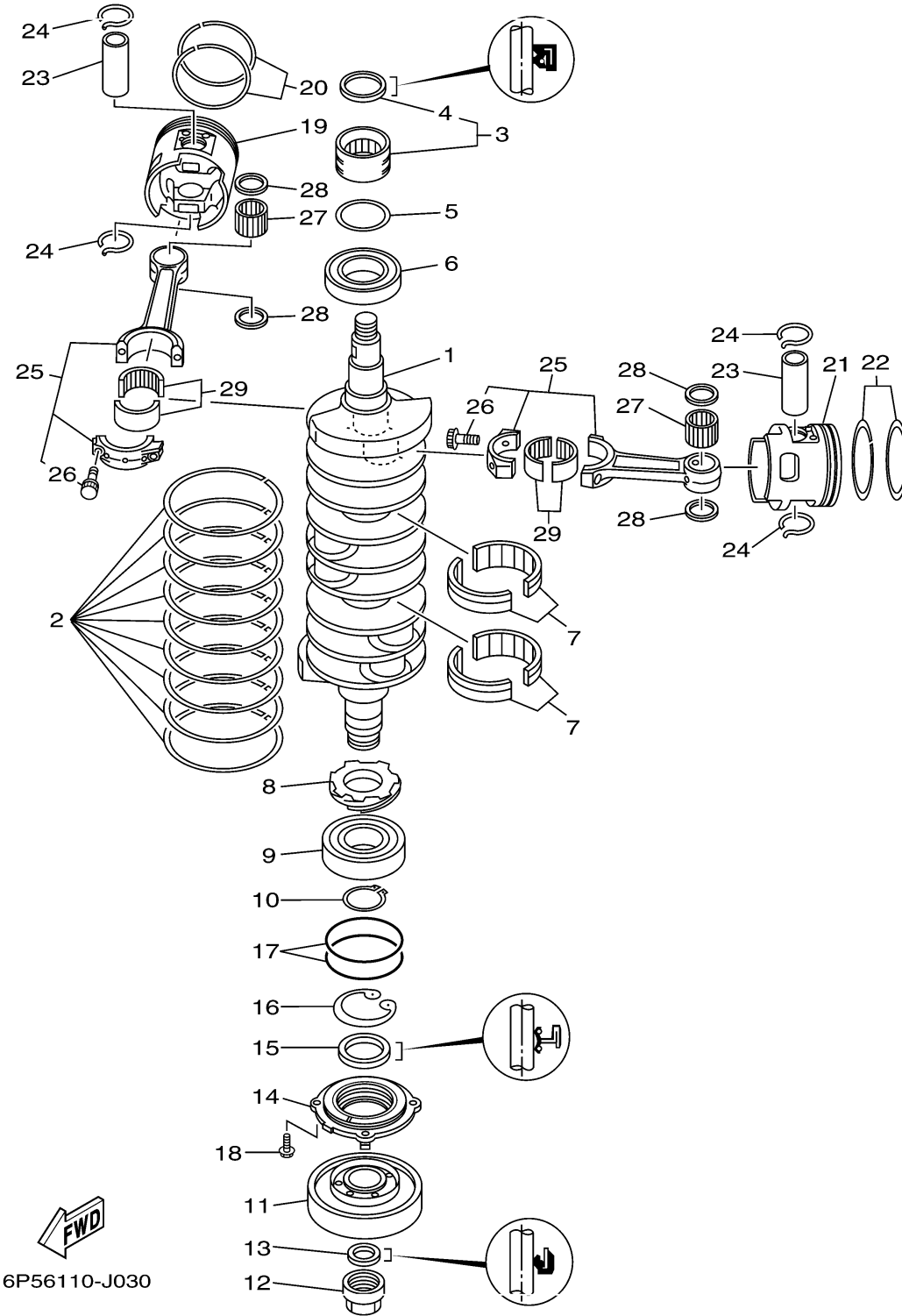

Ref No.	Part Number	Description	Qty	Remarks
1	6D0-11411-00-00	CRANKSHAFT	1	
2	61A-11447-00-00	SEAL, CRANK	9	
3	93311-940V0-00	BEARING	1	
4	93102-40M38-00	. OIL SEAL	1	
5	93210-54006-00	.O-RING	1	
6	93306-209U1-00	BEARING	1	
7	93310-959U0-00	BEARING	2	
8	61A-11536-00-00	GEAR, DRIVE	1	
9	93306-308U0-00	BEARING	1	
10	93410-40M03-00	CIRCLIP	1	
11	61A-11586-01-00	PULLEY, CRANKSHAFT BALANCE	1	
12	60V-11555-00-00	NUT, CRANKSHAFT 1	1	
13	93104-22M07-00	.OIL SEAL	1	
14	6D0-15359-00-94	HOUSING, OIL SEAL	1	
15	93103-40011-00	.OIL SEAL	1	
16	93420-61M07-00	CIRCLIP	1	
17	93210-85M32-00	O-RING	2	
18	97595-06420-00	BOLT, WITH WASHER	4	
19	6D0-11631-02-84	PISTON (STD)	3	
19	6D0-11635-02-00	PISTON (0.25MM O/S)	3	AP

CONTINUED ON NEXT FRAME >

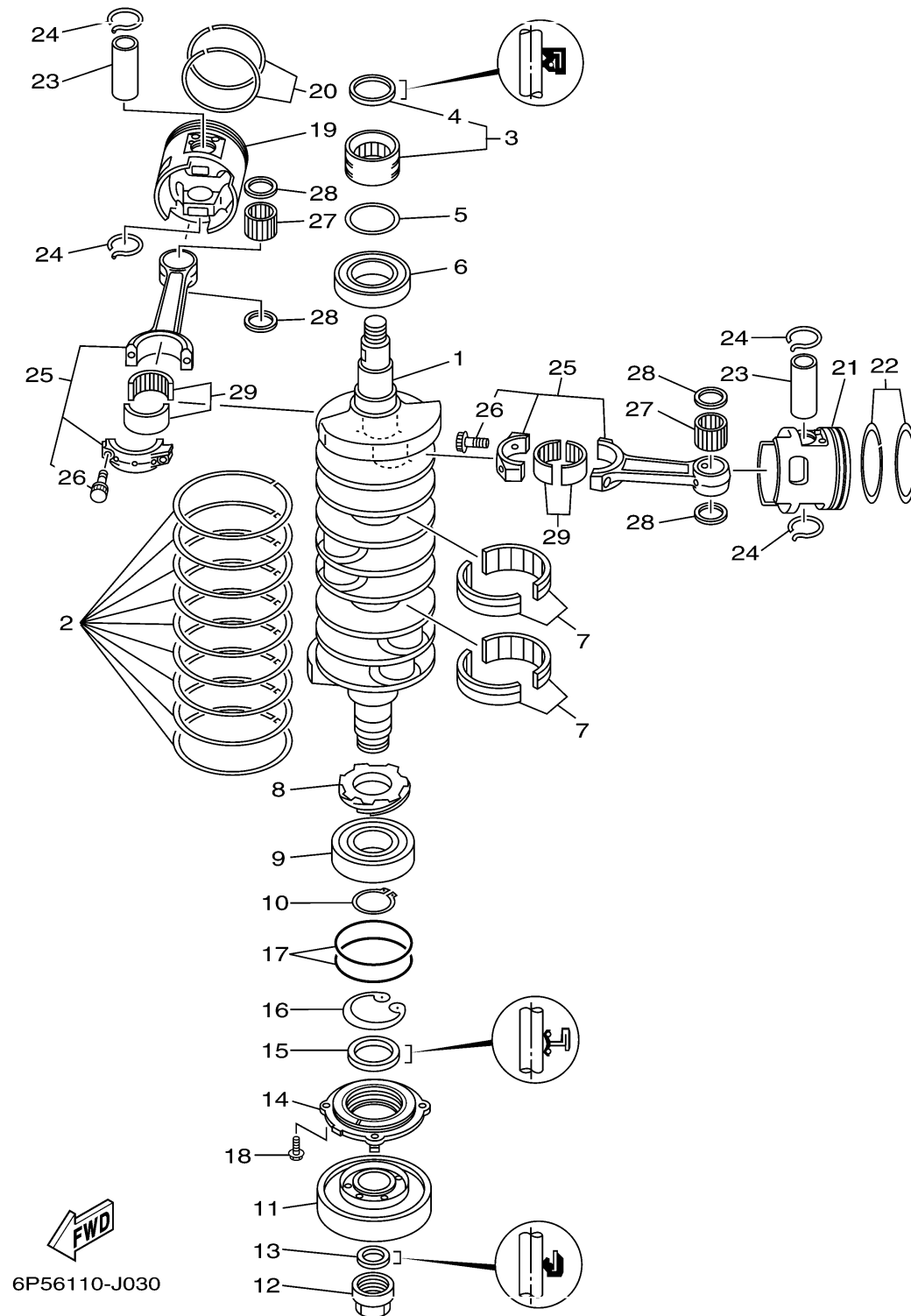

CRANKSHAFT PISTON

Ref No.	Part Number	Description	Qty	Remarks
19	6D0-11636-02-00	PISTON (0.50MM O/S)	3	AP
20	6D0-11603-01-00	PISTON RING SET (STD)	3	
20	6D0-11604-01-00	PISTON RING SET (0.25MM O/S)	3	AP
20	6D0-11605-01-00	PISTON RING SET (0.50MM O/S)	3	AP
21	6D0-11646-03-00	PISTON 2 (0.50MM O/S)	3	AP
21	6D0-11645-03-00	PISTON 2 (0.25MM O/S)	3	AP
21	6D0-11642-03-84	PISTON 2 (STD)	3	
22	6D0-11603-01-00	PISTON RING SET (STD)	3	
22	6D0-11604-01-00	PISTON RING SET (0.25MM O/S)	3	AP
22	6D0-11605-01-00	PISTON RING SET (0.50MM O/S)	3	AP
23	61A-11633-02-00	PIN, PISTON	6	
24	60X-11634-00-00	CLIP, PISTON PIN	12	
25	69L-11650-00-00	CONNECTING ROD ASSY	6	
26	90109-09001-00	..BOLT	2	
27	93310-32668-00	BEARING	6	
28	90201-26M03-00	WASHER, PLATE	12	
29	93310-84106-00	BEARING	6	