

LOWER CASING DRIVE 1

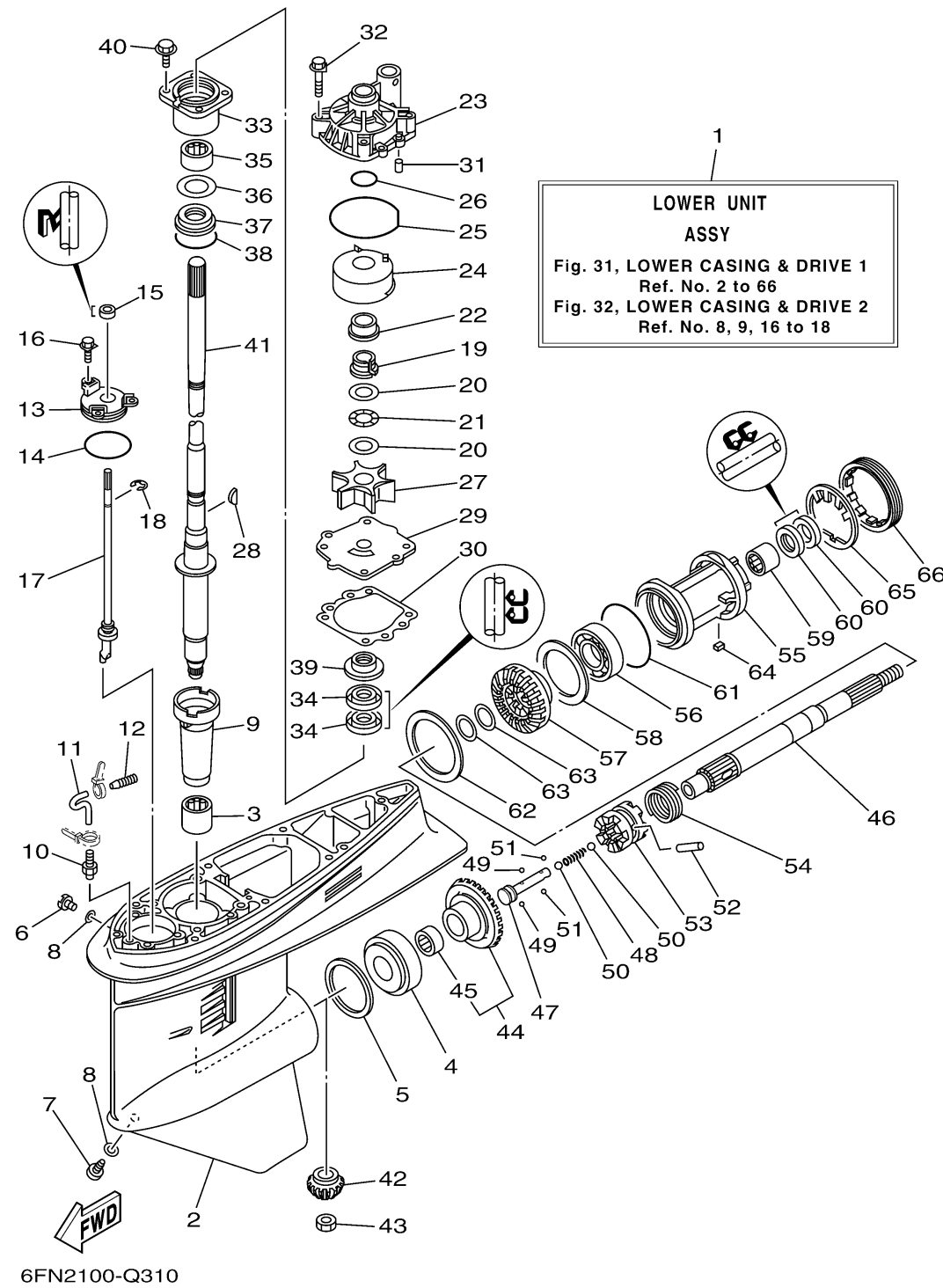

| Ref No. | Part Number | Description | Qty | Remarks |
|---------|-----------------|----------------------|-----|---------|
| 1 | 6FN-45300-00-NA | LOWER UNIT ASSY | 1 | |
| 2 | 6E5-45301-07-NA | CASING, LOWER | 1 | |
| 3 | 93315-628U9-00 | BEARING | 1 | |
| 4 | 93332-000U7-00 | BEARING | 1 | |
| 5 | 6E5-45567-10-00 | SHIM (T:0.12MM) | 1 | UR |
| 5 | 6E5-45567-01-00 | SHIM (T:0.10MM) | 1 | UR |
| 5 | 6E5-45567-20-00 | SHIM (T:0.15MM) | 1 | UR |
| 5 | 6E5-45567-60-00 | SHIM (T:0.50MM) | 1 | UR |
| 5 | 6E5-45567-50-00 | SHIM (T:0.40MM) | 1 | UR |
| 5 | 6E5-45567-30-00 | SHIM (T:0.18MM) | 1 | UR |
| 5 | 6E5-45567-40-00 | SHIM (T:0.30MM) | 1 | UR |
| 6 | 90340-08002-00 | PLUG, STRAIGHT SCREW | 1 | |
| 7 | 688-45341-10-00 | PLUG, DRAIN | 1 | |
| 8 | 90430-08003-00 | .GASKET | 2 | |
| 9 | 6E5-45536-00-00 | SLEEVE, DRIVE SHAFT | 1 | |
| 10 | 6E5-45378-00-00 | NIPPLE, HOSE | 1 | |
| 11 | 90445-07ME8-00 | HOSE (L80) | 1 | |
| 12 | 6E5-83558-10-00 | END, NIPPLE | 1 | |
| 13 | 6E5-45321-00-00 | PLATE | 1 | |
| 14 | 93210-58144-00 | .O-RING | 1 | |

CONTINUED ON NEXT FRAME >

LOWER CASING DRIVE 1

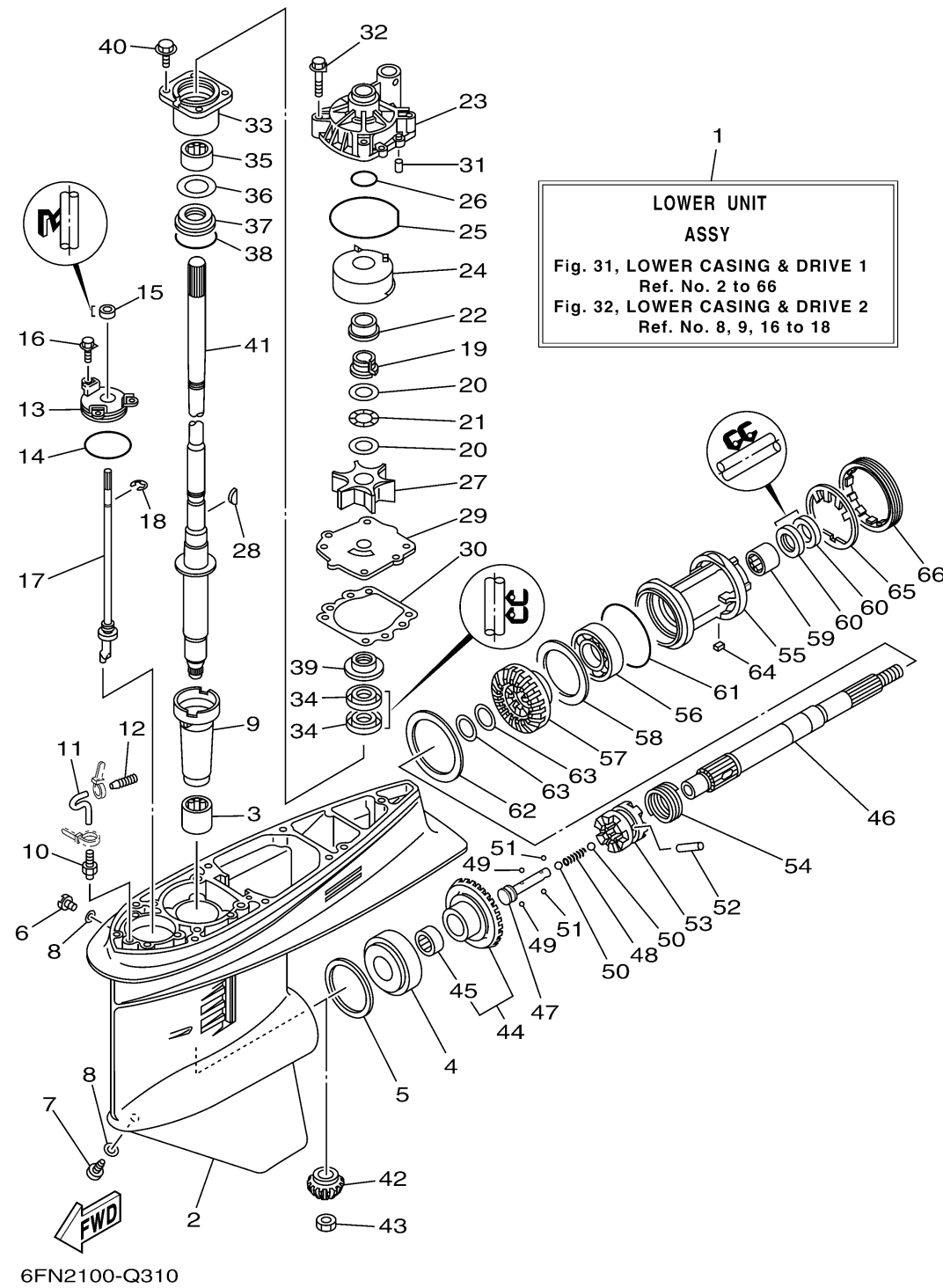

| Ref No. | Part Number | Description | Qty | Remarks |
|---------|-----------------|-------------------------|-----|---------|
| 15 | 93106-09014-00 | .OIL SEAL | 1 | |
| 16 | 90119-06M10-00 | BOLT, WITH WASHER | 3 | |
| 17 | 6E5-44150-03-00 | SHIFT CAM ASSY | 1 | |
| 18 | 99001-08600-00 | CIRCLIP | 1 | |
| 19 | 61A-45538-00-00 | SPACER 1 | 1 | |
| 20 | 90201-22M01-00 | WASHER, PLATE | 2 | |
| 21 | 90206-22M19-00 | WASHER, WAVE | 1 | |
| 22 | 61A-45527-00-00 | COLLAR, DRIVE SHAFT | 1 | |
| 23 | 61A-44311-01-00 | HOUSING, WATER PUMP | 1 | |
| 24 | 61A-44322-02-00 | .INSERT, CARTRIDGE | 1 | |
| 25 | 93210-86M38-00 | .O-RING | 1 | |
| 26 | 93210-37160-00 | .O-RING | 1 | |
| 27 | 6E5-44352-01-00 | .IMPELLER | 1 | |
| 28 | 90280-04M05-00 | .KEY, WOODRUFF | 1 | |
| 29 | 6EK-44323-00-00 | .OUTER PLATE, CARTRIDGE | 1 | |
| 30 | 6E5-44315-A0-00 | .GASKET, WATER PUMP | 1 | |
| 31 | 93606-12019-00 | PIN, DOWEL | 2 | |
| 32 | 90119-08M14-00 | BOLT, WITH WASHER | 4 | |
| 33 | 6E5-45331-00-9S | HOUSING, BEARING | 1 | |
| 34 | 93101-28M16-00 | OIL SEAL | 2 | |

CONTINUED ON NEXT FRAME >

LOWER CASING DRIVE 1

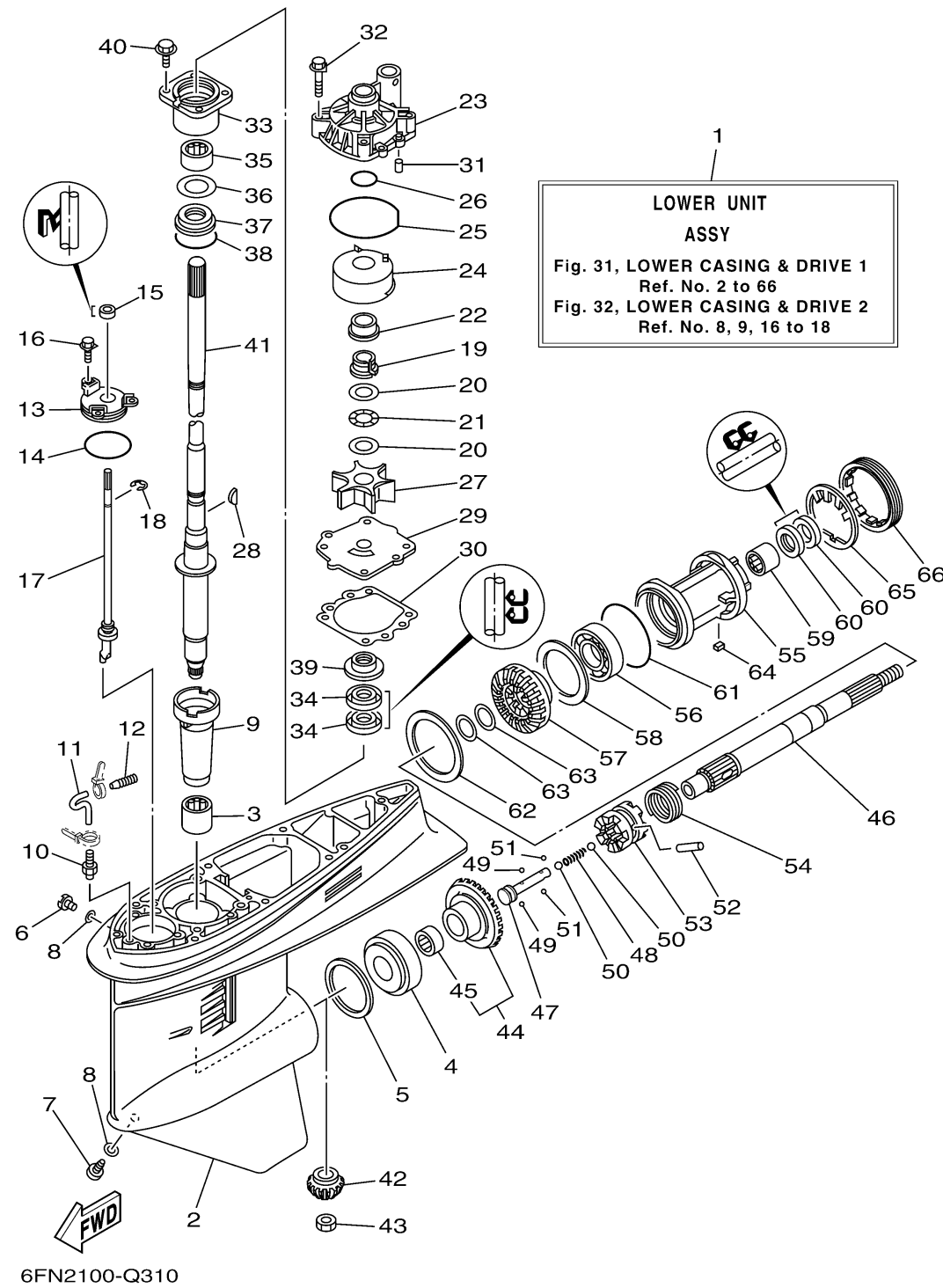

| Ref No. | Part Number | Description | Qty | Remarks |
|---------|-----------------|---------------------|-----|---------|
| 35 | 93317-330U2-00 | BEARING | 1 | |
| 36 | 6E5-45587-01-00 | SHIM (T:0.10MM) | 1 | UR |
| 36 | 6E5-45587-10-00 | SHIM (T:0.12MM) | 1 | UR |
| 36 | 6E5-45587-20-00 | SHIM (T:0.15MM) | 1 | UR |
| 36 | 6E5-45587-30-00 | SHIM (T:0.18MM) | 1 | UR |
| 36 | 6E5-45587-40-00 | SHIM (T:0.30MM) | 1 | UR |
| 36 | 6E5-45587-50-00 | SHIM (T:0.40MM) | 1 | UR |
| 36 | 6E5-45587-60-00 | SHIM (T:0.50MM) | 1 | UR |
| 37 | 93341-930V2-00 | BEARING | 1 | |
| 38 | 93210-55M14-00 | .O-RING | 1 | |
| 39 | 6E5-45344-00-00 | COVER, OIL SEAL | 1 | |
| 40 | 97595-08525-00 | BOLT, WITH WASHER | 4 | |
| 41 | 6EK-45501-00-00 | DRIVE SHAFT COMP. | 1 | |
| 42 | 6EM-45551-00-00 | PINION (13T) | 1 | |
| 43 | 90170-16M01-00 | NUT | 1 | |
| 44 | 6EM-45560-00-00 | GEAR 1 (28T) | 1 | |
| 45 | 93315-425U7-00 | .BEARING | 1 | |
| 46 | 6E5-45611-01-00 | SHAFT, PROPELLER | 1 | |
| 47 | 6E5-45634-02-00 | SLIDE, SHIFT | 1 | |
| 48 | 90501-16M37-00 | SPRING, COMPRESSION | 1 | |

CONTINUED ON NEXT FRAME >

LOWER CASING DRIVE 1

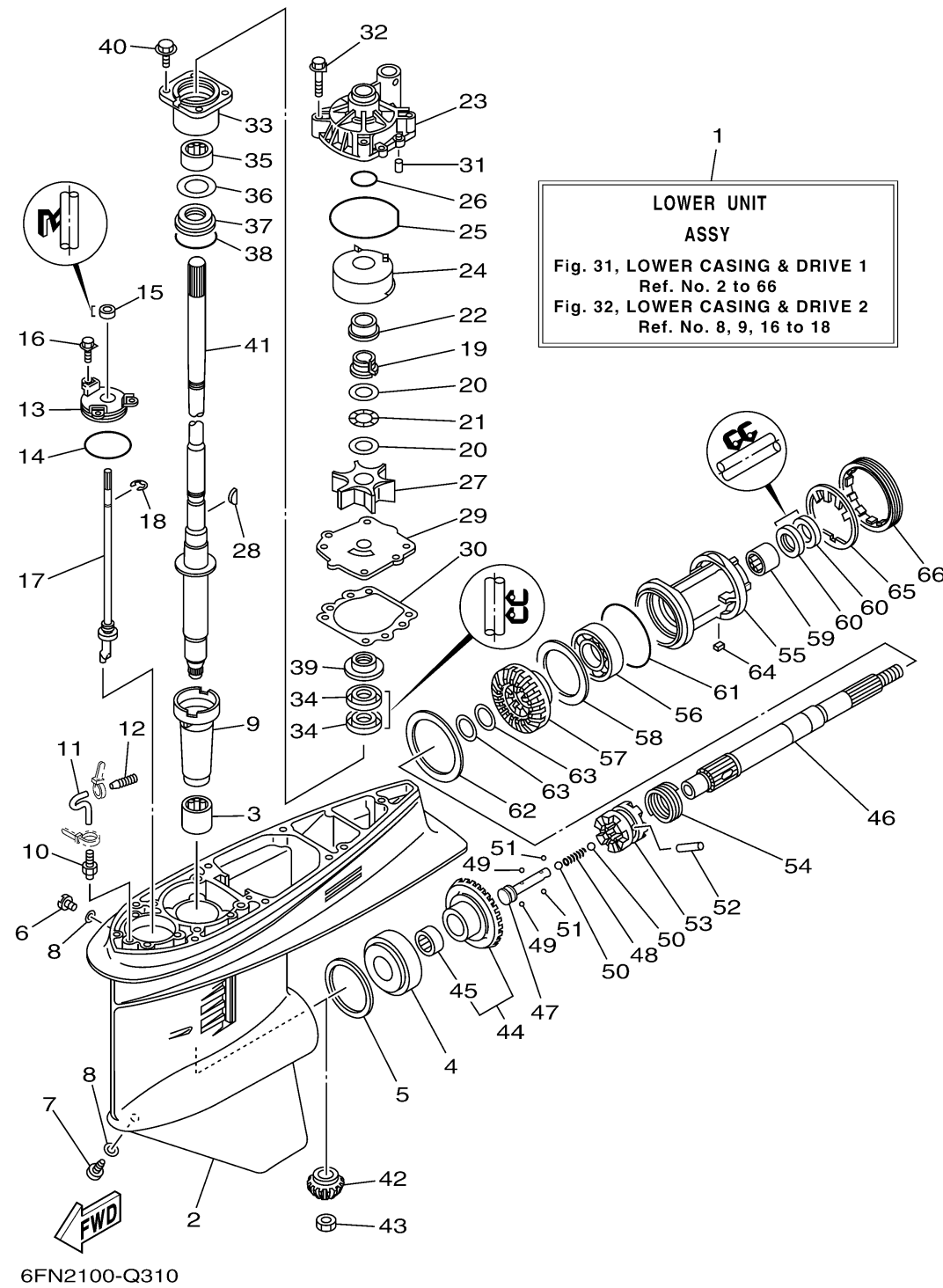

| Ref No. | Part Number | Description | Qty | Remarks |
|---------|-----------------|------------------|-----|---------|
| 49 | 93507-32009-00 | ..BALL | 2 | |
| 50 | 93511-32017-00 | BALL | 2 | |
| 51 | 93503-16003-00 | BALL | 2 | |
| 52 | 90250-08M07-00 | PIN, STRAIGHT | 1 | |
| 53 | 68V-45631-01-00 | CLUTCH, DOG | 1 | |
| 54 | 6E5-45633-01-00 | RING, CROSS PIN | 1 | |
| 55 | 6E5-45332-00-CA | HOUSING, BEARING | 1 | |
| 56 | 93306-208U0-00 | BEARING | 1 | |
| 57 | 68V-45571-00-00 | GEAR 2 (28T) | 1 | |
| 58 | 6E5-45576-00-00 | WASHER, THRUST 2 | 1 | |
| 59 | 93315-430U8-00 | BEARING | 1 | |
| 60 | 93101-30M17-00 | .OIL SEAL | 2 | |
| 61 | 93210-86M39-00 | .O-RING | 1 | |
| 62 | 6L6-45577-00-00 | SHIM (T:0.10MM) | 1 | UR |
| 62 | 6L6-45577-10-00 | SHIM (T:0.12MM) | 1 | UR |
| 62 | 6L6-45577-20-00 | SHIM (T:0.15MM) | 1 | UR |
| 62 | 6L6-45577-30-00 | SHIM (T:0.18MM) | 1 | UR |
| 62 | 6L6-45577-40-00 | SHIM (T:0.30MM) | 1 | UR |
| 62 | 6L6-45577-50-00 | SHIM (T:0.40MM) | 1 | UR |
| 62 | 6L6-45577-60-00 | SHIM (T:0.50MM) | 1 | UR |

CONTINUED ON NEXT FRAME >

LOWER CASING DRIVE 1

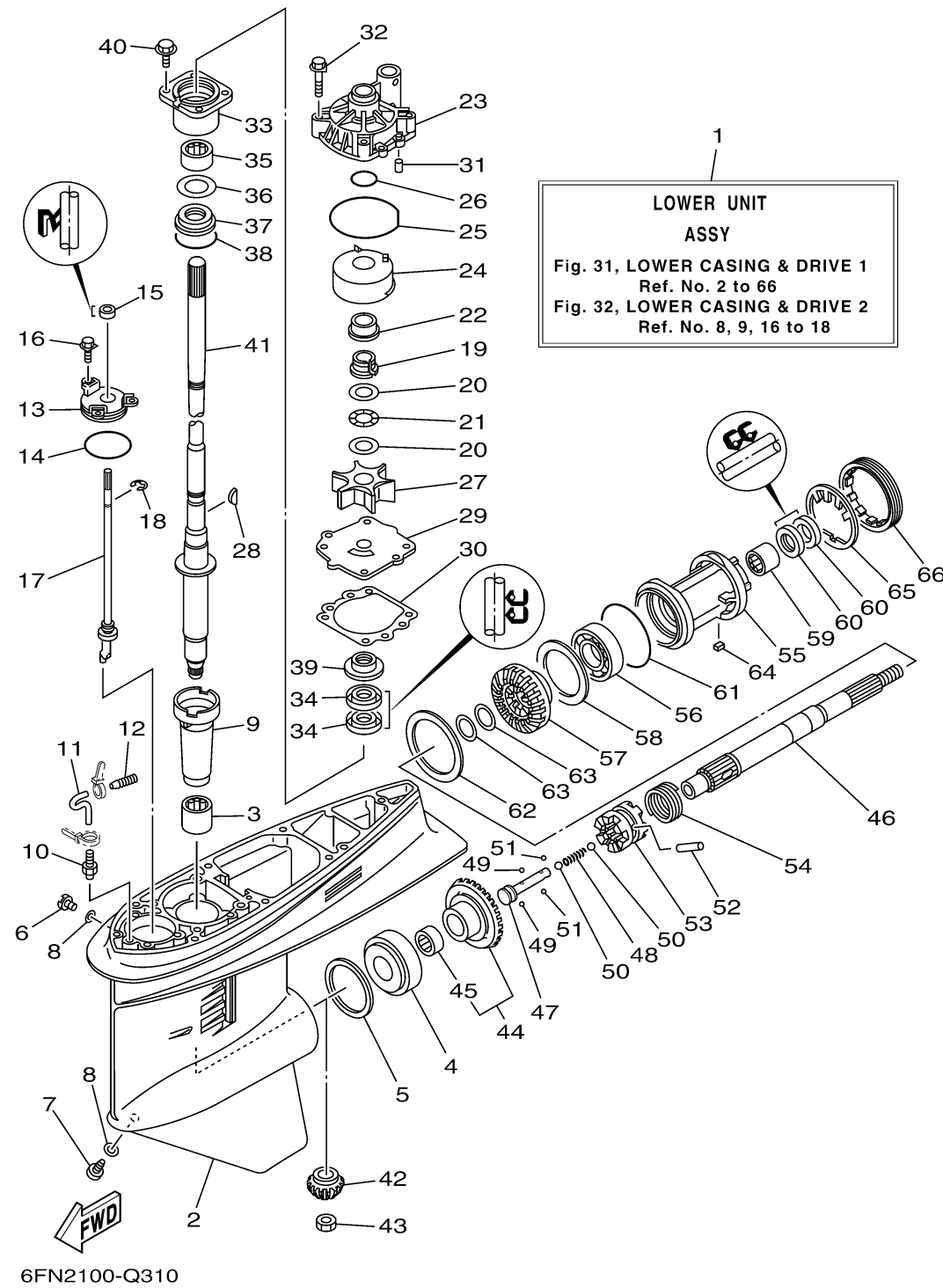

| Ref No. | Part Number | Description | Qty | Remarks |
|---------|-----------------|---------------|-----|---------|
| 63 | 90201-30M92-00 | WASHER, PLATE | 2 | |
| 64 | 90282-04010-00 | KEY, STRAIGHT | 1 | |
| 65 | 688-45383-02-00 | WASHER, CLAW | 1 | |
| 66 | 688-45384-02-00 | NUT | 1 | |