

# HARNESS (TWIN)

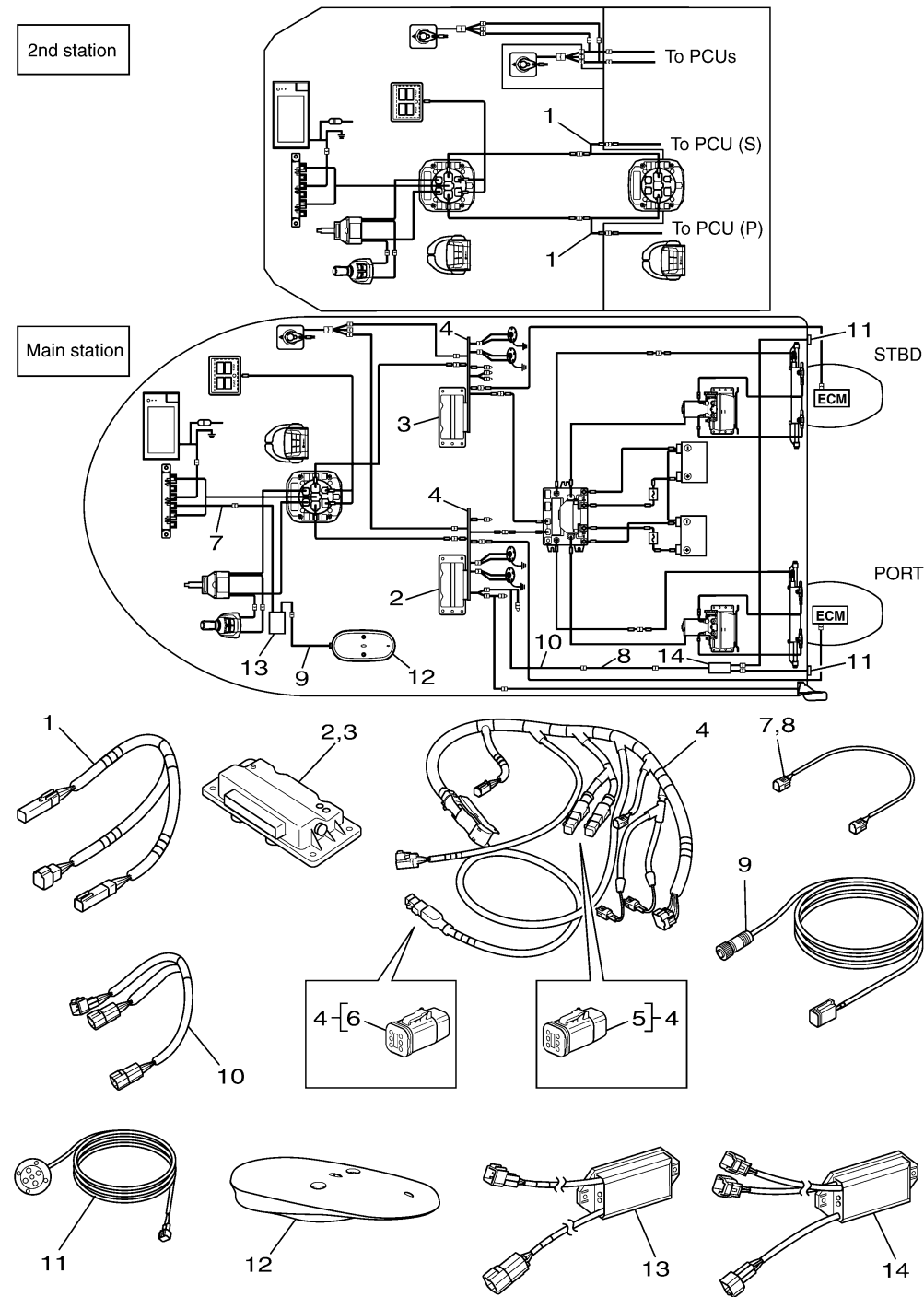

6ES3100-R040

\*1 : FOR MAIN STATION PARTS  
\*2 : FOR 2ND STATION PARTS

Ref No.	Part Number	Description	Qty	Remarks
1	6ES-8258A-80-00	"T" HARNESS, 2ND STATION	2	2ND STATION
2	6ES-85590-10-00	PCU (TWIN/PORT)	1	CONTACT MARINE SERVICE DEPT
3	6ES-85590-20-00	PCU (TWIN/STBD)	1	CONTACT MARINE SERVICE DEPT
4	6ES-8258A-00-00	PCU HARNESS	2	MAIN STATION
5	6ES-82582-00-00	. CAP 1	2	
6	6ES-82585-00-00	. CAP 2	1	
7	6Y8-82521-11-00	2FT PIGTAIL BUS	1	MAIN STATION
8	6Y8-82521-11-00	2FT PIGTAIL BUS	1	MAIN STATION
9	6ES-82718-00-00	RESISTOR HARNESS	1	MAIN STATION
10	6ES-82590-C0-00	PROP. LIGHT INTERFACE HARNESS	1	MAIN STATION
11	6ES-83720-00-00	L.E.D ASS'Y	2	MAIN STATION
12	6ES-88107-00-00	GPS ANTENNA	1	CONTACT MARINE SERVICE DEPT
13	6ES-8A2D0-10-00	GPS GATEWAY	1	MAIN STATION
14	6ES-8A2D0-00-00	PROP. LIGHT INTERFACE	1	MAIN STATION