

OIL PAN

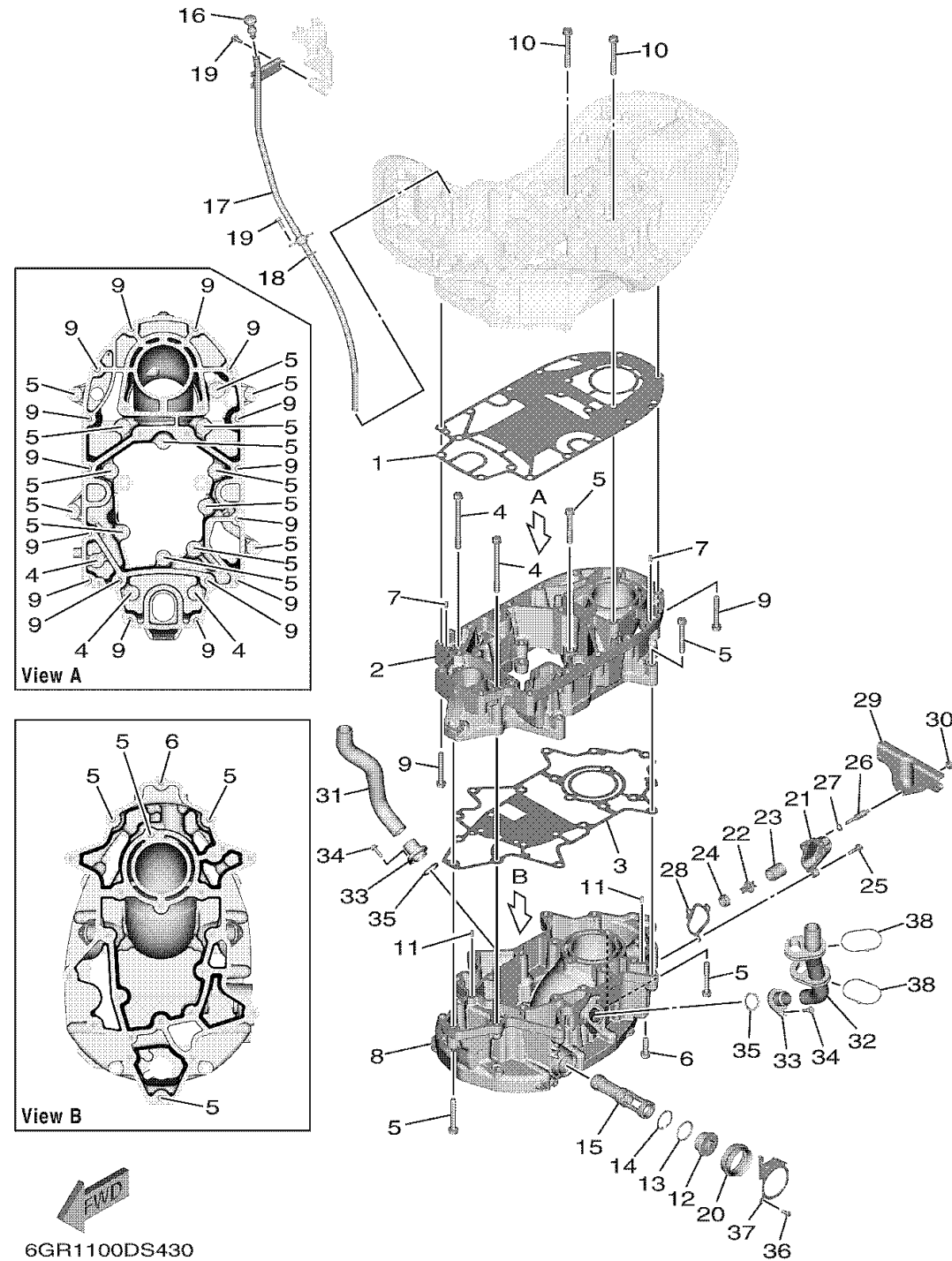

Ref No.	Part Number	Description	Qty	Remarks
1	6GR-15312-00-00	.GASKET, OIL PAN	1	
2	6GR-1531B-00-00	OIL PAN 2	1	
3	6GR-1531C-00-00	.GASKET, OIL PAN 2	1	
4	90119-10M14-00	BOLT, WITH WASHER	3	
5	97E75-10570-00	BOLT, HEXAGON W/W DEEP RECESS	18	
6	90119-10040-00	BOLT, WITH WASHER	1	
7	93606-12019-00	PIN, DOWEL	2	
8	6GR-15311-00-00	OIL PAN	1	
9	97E75-10570-00	BOLT, HEXAGON W/W DEEP RECESS	16	
10	97E75-10580-00	BOLT, HEXAGON W/W DEEP RECESS	4	
11	93606-12019-00	PIN, DOWEL	2	
12	6GR-15351-00-00	PLUG,DRAIN 1	1	
13	93210-34633-00	.O-RING	1	
14	93420-36M01-00	CIRCLIP	1	
15	6GR-13411-00-00	STRAINER, OIL	1	
16	6GR-15362-00-00	PLUG, OIL LEVEL	1	
17	6GR-15377-00-00	GUIDE, INLET	1	
18	93210-19MJ3-00	.O-RING	1	
19	95D95-06016-00	BOLT, FLANGE DEEP RECESS	3	
20	6GR-15316-00-00	DAMPER 1	1	

CONTINUED ON NEXT FRAME >

OIL PAN

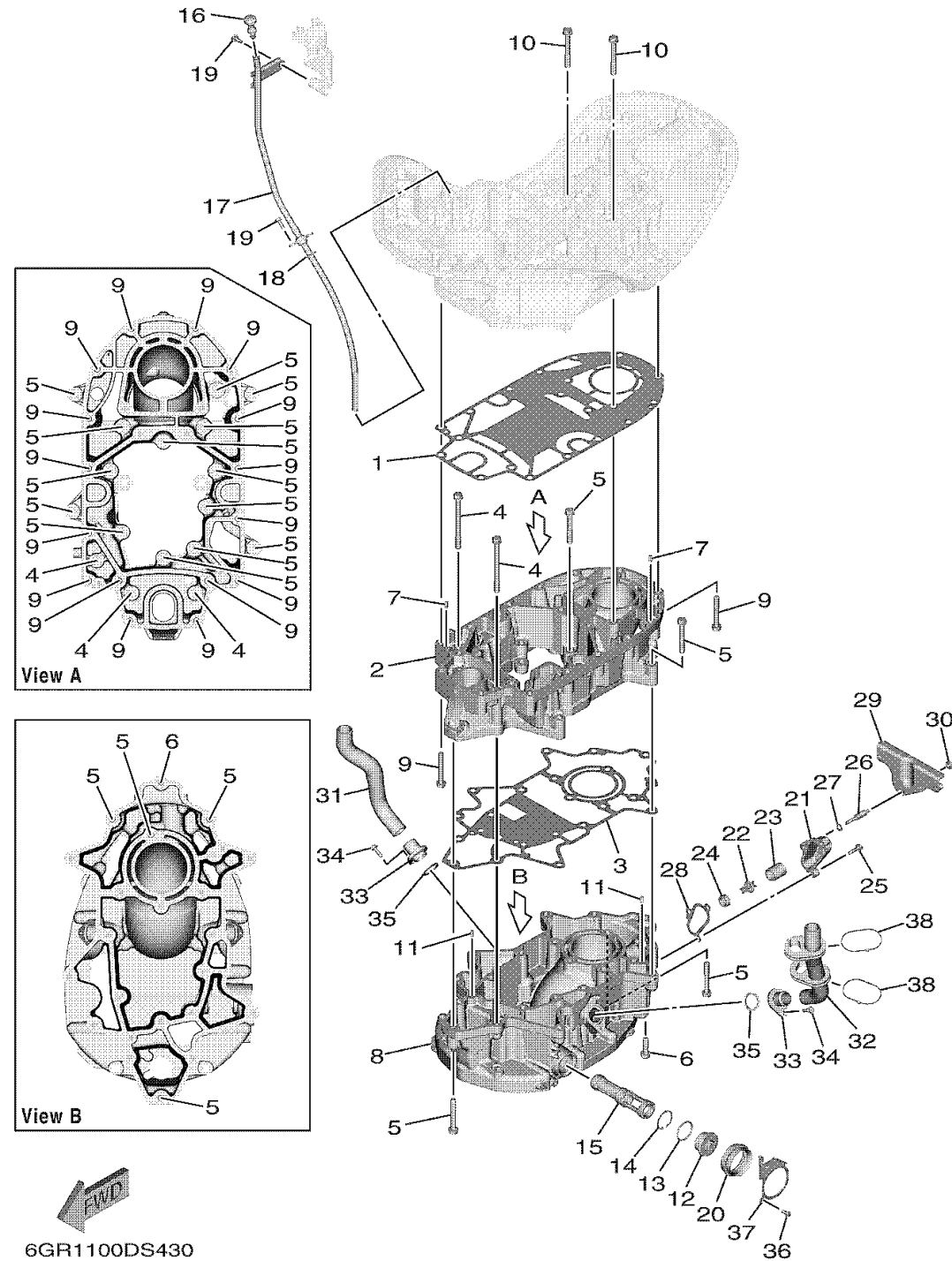

Ref No.	Part Number	Description	Qty	Remarks
21	6EK-1246A-00-9S	COVER 1	1	
22	6G5-12416-00-00	VALVE, PRESSURE CONTROL	1	
23	90501-200A2-00	SPRING, COMPRESSION	1	
24	90480-20M05-00	GROMMET	1	
25	95D95-06025-00	BOLT, FLANGE DEEP RECESS	1	
26	6GR-42742-00-00	BOLT	2	
27	92995-06200-00	WASHER	2	
28	6EK-12435-A0-00	.GASKET	1	
29	6GR-42776-00-00	STAY, APRON 3	1	
30	90179-06M28-00	NUT	2	
31	6GR-1243F-00-00	HOSE,3	1	
32	6GR-1257A-00-00	HOSE ASSY 1	1	
33	6GR-12581-00-00	JOINT, HOSE 1	2	
34	95D95-06020-00	BOLT, FLANGE DEEP RECESS	2	
35	6GR-44366-00-00	.DAMPER, WATER SEAL 2	2	
36	97D95-06012-00	BOLT, HEXAGON DEEP RECESS	1	
37	6GR-45152-00-00	COVER, UPPER CASING 2	1	
38	90464-66001-00	CLAMP	2	