

## BRACKET 2

| Ref No. | Part Number     | Description                 | Qty | Remarks |
|---------|-----------------|-----------------------------|-----|---------|
| 1       | 6GR-43341-00-00 | COVER, SWIVEL SODE 1        | 1   |         |
| 2       | 6GR-43342-00-00 | COVER, SWIVEL SODE 2        | 1   |         |
| 3       | 90119-08176-00  | BOLT, WITH WASHER           | 8   |         |
| 4       | 6GR-W436G-00-8D | SBW SIDE COVER ASSY         | 2   | GRAY    |
| 4       | 6GR-W436G-00-CE | SBW SIDE COVER ASSY         | 0   | WHITE   |
| 4       | 6GR-43679-00-00 | COVER                       | 0   |         |
| 5       | 6DA-42697-00-00 | ..TUNING FORK MARK          | 1   |         |
| 6       | 90111-06144-00  | BOLT, HEXAGON SOCKET BUTTON | 6   |         |
| 7       | 6GR-43318-00-8D | COVER                       | 1   | GRAY    |
| 7       | 6GR-43318-00-CE | COVER                       | 0   | WHITE   |
| 7       | 6GR-43318-00-00 | COVER                       | 0   |         |
| 8       | 90111-06144-00  | BOLT, HEXAGON SOCKET BUTTON | 4   |         |
| 9       | 6GR-24864-00-00 | TUBE                        | 1   |         |
| 10      | 90465-11M10-00  | CLAMP                       | 5   |         |
| 11      | 90462-10033-00  | CLAMP                       | 2   |         |
| 12      | 95D95-06012-00  | BOLT, FLANGE DEEP RECESS    | 2   |         |
| 13      | 6GR-85887-00-00 | SENSOR ANGLE                | 1   |         |
| 14      | 93210-17MF9-00  | O-RING                      | 1   |         |
| 15      | 97595-05516-00  | BOLT, WITH WASHER           | 2   |         |
| 16      | 6GR-82553-00-00 | EXTENSION, WIRE LEAD        | 1   |         |

CONTINUED ON NEXT FRAME >

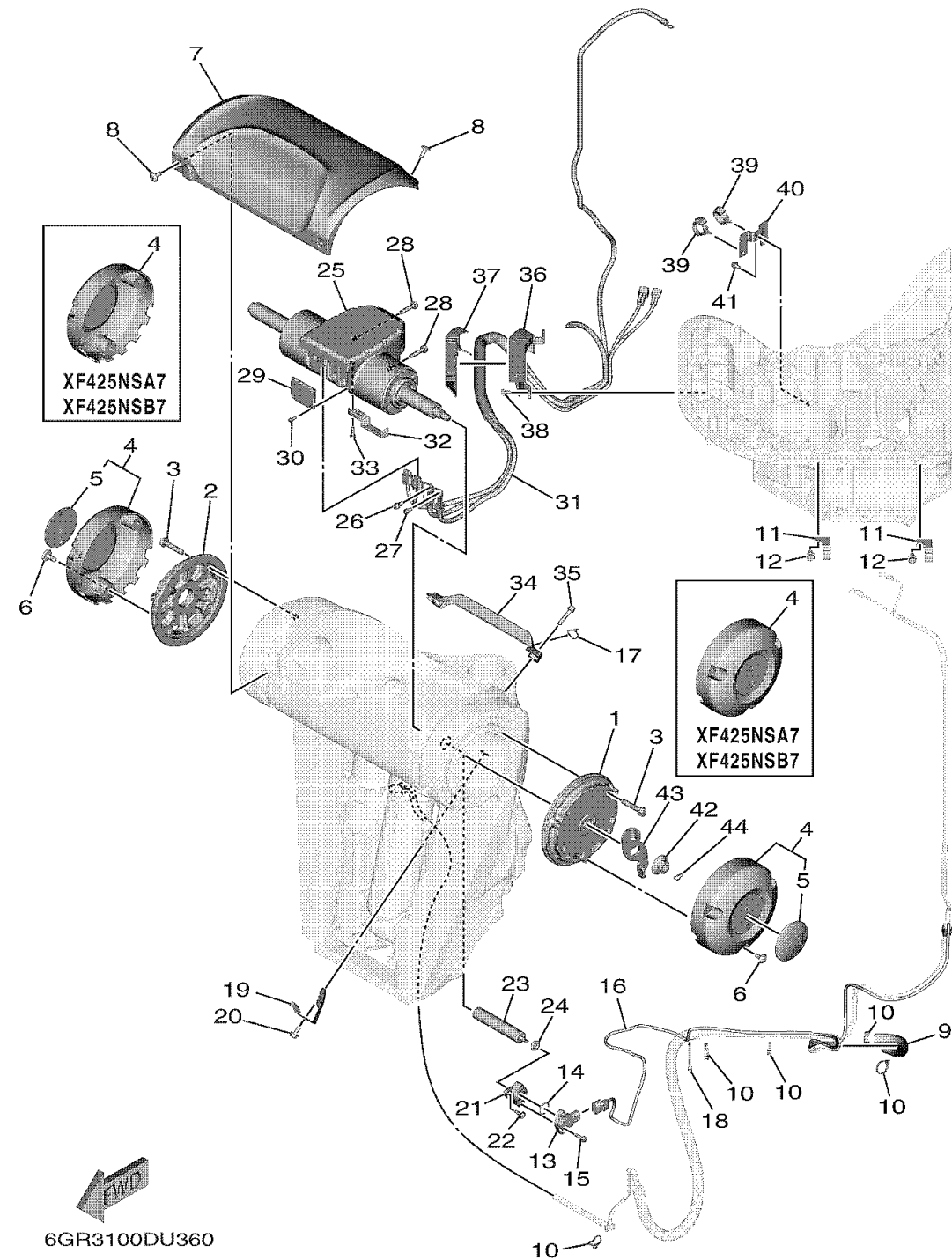

## BRACKET 2

| Ref No. | Part Number     | Description                  | Qty | Remarks |
|---------|-----------------|------------------------------|-----|---------|
| 17      | 90465-11M10-00  | CLAMP                        | 1   |         |
| 18      | 90464-55002-00  | CLAMP                        | 1   |         |
| 19      | 6GR-4381J-00-00 | PLATE                        | 1   |         |
| 20      | 95D95-06012-00  | BOLT, FLANGE DEEP RECESS     | 1   |         |
| 21      | 6GR-4382A-00-00 | ADAPTOR 1                    | 1   |         |
| 22      | 90149-05044-00  | SCREW                        | 2   |         |
| 23      | 6GR-43126-00-00 | PIN, UPPER SHOCK MOUNT       | 1   |         |
| 24      | 93210-06ME6-00  | O-RING                       | 1   |         |
| 25      | 6GR-42401-01-00 | POWER STEERING CYLINDER ASSY | 1   |         |
| 26      | 6GR-44331-00-00 | BOLT, 1                      | 1   |         |
| 27      | 6GR-44332-00-00 | BOLT, 2                      | 1   |         |
| 28      | 97580-08535-00  | BOLT, WITH WASHER            | 4   |         |
| 29      | 6GR-42134-00-00 | COVER                        | 1   |         |
| 30      | 91380-04010-00  | BOLT                         | 4   |         |
| 31      | 6GR-438A0-01-00 | STEERING, WIRE HARNESS ASSY  | 1   |         |
| 32      | 6GR-48538-00-00 | CLAMP, CABLE 1               | 1   |         |
| 33      | 97D95-06018-00  | BOLT, HEXAGON DEEP RECESS    | 2   |         |
| 34      | 6GR-47716-00-00 | COVER                        | 1   |         |
| 35      | 90110-06191-00  | BOLT, HEXAGON SOCKET HEAD    | 2   |         |
| 36      | 6GR-43121-00-00 | PROTECTOR                    | 1   |         |

CONTINUED ON NEXT FRAME >

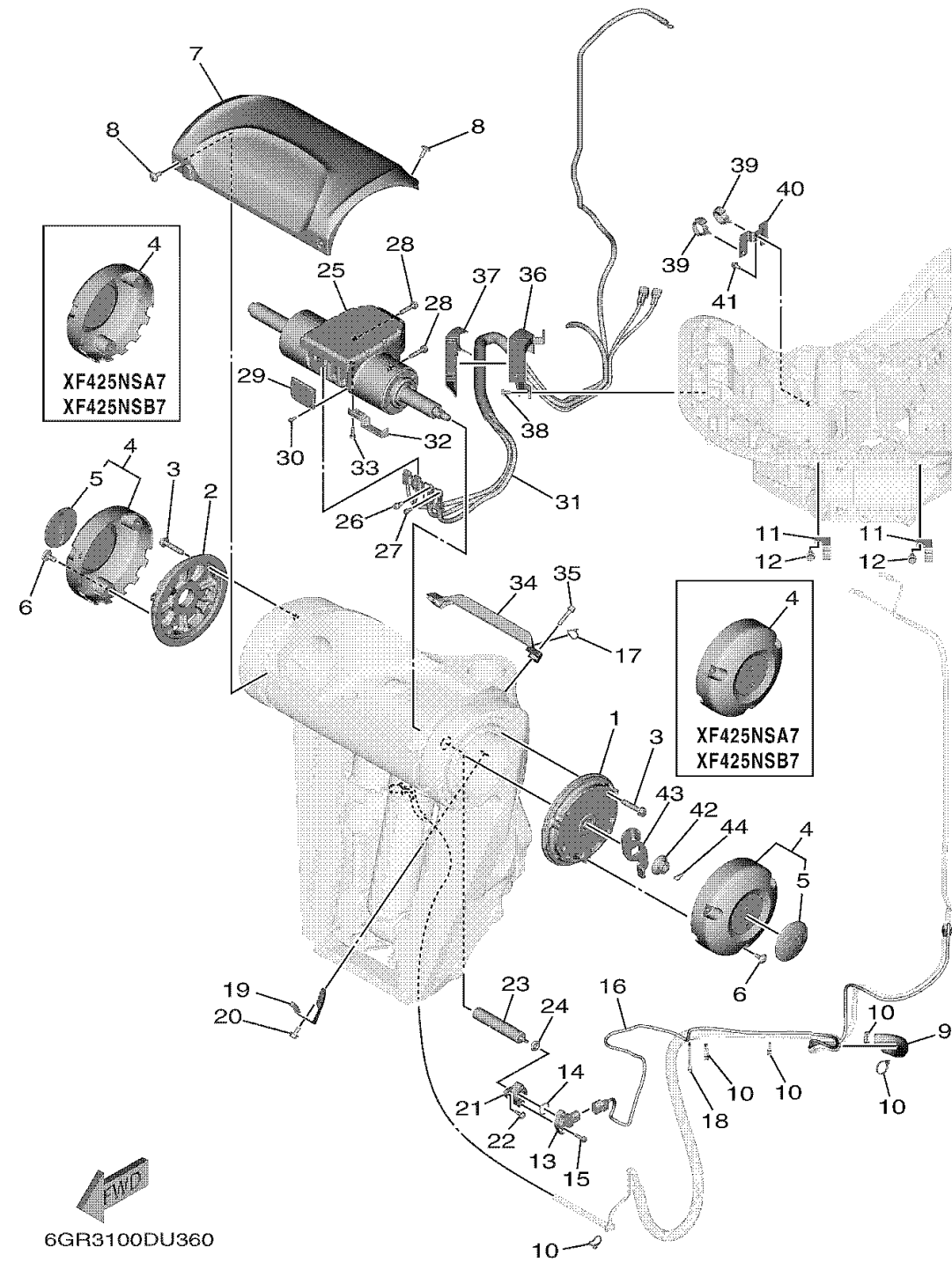

## BRACKET 2

| Ref No. | Part Number     | Description              | Qty | Remarks |
|---------|-----------------|--------------------------|-----|---------|
| 37      | 6GR-47445-00-00 | PROTECTOR                | 1   |         |
| 38      | 95D95-06012-00  | BOLT, FLANGE DEEP RECESS | 2   |         |
| 39      | 90464-12183-00  | CLAMP                    | 2   |         |
| 40      | 6GR-48539-00-00 | CLAMP, CABLE 2           | 1   |         |
| 41      | 95D95-06012-00  | BOLT, FLANGE DEEP RECESS | 1   |         |
| 42      | 90179-14007-00  | NUT                      | 1   |         |
| 43      | 6GR-43378-00-00 | WASHER                   | 1   |         |
| 44      | 91490-20025-00  | PIN. COTTER              | 1   |         |