

BRACKET 2

Ref No.	Part Number	Description	Qty	Remarks
1	6GR-43341-00-00	COVER, SWIVEL SODE 1	1	
2	6GR-43342-00-00	COVER, SWIVEL SODE 2	1	
3	90119-08176-00	BOLT, WITH WASHER	8	
4	6GR-W436G-00-8D	SBW SIDE COVER ASSY	2	GRAY
4	6GR-W436G-00-CE	SBW SIDE COVER ASSY	0	WHITE
4	6GR-43679-00-00	COVER	0	
5	6DA-42697-00-00	..TUNING FORK MARK	1	
6	90111-06144-00	BOLT, HEXAGON SOCKET BUTTON	6	
7	6GR-43318-00-8D	COVER	1	GRAY
7	6GR-43318-00-CE	COVER	0	WHITE
7	6GR-43318-00-00	COVER	0	
8	90111-06144-00	BOLT, HEXAGON SOCKET BUTTON	4	
9	6GR-24864-00-00	TUBE	1	
10	90465-11M10-00	CLAMP	3	*PART REVISION
11	90462-10033-00	CLAMP	2	
12	95D95-06012-00	BOLT, FLANGE DEEP RECESS	2	
13	6GR-85887-00-00	SENSOR ANGLE	1	
14	93210-17MF9-00	O-RING	1	
15	97595-05516-00	BOLT, WITH WASHER	2	
16	6GR-82553-00-00	EXTENSION, WIRE LEAD	1	

CONTINUED ON NEXT FRAME >

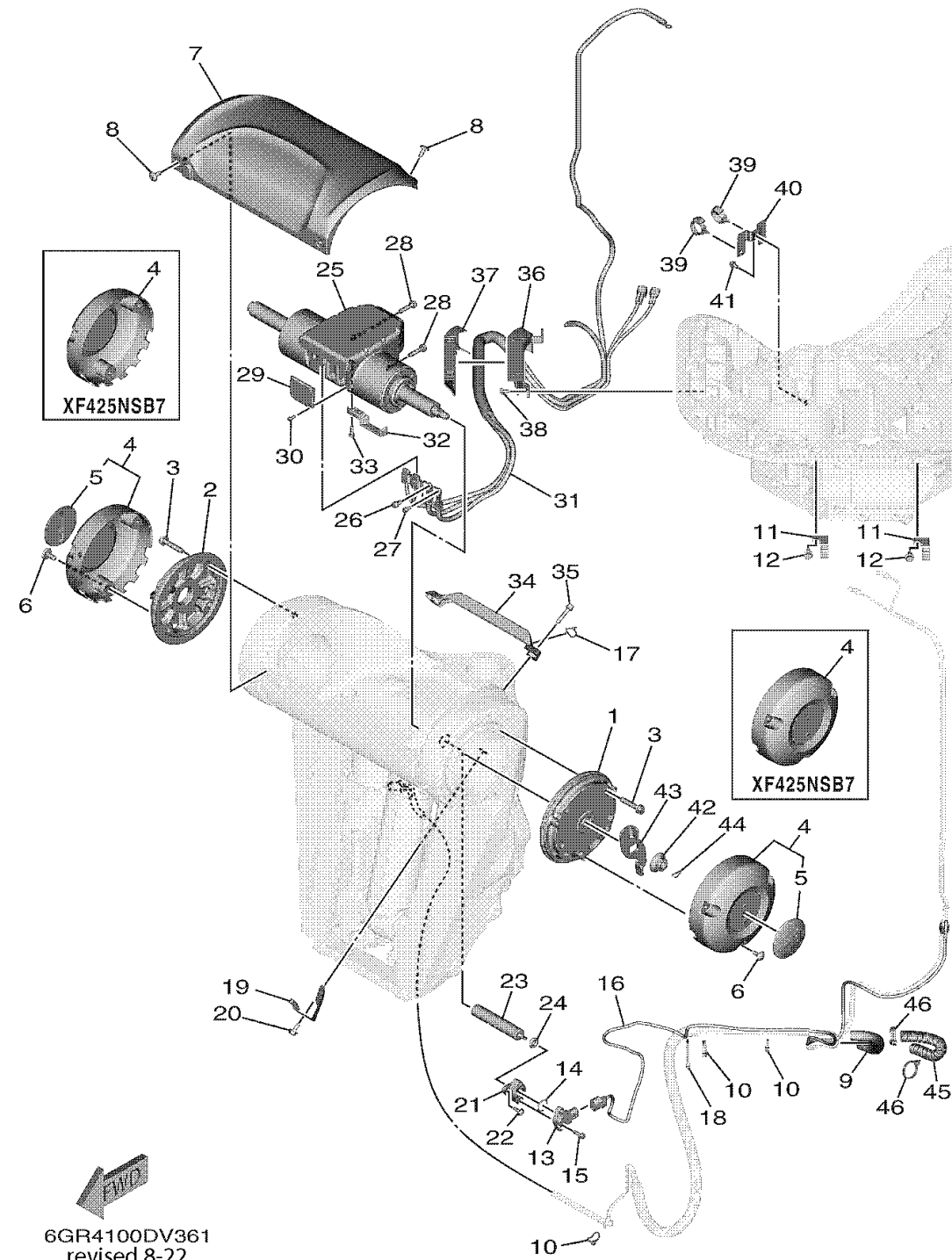

BRACKET 2

Ref No.	Part Number	Description	Qty	Remarks
17	90465-11M10-00	CLAMP	1	
18	90464-55002-00	CLAMP	1	
19	6GR-4381J-00-00	PLATE	1	
20	95D95-06012-00	BOLT, FLANGE DEEP RECESS	1	
21	6GR-4382A-00-00	ADAPTOR 1	1	
22	90149-05044-00	SCREW	2	
23	6GR-43126-00-00	PIN, UPPER SHOCK MOUNT	1	
24	93210-06ME6-00	O-RING	1	
25	6GR-42401-13-00	POWER STEERING CYLINDER ASSY	1	
26	6GR-44331-00-00	BOLT, 1	1	
27	6GR-44332-00-00	BOLT, 2	1	
28	97580-08535-00	BOLT, WITH WASHER	4	
29	6GR-42134-00-00	COVER	1	
30	91380-04010-00	BOLT	4	
31	6GR-438A0-02-00	STEERING, WIRE HARNESS ASSY	1	
32	6GR-48538-00-00	CLAMP, CABLE 1	1	
33	97D95-06018-00	BOLT, HEXAGON DEEP RECESS	2	
34	6GR-47716-00-00	COVER	1	
35	90110-06191-00	BOLT, HEXAGON SOCKET HEAD	2	
36	6GR-43121-00-00	PROTECTOR	1	

CONTINUED ON NEXT FRAME >

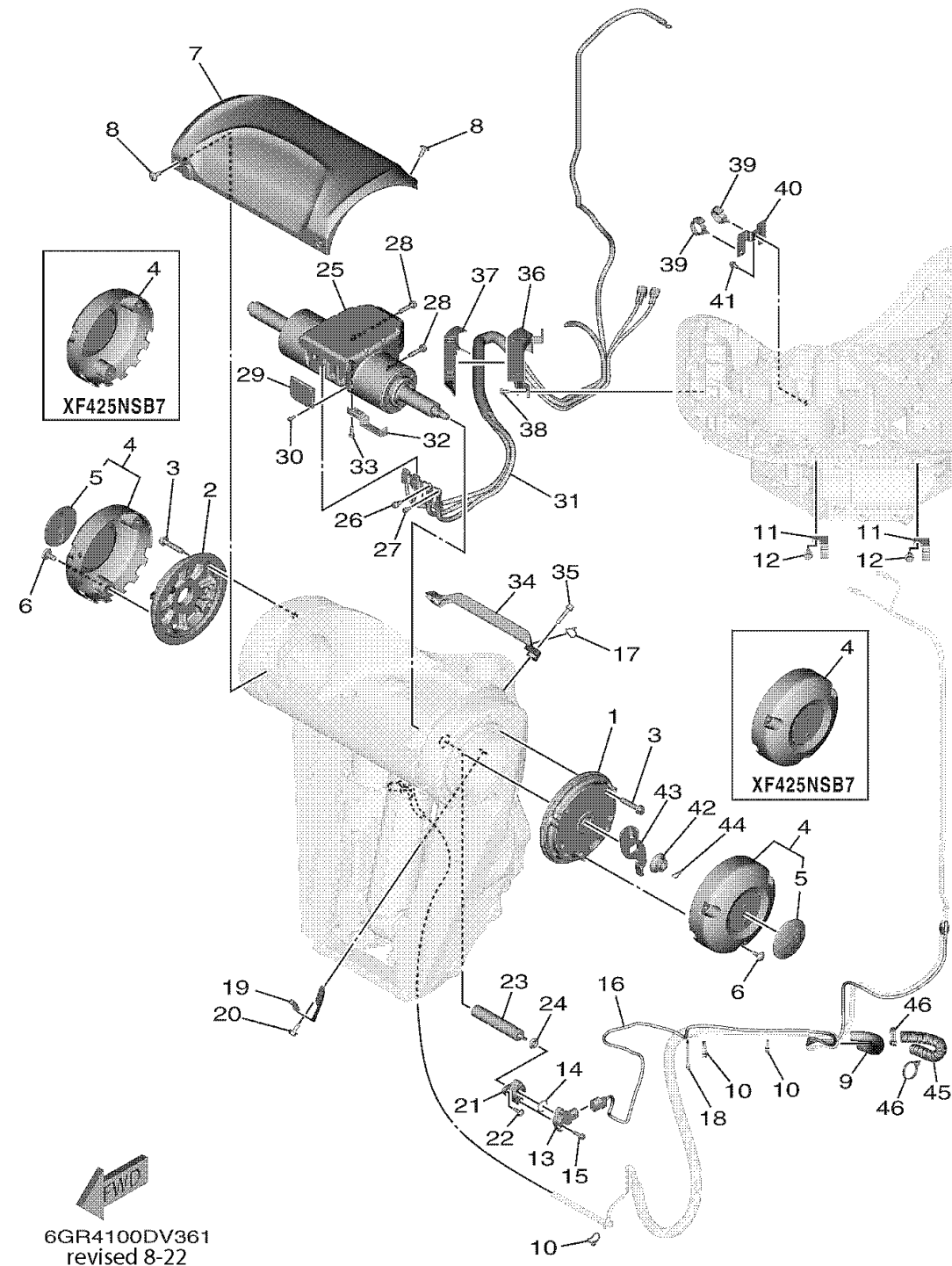

BRACKET 2

Ref No.	Part Number	Description	Qty	Remarks
37	6GR-47445-00-00	PROTECTOR	1	
38	95D95-06012-00	BOLT, FLANGE DEEP RECESS	2	
39	90464-12183-00	CLAMP	2	
40	6GR-48539-00-00	CLAMP, CABLE 2	1	
41	95D95-06012-00	BOLT, FLANGE DEEP RECESS	1	
42	90179-14009-00	NUT	1	
43	6GR-43378-10-00	WASHER	1	
44	91490-20025-00	PIN. COTTER	1	
45	6KN-24864-00-00	TUBE	1	*ADDED PART
46	90464-36005-00	CLAMP	2	*ADDED PART