

BOTTOM COWLING 1

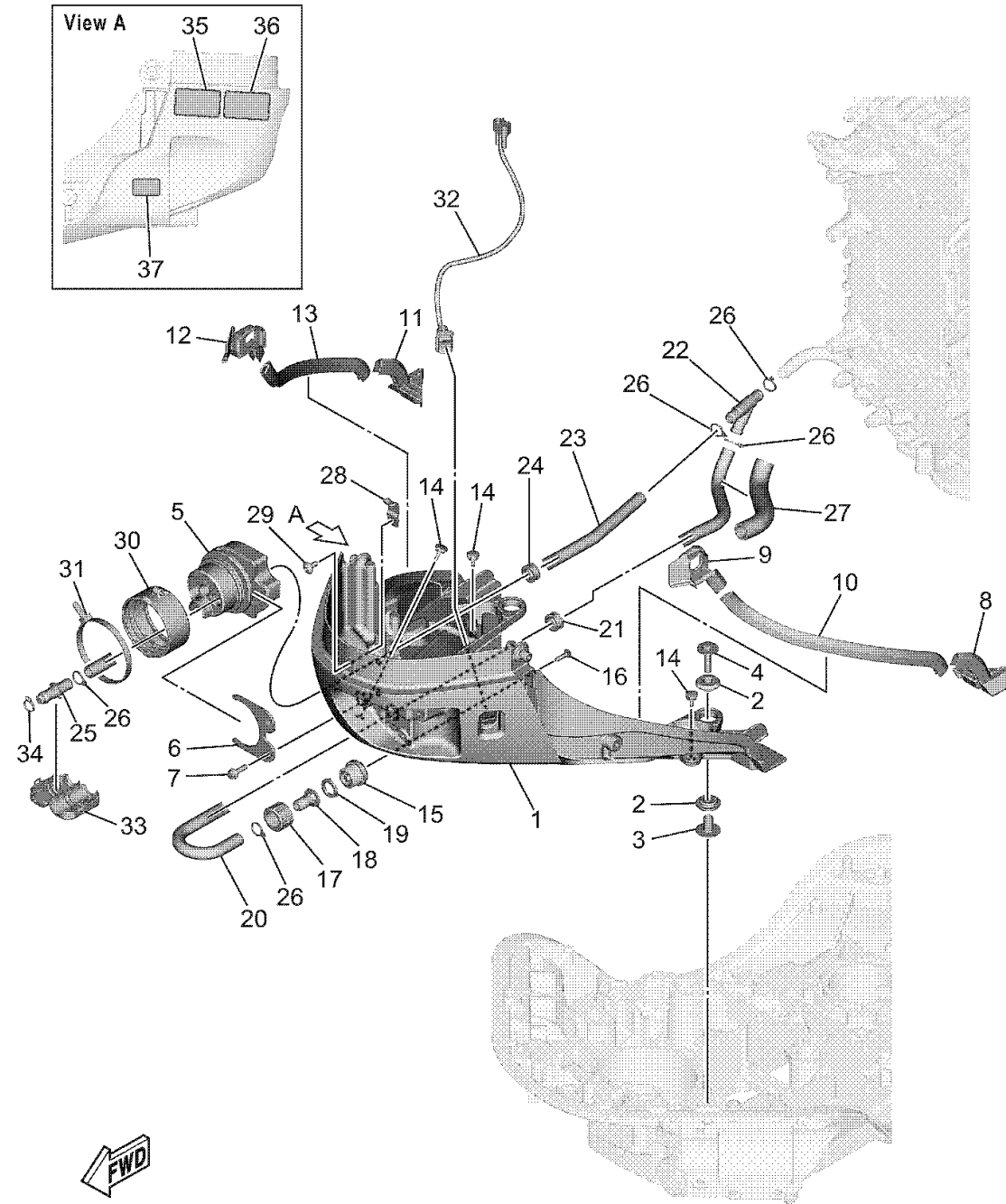

6GR6100DX280

Ref No.	Part Number	Description	Qty	Remarks
1	6GR-42711-01-8D	COWLING, BOTTOM 1	1	GRAY
1	6GR-42711-01-CE	COWLING, BOTTOM 1	0	WHITE
2	90480-22M81-00	GROMMET	4	
3	90387-08M37-00	COLLAR	2	
4	90119-08187-00	BOLT, WITH WASHER	2	
5	6GR-42725-02-00	GROMMET	1	
6	6GR-42761-00-00	STOPPER	1	
7	95D95-06020-00	BOLT, FLANGE DEEP RECESS	2	
8	6KN-42717-00-00	RUBBER, SEAL 2	1	
9	6KN-42726-00-00	GROMMET	1	
10	6KN-42617-00-00	DAMPER, FORM	1	
11	6KN-42718-00-00	RUBBER, SEAL 3	1	
12	6KN-42727-00-00	GROMMET	1	
13	6KN-42617-00-00	DAMPER, FORM	1	
14	6H4-42748-01-00	GROMMET	3	
15	6R3-12572-00-00	ADAPTER	1	
16	90169-05M00-00	SCREW, TRUSS HEAD TAPPING	1	
17	6R3-12581-00-00	JOINT, HOSE 1	1	
18	6GR-12582-00-00	JOINT, HOSE 2	1	
19	6R3-12583-00-00	GASKET, HOSE JOINT	1	

CONTINUED ON NEXT FRAME >

BOTTOM COWLING 1

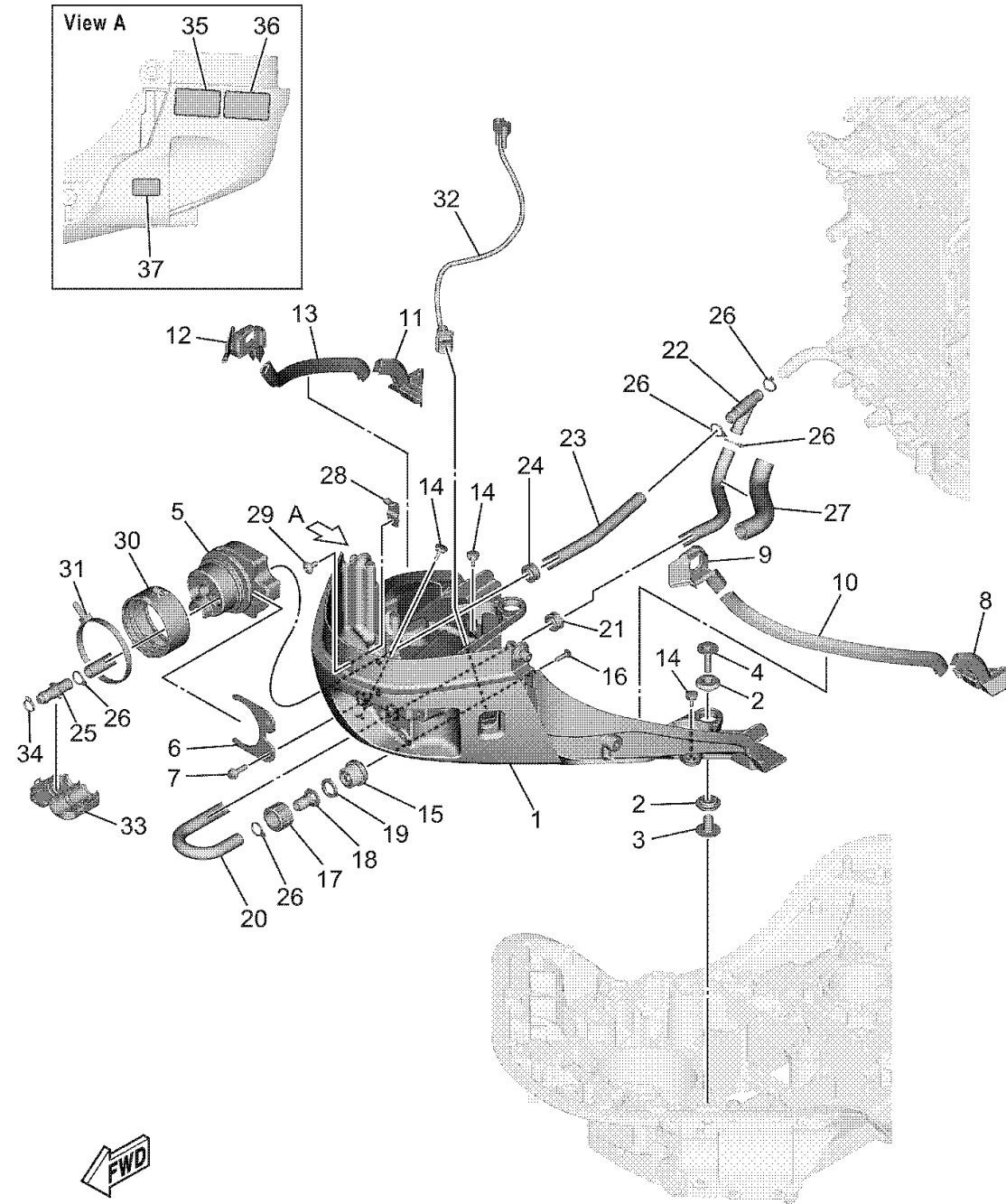

6GR6100DX280

Ref No.	Part Number	Description	Qty	Remarks
20	6GR-12577-00-00	HOSE 2	1	
21	90480-20M05-00	GROMMET	1	
22	6GR-24378-00-00	PIPE, JOINT 3	1	
23	90445-16025-00	HOSE (L290)	1	
24	90480-20M05-00	GROMMET	1	
25	6GR-83558-00-00	END, NIPPLE	1	
26	90465-11M10-00	CLAMP	5	
27	90445-23003-00	HOSE (L150)	1	
28	6GR-44554-00-00	PLATE	1	
29	90111-06144-00	BOLT, HEXAGON SOCKET BUTTON	1	
30	6GR-42753-00-00	FASTNER	1	AP
31	90464-99006-00	CLAMP	1	AP
32	6GR-82563-00-00	TRIM & TILT SWITCH ASSY	1	
33	6GR-24452-00-00	COVER	1	AP
34	90460-15227-00	CLAMP, HOSE	1	AP
35	6EE-42794-40-00	LABEL, WARNING (GENERAL)	1	
36	6EE-42794-50-00	LABEL, WARNING (GENERAL)	1	
37	6AH-81996-00-00	MARK	1	