

BOTTOM COWLING 2

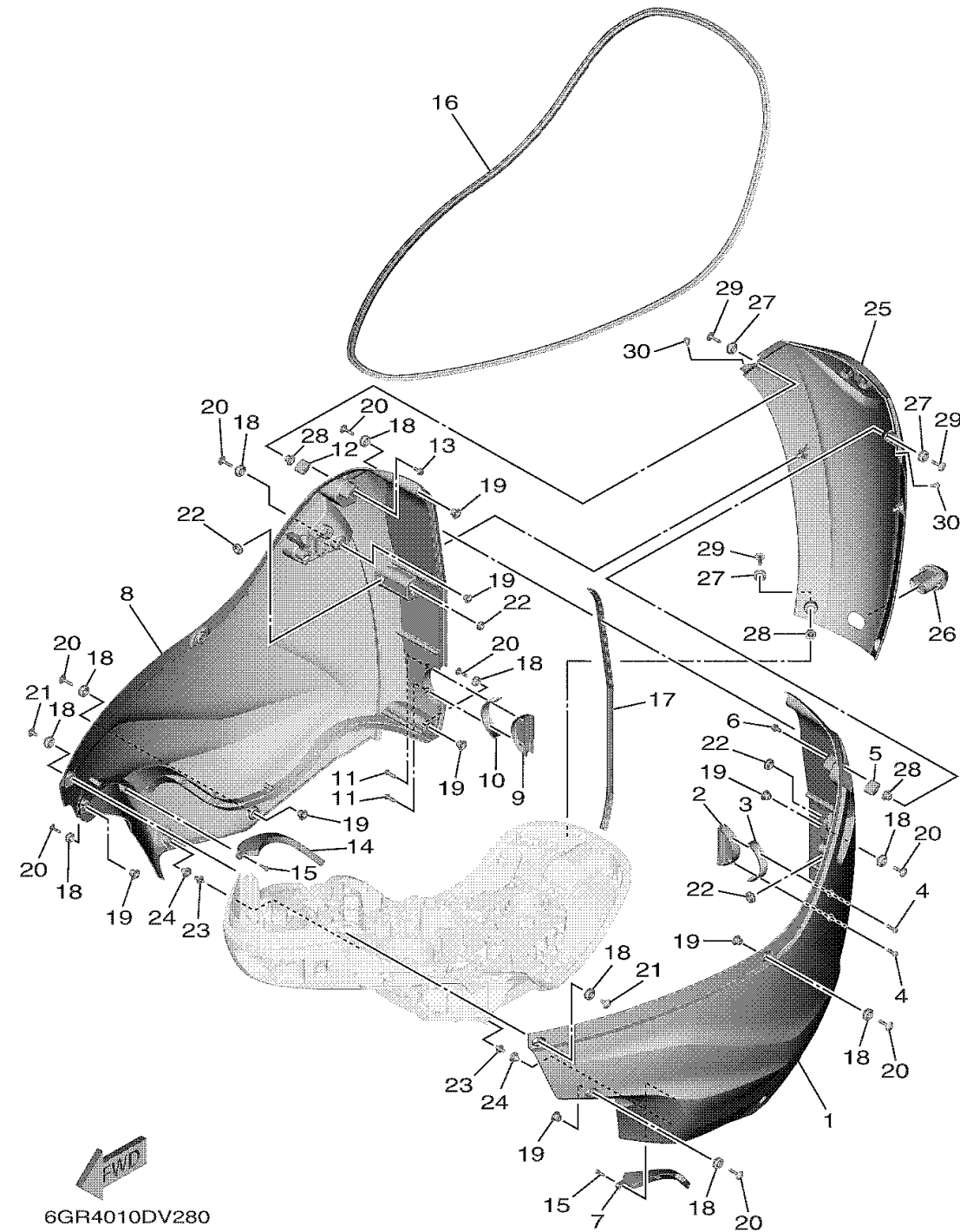

Ref No.	Part Number	Description	Qty	Remarks
1	6GR-42712-01-8D	COWLING, BOTTOM 2	1	GRAY
1	6GR-42712-01-CE	COWLING, BOTTOM 2	0	WHITE
2	6GR-42532-00-00	COVER	1	
3	6GR-42721-00-00	GASKET 1	1	
4	97780-50620-00	SCREW, TAPPING	2	
5	6GR-42744-00-00	STAY	1	
6	95D95-06012-00	BOLT, FLANGE DEEP RECESS	2	
7	6GR-42622-01-00	SIDE, MOLE COWLING 1	1	
8	6GR-42713-01-CE	COWLING, BOTTOM 3	0	WHITE
8	6GR-42713-01-8D	COWLING, BOTTOM 3	1	GRAY
9	6GR-42533-00-00	COVER	1	
10	6GR-42722-00-00	GASKET 2	1	
11	97780-50620-00	SCREW, TAPPING	2	
12	6GR-42744-00-00	STAY	1	
13	95D95-06012-00	BOLT, FLANGE DEEP RECESS	2	
14	6GR-42623-01-00	SIDE, MOLE COWLING 2	1	
15	90167-05017-00	SCREW, TAPPING	4	
16	6GR-42615-00-00	SEAL	1	
17	6GR-42769-00-00	SEAL, RUBBER	1	
18	90480-16015-00	GROMMET	14	

CONTINUED ON NEXT FRAME >

BOTTOM COWLING 2

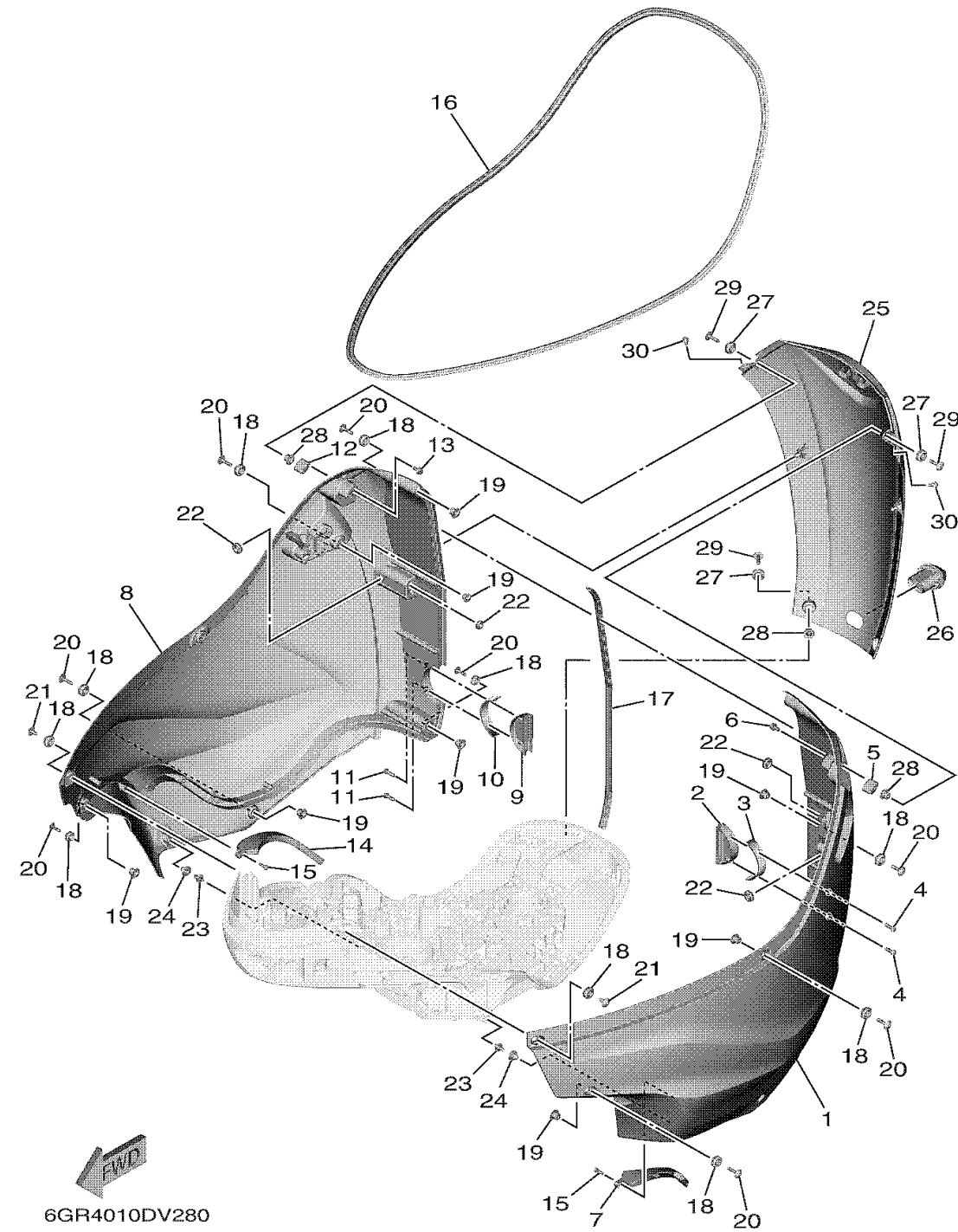

Ref No.	Part Number	Description	Qty	Remarks
19	6GR-42758-00-00	COLLAR	12	
20	90111-06175-00	BOLT, HEXAGON SOCKET BUTTON	12	
21	90111-06176-00	BOLT, HEXAGON SOCKET BUTTON	2	
22	90480-13034-00	GROMMET	4	
23	69J-42774-10-00	STAY, APRON 1	2	
24	6GR-42768-01-00	DAMPER	2	
25	6GR-42625-00-CE	PANEL, REAR	0	WHITE
25	6GR-42625-00-8D	PANEL, REAR	1	GRAY
26	6GR-42748-01-00	GROMMET	1	
27	90480-16015-00	GROMMET	4	
28	6GR-42758-00-00	COLLAR	4	
29	90111-06175-00	BOLT, HEXAGON SOCKET BUTTON	4	
30	90338-07012-00	PLUG	2	