

# FUEL 3

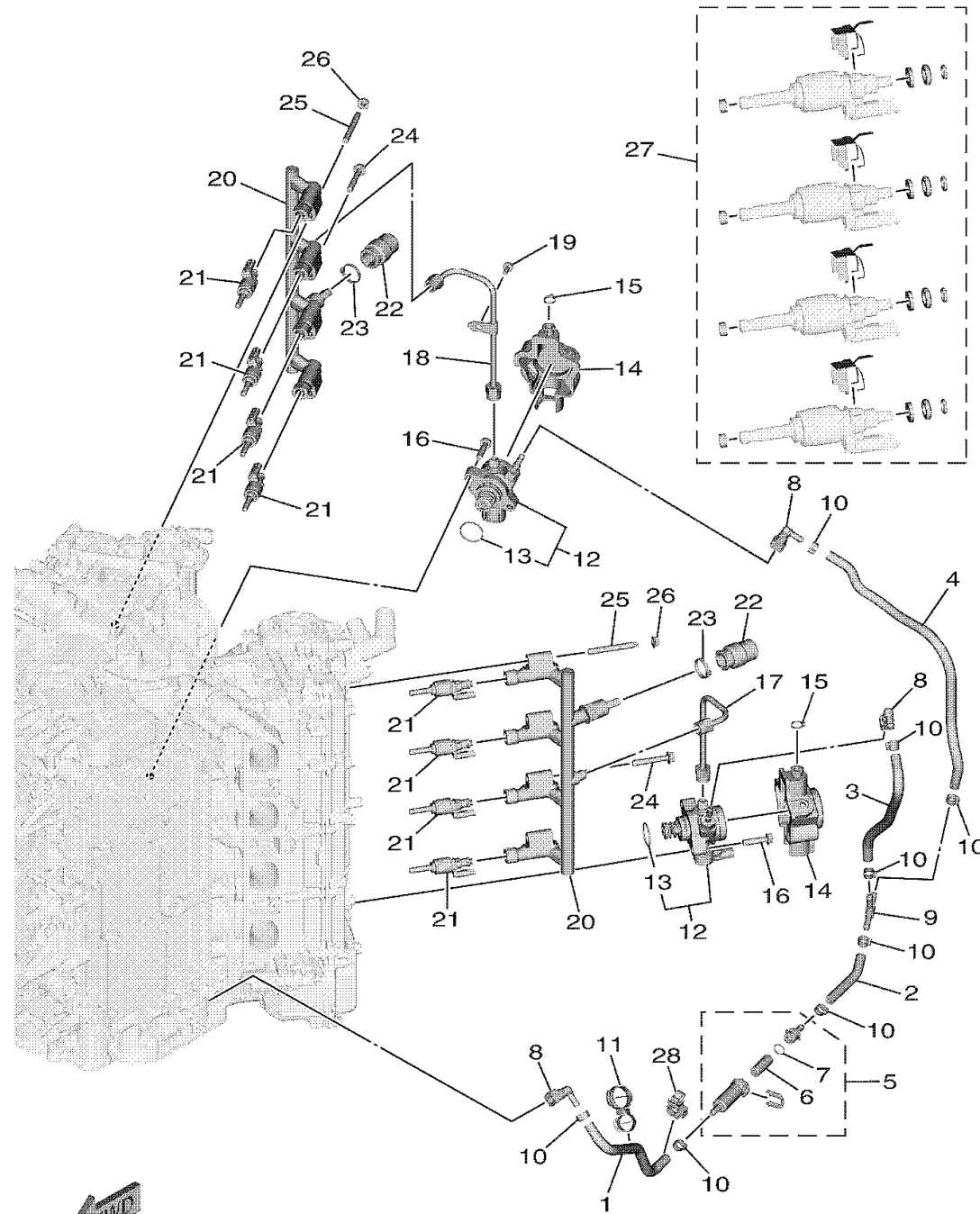

6GR1100DS190

Ref No.	Part Number	Description	Qty	Remarks
1	6GR-243A1-00-00	PIPE 15	1	
2	6GR-243A2-00-00	PIPE 16	1	
3	6GR-243A3-00-00	PIPE 17	1	
4	6GR-243A4-00-00	PIPE 18	1	
5	6GR-24251-00-00	STRAINER 1	1	
6	6GR-24501-00-00	..FILTER, FUEL	1	
7	6GR-13016-00-00	..O-RING	1	
8	6AW-24300-01-00	FUEL PIPE JOINT	3	
9	6CB-24461-00-00	PIPE, JOINT	1	
10	90467-141A1-00	CLIP	8	
11	90464-29223-00	CLAMP	1	
12	6GR-13910-00-00	FUEL PUMP ASSY	2	
13	6GR-12439-00-00	..O-RING	1	
14	6GR-24595-01-00	PROTECTOR	2	
15	90465-11M10-00	CLAMP	2	
16	97E95-08535-00	BOLT, HEXAGON W/W DEEP RECESS	4	
17	6GR-14295-00-00	PIPE, FUEL	1	
18	6GR-14296-00-00	PIPE, FUEL 2	1	
19	95D95-06014-00	BOLT, FLANGE DEEP RECESS	1	
20	6GR-13160-09-00	DELIVERY PIPE ASSY 1	2	

CONTINUED ON NEXT FRAME >

# FUEL 3

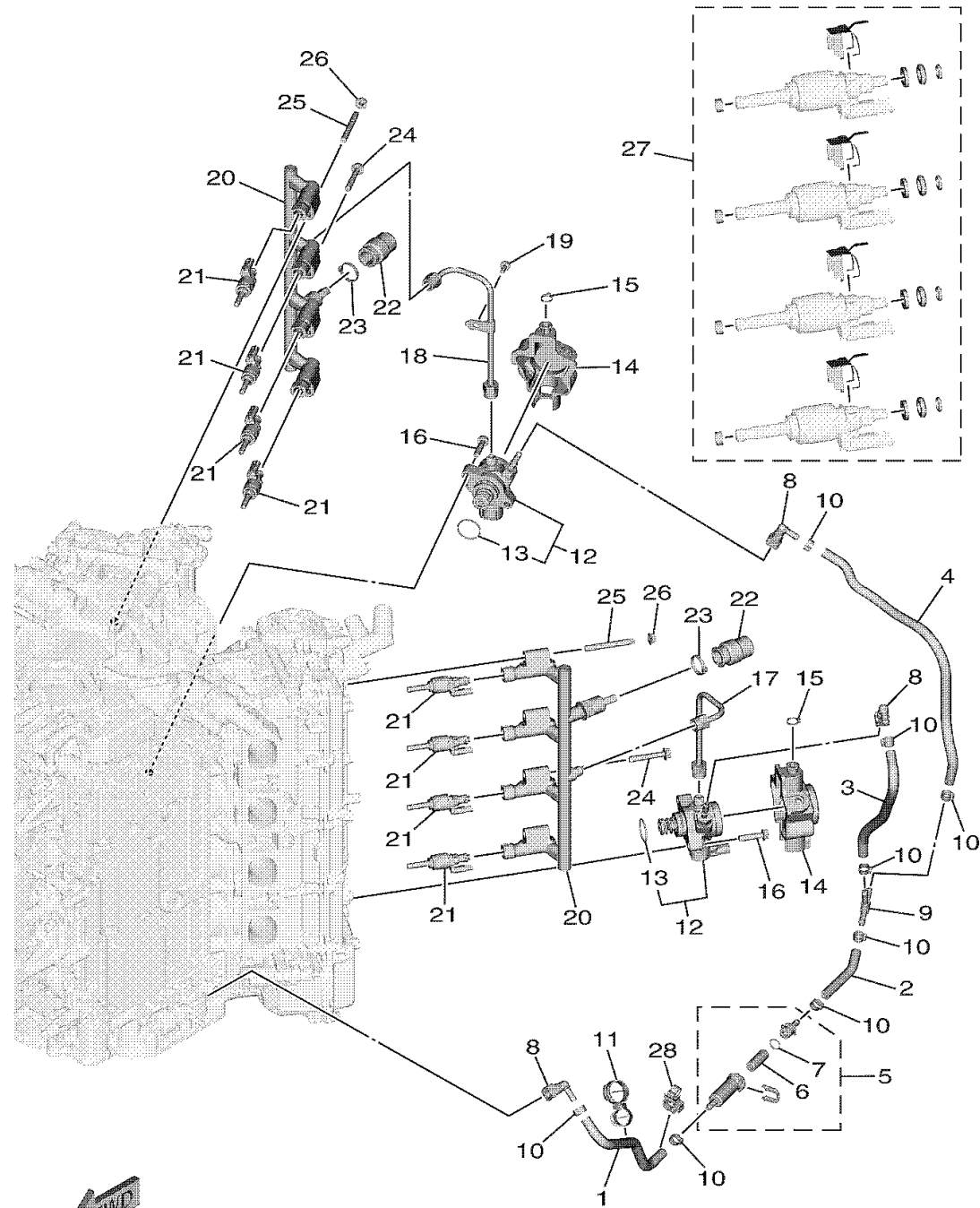

6GR1100DS190

Ref No.	Part Number	Description	Qty	Remarks
21	6GR-13761-00-00	INJECTOR	8	
22	6GR-24599-01-00	CAP	2	
23	90465-13M97-00	CLAMP	2	
24	90105-08175-00	BOLT, FLANGE	4	
25	90116-08037-00	BOLT, STUD	4	
26	90179-08M34-00	NUT	4	
27	6GR-W0005-00-00	O-RING SET	2	
28	90464-16015-00	CLAMP	1	