

ANALOG TRIM METER

Description	Part No.	Applicable model
4-pin coupler BLK panel	6Y7-W8367-02	Pre-mixed w/ PTT
Bullet connector BLK panel	6Y7-83670-41	Above 40 (3-cyl) w/ oil injection & PTT, Above F30 w/ PTT [Mechanical RC], T25 (NOA) Use as a set with tachometer, 6Y7-83540-82
4-pin coupler WHT panel	6Y7-W8367-22	Pre-mixed w/ PTT
Bullet connector WHT panel	6Y7-83670-51	Above 40 (3-cyl) w/ oil injection & PTT, Above F30 w/ PTT [Mechanical RC], T25 (NOA) Using as a set with tachometer, 6Y7-83540-92

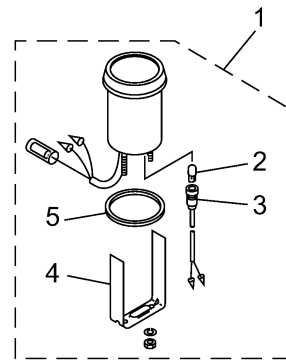

COOLANT PRESSURE METER

Description	Part No.	Applicable model
kPa, Black panel	6Y7-W8366-01	Above 40 [3-cyl] Above F25 (FT/T25) [Mechanical RC]
psi, Black panel	6Y7-W8366-11	
psi, White panel	6Y7-W8366-31	

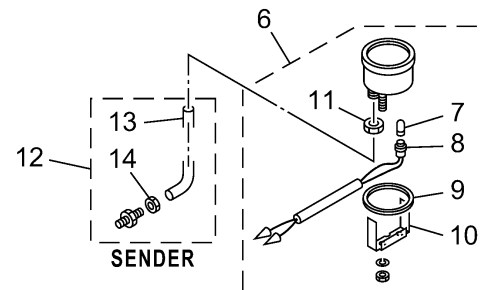

601M10M-Y060

METER 6

Ref No.	Part Number	Description	Qty	Remarks
1	6Y7-83670-41-00	TRIM METER ASSY.	1	UR
1	6Y7-83670-51-00	TRIM METER ASSY.	1	UR
1	6Y7-W8367-02-00	TRIM METER ASSY.	1	UR
1	6Y7-W8367-22-00	TRIM METER ASSY.	1	UR
2	6Y5-83518-00-00	..BULB (12V-1.7W T6.5)	1	
3	6Y5-83536-00-00	..SOCKET, METER	1	
4	6Y5-83544-00-00	..PLATE, FITTING	1	
5	688-83664-00-00	..DAMPER	1	
6	6Y7-W8366-01-00	WATER PRESSURE METER ASSY	1	UR
6	6Y7-W8366-11-00	WATER PRESSURE METER ASSY	1	UR
6	6Y7-W8366-31-00	WATER PRESSURE METER ASSY	1	UR
7	6Y5-83518-00-00	..BULB (12V-1.7W T6.5)	1	
8	6Y5-83536-00-00	..SOCKET, METER	1	
9	688-83664-00-00	..DAMPER	1	
10	688-83665-00-00	..PLATE, FITTING	1	
11	663-83668-00-00	..NUT, NIPPLE	1	
12	688-83667-01-00	SENDER	1	
13	688-83666-00-00	..TUBE	1	
14	663-83668-10-00	..NUT, NIPPLE	1	