

WIRE HARNESS 2

LAMP SWITCH

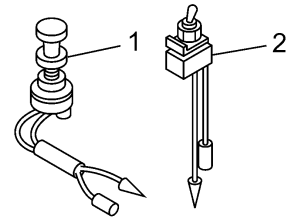

TRIM METER LEAD

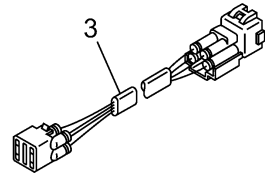

Premixed models W/PTT
(Flat type harness)

TRIM AND OIL LEAD

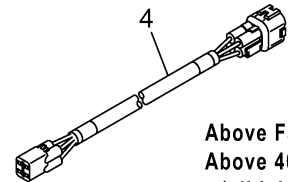

Above F30(Mechanical RC)
Above 40(3-cyl)
w/oil injection
(Unified 4-pin coupler)

FUEL MANAGEMENT GAUGE HARNESS

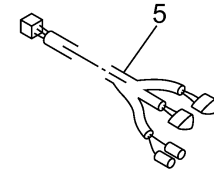

LIGHTING COIL EXTENSION HARNESS

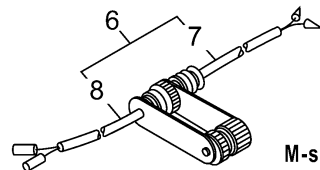

M-start model
with lighting coil

CONVERSION HARNESS 1

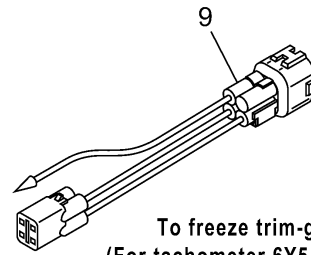

To freeze trim-gauge
(For tachometer 6Y5-8350T-E3)
for hydro-tilt model

RECTIFIER KIT

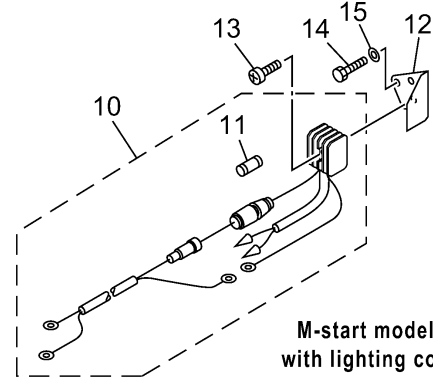

M-start model
with lighting coil

601M10M-Z100

Ref No.	Part Number	Description	Qty	Remarks
1	688-82520-00-00	LIGHT SWITCH ASSY	1	
2	688-82526-00-00	SWITCH, LAMP	1	
3	6R3-82553-30-00	EXTENSION, WIRE LEAD (L=3.0M)	1	UR (4P)
3	6R3-82553-80-00	EXTENSION, WIRE LEAD (L=8.0M)	1	UR (4P)
3	6R3-82553-50-00	EXTENSION, WIRE LEAD (L=5.0M)	1	UR (4P)
3	6R3-82553-70-00	EXTENSION, WIRE LEAD (L=7.0M)	1	UR (4P)
3	6R3-82553-90-00	EXTENSION, WIRE LEAD (L=9.0M)	1	UR (4P)
4	6Y5-83653-00-00	WIRE, LEAD (L=5.0M)	1	UR 4P, 5M
4	6Y5-83653-10-00	WIRE, LEAD (L=6.0M)	1	UR 4P, 6M
4	6Y5-83653-20-00	WIRE, LEAD (L=7.0M)	1	UR 4P, 7M
4	6Y5-83653-30-00	WIRE, LEAD (L=8.0M)	1	UR 4P, 8M
4	6Y5-83653-40-00	WIRE, LEAD (L=9.0M)	1	UR 4P, 9M
4	6Y5-83653-50-00	WIRE, LEAD (L=10.5M)	1	UR 4P, 10.5M
5	6Y5-83553-F2-00	WIRE, LEAD (L=8.0M)	1	
6	682-84380-00-00	CONCENT 2P	1	
7	682-84381-00-00	. .2P CONCENT	1	
8	682-84382-00-00	. .2P CONCENT	1	
9	6Y5-8350U-10-00	WIRE, LEAD	1	
10	676-81970-02-00	RECTIFIER ASSY	1	
11	663-82151-01-00	. .FUSE (12V-20A)	1	

CONTINUED ON NEXT FRAME >

WIRE HARNESS 2

Ref No.	Part Number	Description	Qty	Remarks
12		TIRE (180/55 ZR 17 M/C 73W)	1	LM
13	97880-05025-00	SCREW, PAN HEAD	1	
14	97013-06010-00	BOLT	2	
15	92903-06600-00	WASHER, PLATE	2	

LAMP SWITCH

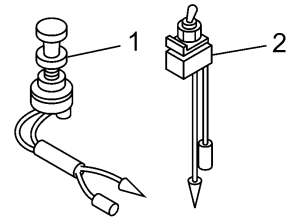

TRIM METER LEAD

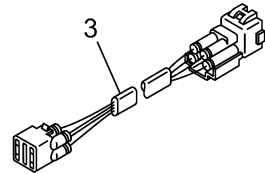

Premixed models W/PTT
(Flat type harness)

TRIM AND OIL LEAD

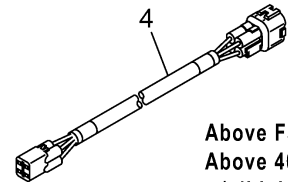

Above F30(Mechanical RC)
Above 40(3-cyl)
w/oil injection
(Unified 4-pin coupler)

FUEL MANAGEMENT GAUGE HARNESS

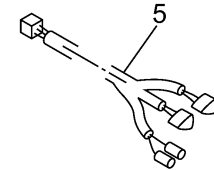

LIGHTING COIL EXTENSION HARNESS

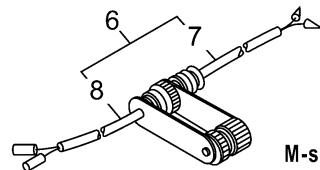

M-start model
with lighting coil

CONVERSION HARNESS 1

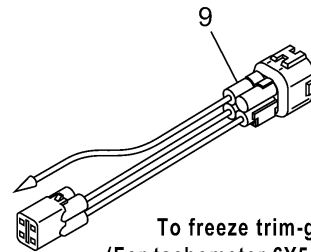

To freeze trim-gauge
(For tachometer 6Y5-8350T-E3)
for hydro-tilt model

RECTIFIER KIT

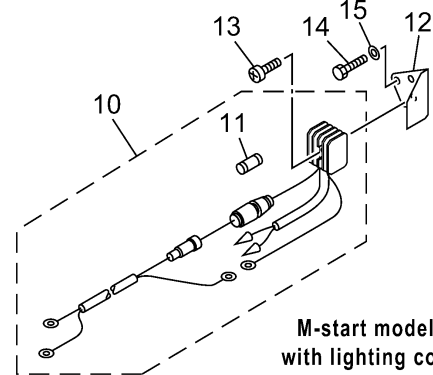

M-start model
with lighting coil

601M10M-Z100