

### STEERING HOOK

Part No.	Applicable model	Remarks
676-48511-10	E8D, EK8D	Ball post type

Part No.	Applicable model	Remarks
689-48511-02	25B, 30H E25B, E30H	Ball post type/ Steering guide type

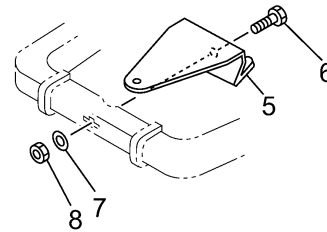
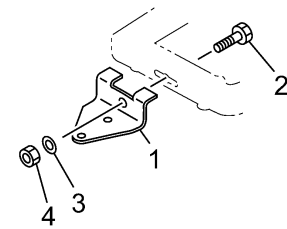

Part No.	Applicable model	Remarks
700-48510-12	E8D, EK8D 25B, 30H E25B, E30H	Rope type

Part No.	Applicable model	Remarks
69G-48511-10	FT9.9L (T9.9B)	For Linkage to main-engine

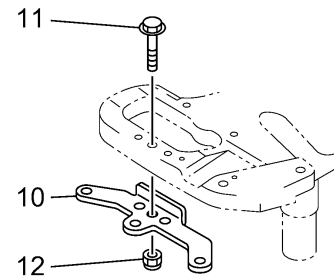
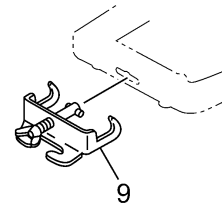

601R10R-Y560

## STEERING HOOK 3

Ref No.	Part Number	Description	Qty	Remarks
1	676-48511-10-00	HOOK, STEERING	1	BALL POST TYPE
2	97D75-10040-00	BOLT, HEXAGON DEEP RECESS	1	
3	92990-10600-00	WASHER, PLATE	1	
4	90185-10027-00	NUT, SELF-LOCKING	1	
5	689-48511-02-00	HOOK, STEERING	1	
6	97D75-10040-00	BOLT, HEXAGON DEEP RECESS	1	
7	92990-10600-00	WASHER, PLATE	1	
8	90185-10027-00	NUT, SELF-LOCKING	1	
9	700-48510-12-00	STEERING HOOK ASSY	1	ROPE TYPE
10	69G-48511-10-00	HOOK, STEERING	1	
11	97E95-08535-00	BOLT, HEXAGON W/W DEEP RECESS	1	
12	90185-08057-00	.NUT, SELF-LOCKING	1	