

# BOTTOM COWLING 2

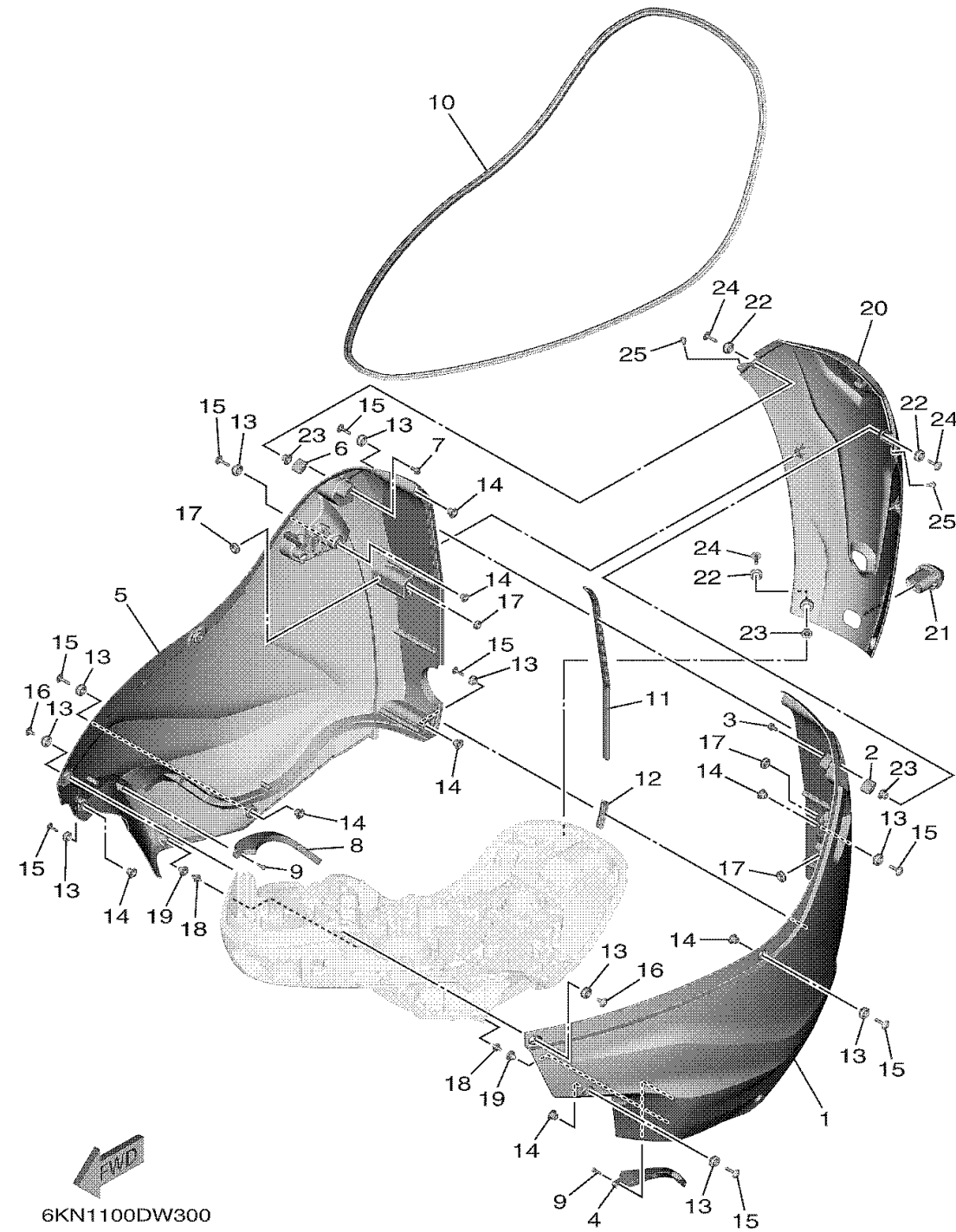

Ref No.	Part Number	Description	Qty	Remarks
1	6KN-42712-00-8D	COWLING, BOTTOM 2	1	GRAY
1	6KN-42712-00-CE	COWLING, BOTTOM 2	0	WHITE
1	6KN-42712-00-CJ	COWLING, BOTTOM 2	0	WARM WHITE
2	6GR-42744-00-00	STAY	1	
3	95D95-06012-00	BOLT, FLANGE DEEP RECESS	2	
4	6GR-42622-01-00	SIDE, MOLE COWLING 1	1	
5	6KN-42713-00-CJ	COWLING, BOTTOM 3	0	WARM WHITE
5	6KN-42713-00-8D	COWLING, BOTTOM 3	1	GRAY
5	6KN-42713-00-CE	COWLING, BOTTOM 3	0	WHITE
6	6GR-42744-00-00	STAY	1	
7	95D95-06012-00	BOLT, FLANGE DEEP RECESS	2	
8	6GR-42623-01-00	SIDE, MOLE COWLING 2	1	
9	90167-05017-00	SCREW, TAPPING	4	
10	6GR-42615-00-00	SEAL	1	
11	6KN-42769-00-00	SEAL, RUBBER	1	
12	6KN-44522-00-00	SEAL	1	
13	90480-16015-00	GROMMET	14	
14	6GR-42758-00-00	COLLAR	12	
15	90111-06175-00	BOLT, HEXAGON SOCKET BUTTON	12	
16	90111-06176-00	BOLT, HEXAGON SOCKET BUTTON	2	

CONTINUED ON NEXT FRAME >

## BOTTOM COWLING 2



Ref No.	Part Number	Description	Qty	Remarks
17	90480-13034-00	GROMMET	4	
18	69J-42774-10-00	STAY, APRON 1	2	
19	6GR-42768-01-00	DAMPER	2	
20	6KN-42625-00-8D	PANEL, REAR	1	GRAY
20	6KN-42625-00-CE	PANEL, REAR	0	WHITE
20	6KN-42625-00-CJ	PANEL, REAR	0	WARM WHITE
21	6GR-42748-01-00	GROMMET	1	
22	90480-16015-00	GROMMET	4	
23	6GR-42758-00-00	COLLAR	4	
24	90111-06175-00	BOLT, HEXAGON SOCKET BUTTON	4	
25	90338-07012-00	PLUG	2	